

J Duckworth No 56
 \$ 89 1/2

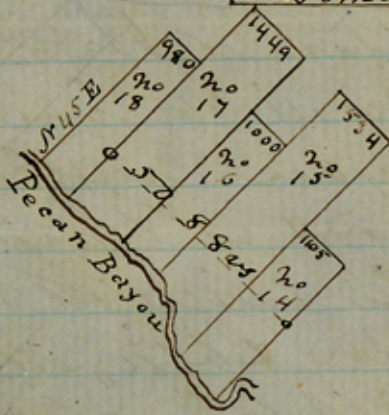

Sketch No 1-

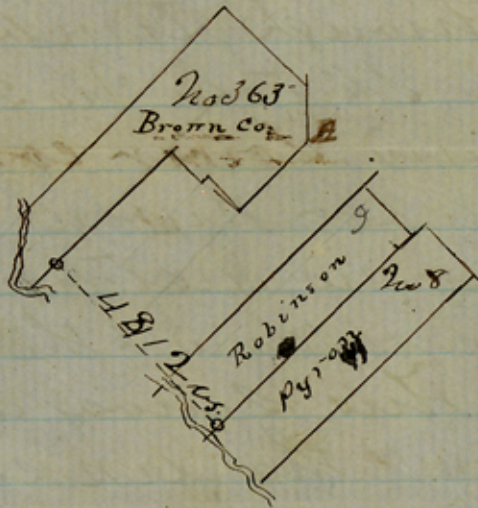

Sketch No 2

I S Duckworth county Surveyor for Brown county do hereby certify that Sketch No 1 represents the true position of surveys Nos 56 made for Jacob Duckworth & surveys Nos 14-15-16-17 & 18- and that from the North corner of No 17 made for Sullivan to the North line of said No 56 is North 11 us- and thence N 89 1/2 W 455 us to the S W corner of said No 56-

From the East line of No 18 made for Hunt ~~\$ 5088 us~~ \$ 4565088 us to the East line of No 14 made for Rossau that I found the back cor of the Hunt No 18 the corners on Pecan Bayou of the Rossau No 14 Highsmith No 15 & the corner corner of the Bennett No 16- No 14 meas red across 1105 us & No 15-1534 us I found no other corners of the above

Mentioned Survey - after diligent search
The East line of No 14 running
back from the Bayou N 45° E 3802
is through timber & is blazed all
the way. The north line of No 18
is also through timber & blazed.

In Sketch No 2 I found the
upper and lower corner of survey No
8 made for Brown for the bearing true
^{more} very near in distance as given in the
field notes of same & the courses - more the
same. This survey is 1614 ns across
and from the upper line of said
No 8. N 45° W 4812 ns to the lower
line of No 363 made for Brown co.

The corner of said No 363 marked A is
38 ns - south of the SW corner of F Bollinger
Survey No 321 -

Brownwood

2 APRIL 1863

L. H. Suckett

co. S. Brown co

Sketch of
Surreys on
Pecan Bayou
Brown Co
by L. H. Lockett
Co. S. B. Co

File 7.

L. H. Lockett Sk.

Brown County
filed April 7/60.
on Pecan Bayou
East of Brownwood.

Pecan Bayou Surreys at Brownwood
and Southeastward. 12-9-30. Blucher

filed April 7/60
C. W. Pfeiffer

Counter 16592