

Jim Reed

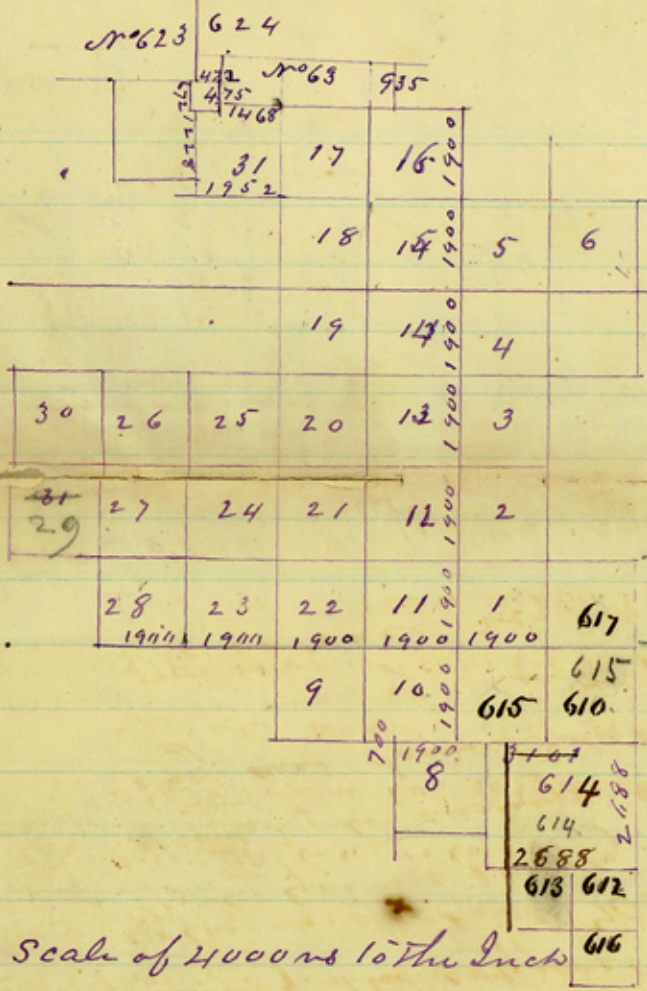

State of Texas }
 Brown county } Sketch
 or Plat showing the
 position of surveys on the
 head of Clear and Indian
 creeks to the Survey No 623
 as Jim Reed creek made
 for (at first) "Horseshoe"
 "Honeycut"

Scale of 24000 to the Inch

I L. H. Suckitt Deputy Surveyor for Brown County do hereby certify that the above sketch is true & correct and that the distances and bearings marked down from actual measurement on the ground. This 14th May 1870.

L. H. Suckitt
 D. S. Brown Co

I J. H. McMillion county Surveyor of Brown County do hereby certify that I have examined the above and foregoing sketch and approve the same as correct.
 14 May 1870
 J. H. McMillion.
 Co. S. B. Co.

1900
 6
 11400

Sketch File No. 12

Brown County

L. H. Luckett's Sk & Draftsman's Statement

Filed June 13, 1870 199

J. H. Walker, Comm.

File Clerk

Descriptive: 11 Mi. N55W Brownwood

and HT&B Sur's to Southeastward

Sketch of ^{File 12.}

Brown co-

from head of clear
and Indian creek
to Jimmie's

19.00
6
11.4
4.75

11875

see other side

Cancelled by correction

Filed in Office
June 13/70 (cc. st.)

Counter 16603