

State of Texas
 District of Millam
 I do Certify that the above Sketch
 is a correct representation of the Survey returned to
 this Office by F. A. Thomson Dep. Surveyor
 Gen at Caldwell this 17th day of October 1842.
 James Howlet
 District Surveyor

File 2
Milam District

Sketch - E. of Davidson's cr.
returned October 26th 1847.

see sketch No 22 page 8, Atlas G.

Burleson County

S. E. part of the Co.
16 Mi. S. 60° E. Caldwell

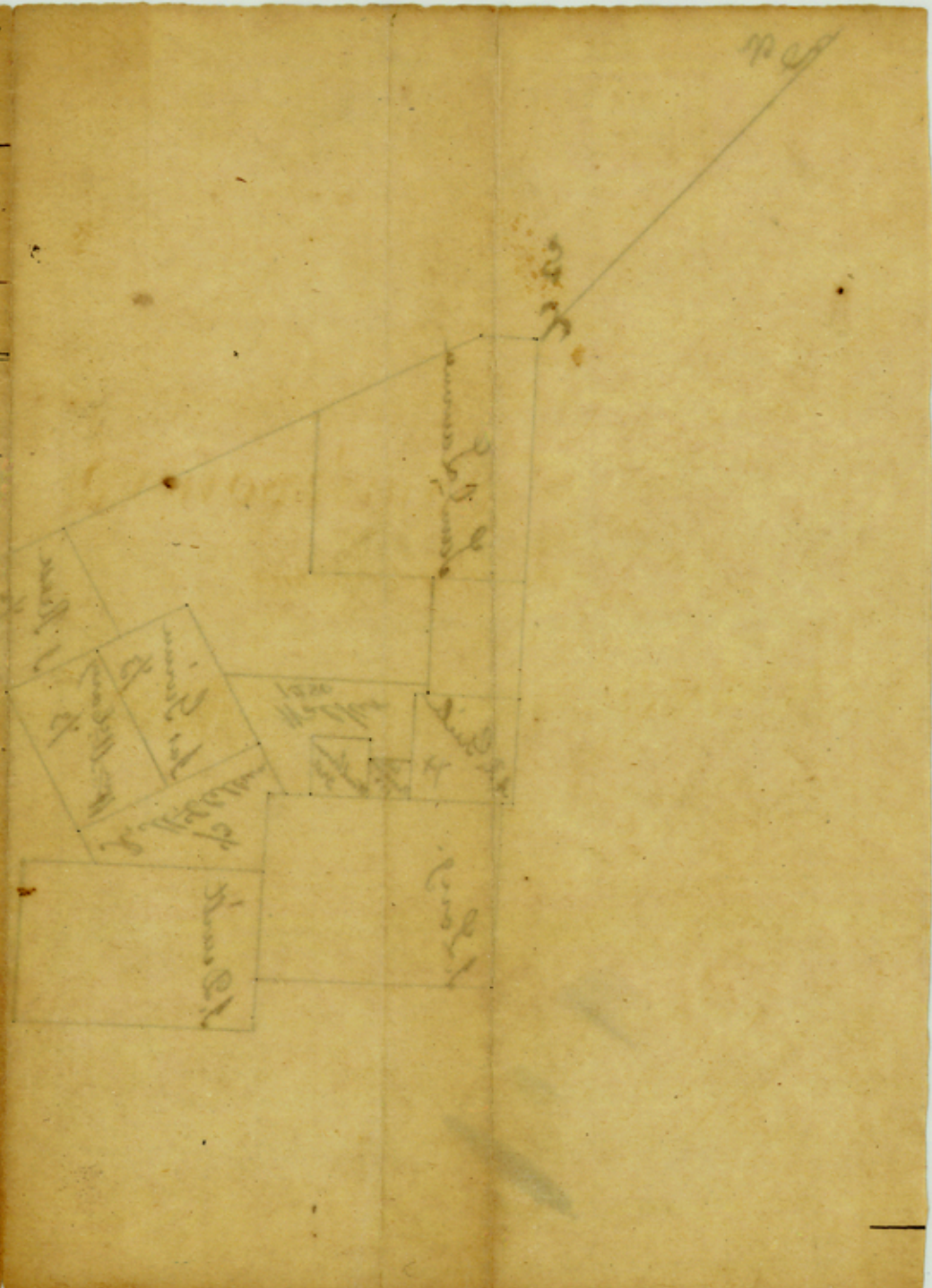

Counter 16646