

~~Bell Co.~~ <sup>Sketch No. 1</sup> Sketch 1  
Milam District  
Waters of North Gabriel  
Plotted on map. October 12, 1847.  
Sketch File No. 1.

~~Bell County~~

<sup>Sketch No. 1</sup>  
Burnet Co.  
In the E. cor. of said Co.  
N. E. of Burnet  
16 Mi. N. 60° E. Burnet.  
James Houston Sketch  
Filed October 11, 1847.

County 16470

*[Faint, illegible handwritten notes in the bottom right corner of the page.]*

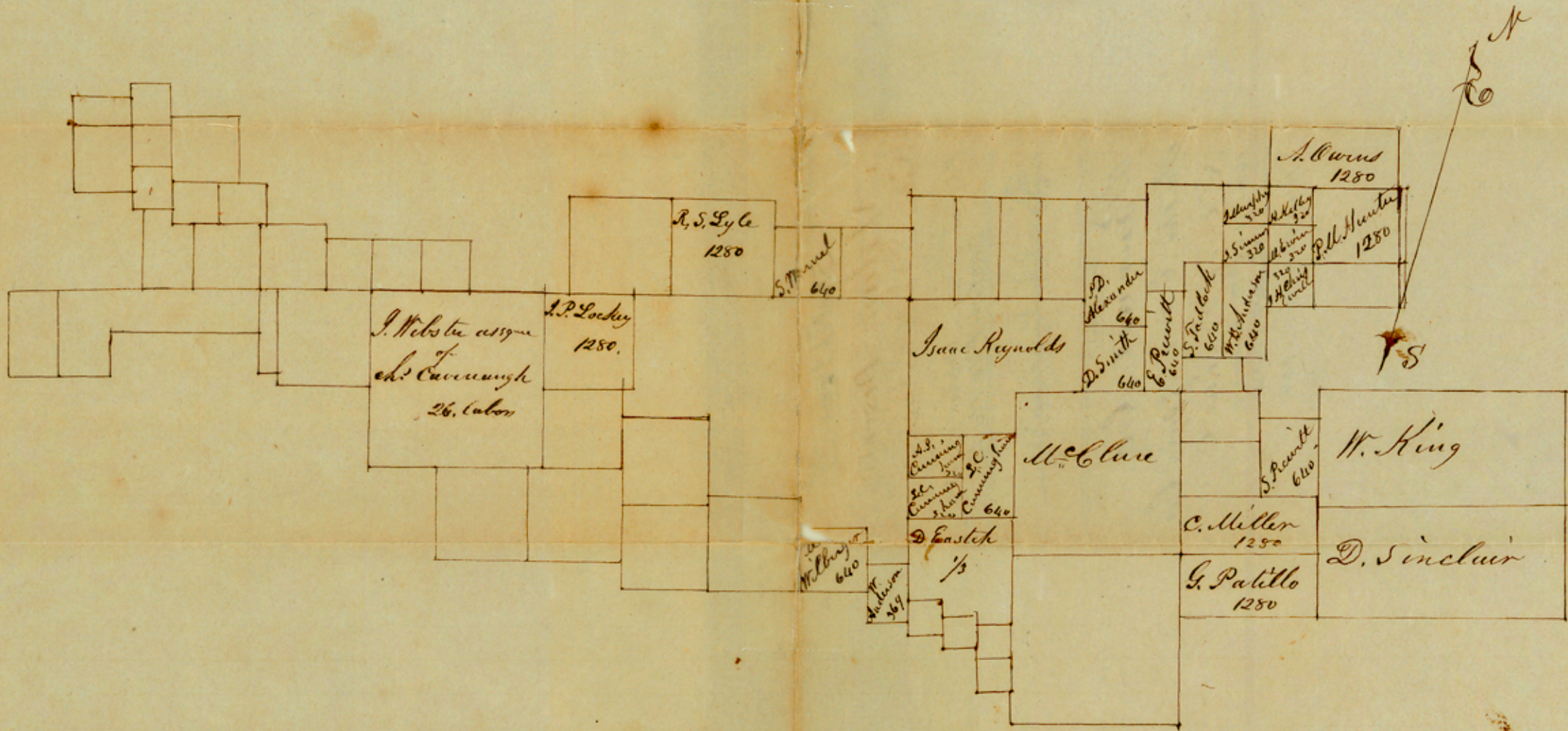

State of Texas  
 District of Millam I do Certify that the above sketch  
 is a correct representation of the Survey returned to  
 this Office by Matthias Willinger Dep Surveyor of  
 said District  
 Given at Caldwell this 27<sup>th</sup> day of August 1847.  
 James Howlet  
 District Surveyor

Received - October 11. 1847.

Plotted on map. October 12. 1847