

Survey made by Wallace
 and Paul et al.

State of Texas }
 District of Milam } I do Certify that the above
 sketch is a correct representation of the survey
 returned to this Office by Matthias Wilberger
 Deputy Surveyor of said District
 Given at Caldwell this 31st day of July 1848.
 James Hecollet
 District-Surveyor

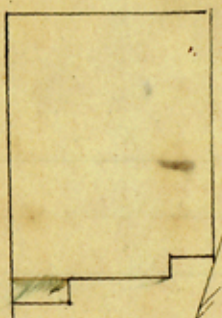

State of Texas July 17th AD 1848
 District of Milam }
 Survey for James B Allen
 on the head waters of the San
 Gabriel and Lampasas in Milam Dis
 trict Being the quantity of Land to wh
 ich he is Entitled By virtue of San
 Certificate Spued By

File 163

Milam Dis.

S. Ketch - Head of N. San -
 Gabriel.

returned Aug. 17. 1848.
 (Note on Chap. 11)

Burnet County
 N.E. E. of Burnet

See also Title 9 of Williams
 son Co.

B.M. N. 20 E. Burnet.