

Commr Gen^l Land Office

Sir

Enclosed please find a Sketch of the Oliver Brown & Surrounding Surveys, showing the work as it is on the ground, also a Connection for the Jonathan Bitticks Preemption, & a few Sketches of Surveys which are not represented right on Your Map, as there was no Certificate on file in my Office I thought it sufficient to inform You of that fact.

Yours Respectfully

Adam R Johnson

S B C

File 17

Burnet County

Filed February 11/39

Connecting lines between
Burnet & Survey lying S. W.
& N. W. thereof on the Colorado
Here 2 Sketches one N. by W.
the other N. by E. of Burnet
3 Sketches by Adam R. Johnson.

No 1 - 20 Mi. N 18 W Burnet.

No 2 - 13 Mi. N. 19 E Burnet.

No 3 - Connections from Burnet

NW to J. Asher Sur. on Colorado R.

SW to J. S. Horwell Sur. on Colorado R.

Number 16706

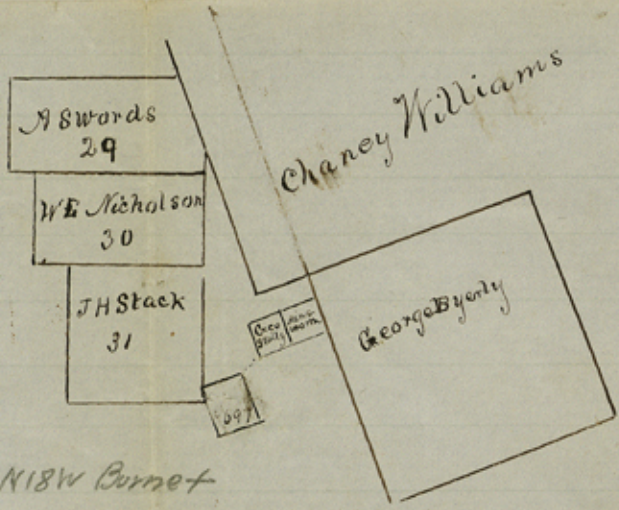

between the headwaters of
Mesquite Cr. & Rocky Cr.
N. by E. of Burnet
13 Mi. N 19 E



20 Mi. N 18 W Burnet

On the N. boundary of Burnet Co. N by W. of Burnet.

Scale 4000 Varas the inch Variation 10° 30' E

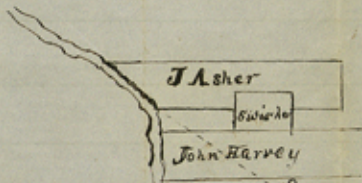

3528 2495 N 12 E Burnet

I hereby certify that Jonathan Bittick
corner
North East Survey is 3550 Varas N 40 1/2 W of the
North West Corner of the Jonathan Wilkins
Presumption Survey -

Adam R Johnson
S B C



11
Burnet

I hereby certify that
the plat of the Oliver Brown
& Surrounding Surveys is a correct
Representation of the work on the
ground -

Adam R Johnson
Surveyor Burnet Co

450 E 260 Varas from S. Hornells & Corner to Burnet



Filed Febr. 11/59
C. W. Preaster.

Counter 16707