

I further certify that the above is a correct representation of the several tracts of land and the interferences, as may be seen and laid down from the Record Books

- The Survey represented by the figures 1. at the Court is the Survey of Edward West. 20.575.296,
 By the Figures 2- King of Henry Lane 1/3 League
 " " " 3. Piece of Hugh's apt of Mr M Baring 0.2000
 " " " 4. Robert Hugh's Sur. 6.4000
 " " " 5. Joshua B. Hill 13 Lebers

and that is all the interferences with the claims of Henry L. Lane or with Joshua B. Hill, as shown from the Books of this Office

William D. Orr J.P.R.
 Dist

~~Bowie Dis.~~

— Cass County.
Showing conflict of surveys
on the waters of Black Cypress.

— Received Sept. 1. 1850 —

14 Mi.
West of Linden.

Counter 17397

D7³

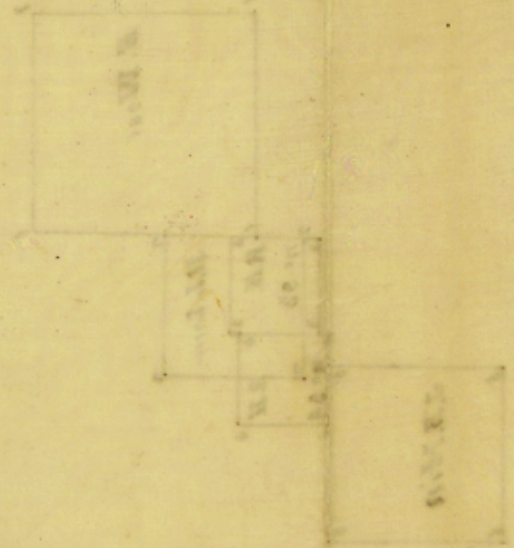

Copy of sketch

Commissions of the
General Land Office

[Faint, mostly illegible handwritten notes in cursive script, likely bleed-through from the reverse side of the page.]