

File 4

Cass County

Sketch of Surveys between
Times Bayou & Fitcher's Creek

plotted on Map

S. W. corner.
- 12 Mi. S. 80° W. Linden -

Counter 17398

24 File No. 4
- Cass County -
1853

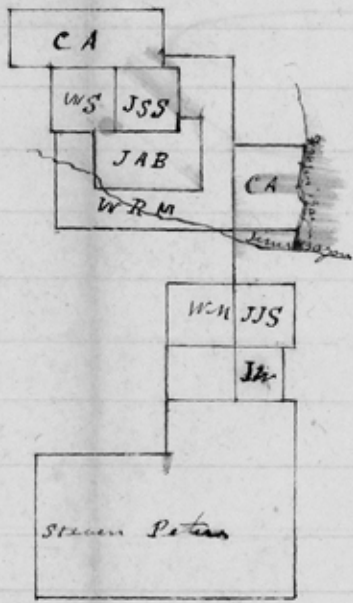

I do certify under my official oath that the above is a correct plot of surveys drawn from the field notes on record in my office

This 14th day of February AD 1853

Joseph B. McKeenolds

County Surveyor Cass Co

Counter 17399

SK. File No. 4
- Cass County -

Plot
Cass Co.



to do with any other...
is a court lot of survey from the
file notes on record in my office
this 11th day of February A.D. 1823
John B. McHenry
County Surveyor (1823)

Counter 17400