

4 4 217 42 00 410

Counter 18372

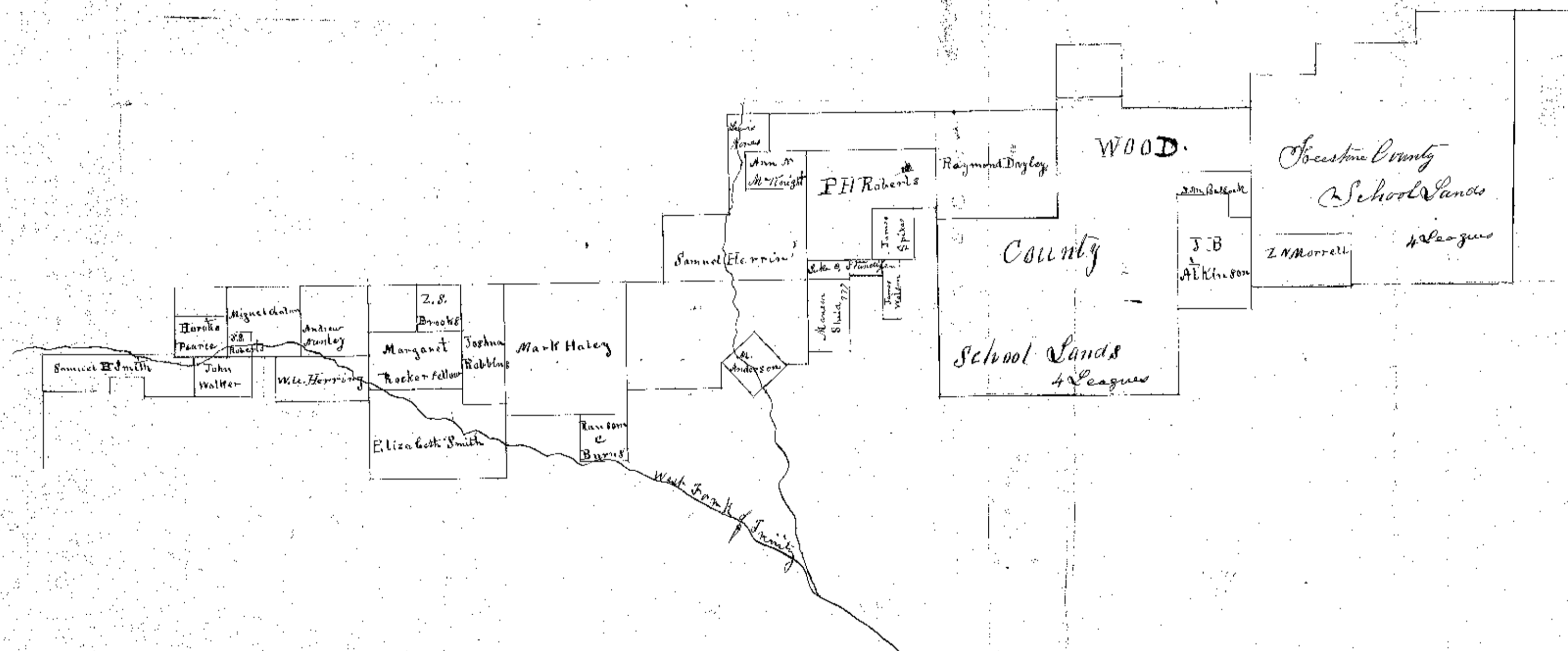

I Daniel Montague District Surveyor
 for Cooke Land District hereby certify that
 the foregoing plat is a true and correct representa-
 tion of the surveys herein delineated and as the same
 was my office
 given under my hand at
 Gansville this 25th day of
 1854

Daniel Montague
 District Surveyor

Limestone County
 School Lands
 Samuel H. Smith
 4 Leagues
 within 40 Acs

WOOD
 County
 School Lands
 4 Leagues
 J.B. Atkinson
 Z.M. Morrell
 J. H. H. H.