

File 10

Clay County

North-East part.

Counter 18406

01417 32.00 1040

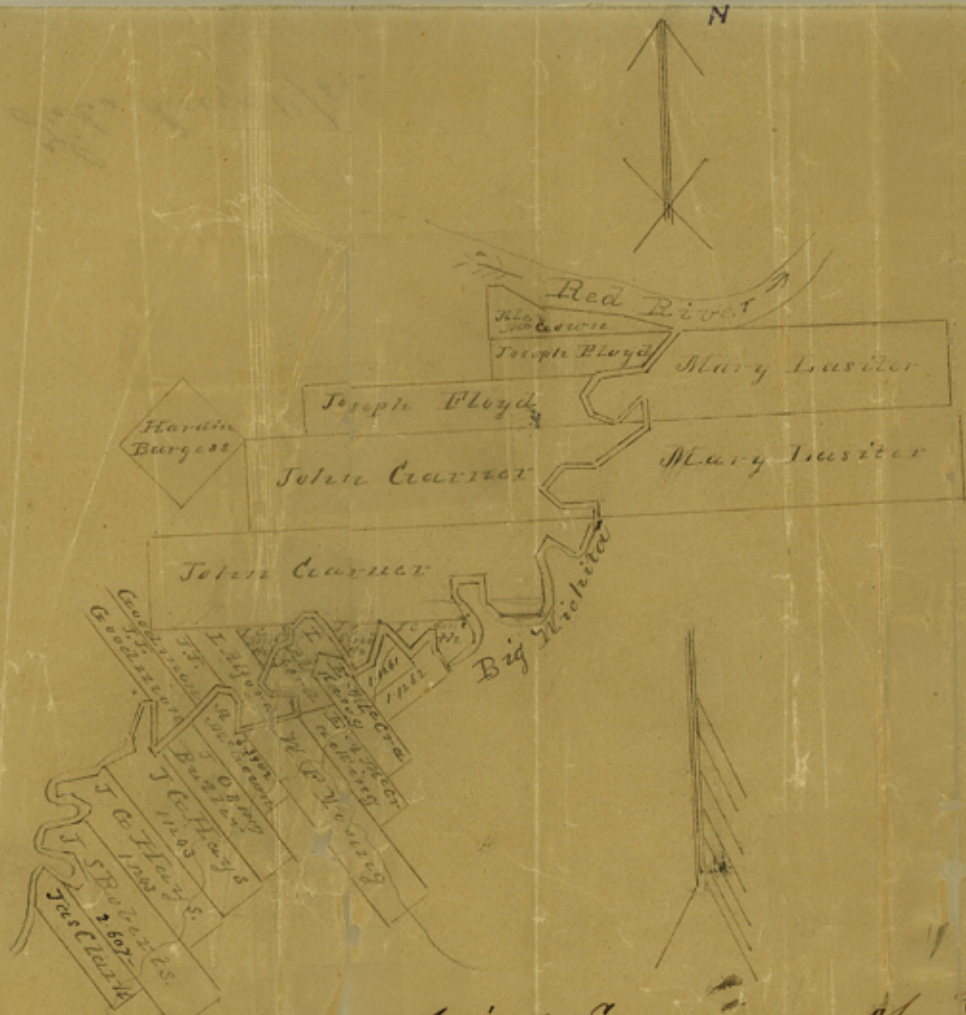

I Geo y Bird District Surveyor of Cooks Land District do hereby certify that the above Sketch is a correct Map of the Survey. Thereon represented as they appear upon the ground.
 Given under my hand at
 Cincinnati May 23rd 1866.

Geo y Bird
 S. E. C. L. S.

Filed June 10/66
 C. W. Prepler

Counter 18407