

No. 4

Howrens SK, connections & Expla-
nations

Sep. 29. 1884.

coked

13
Z

counter 18566

San Angelo, Texas
Sept 25th 1884

A. S. Howren

Georgetown, Texas.

Dear Sir - The corrections
authorized by you to be made in your & L. C.
Davis' report of connection from N. corner of the
Brookshire to the West corner of the Flores survey
No 3 on the Colorado river, have been made,
and the report now reads - "15 miles 1071^{ft}
N. and 9 miles 1331^{ft} South." Also, "N 30 E 1546"
"for the West corner of the Carlos Flores
survey No 1003 from which a Mesq^t 10 in diam
N 24 E 14 1/2^{ft}" And the words "two Mesq^ts
of root 5 in diam bear S 77 E 4^{ft}" have
been erased. (or marked out)

A. S. Howren

Co Surveyor Tom Green Co

Geo
L

as the variation of the Brookshire and the
river survey) at 1100^{ft} passed the S W
corner of No 203 264 T. & R. R. Co, at 3000^{ft} the
S W corner of No 204, at 4325^{ft} the junction
of Eagle & Oak creeks, at 8140^{ft} a bend of
Antelope creek, at 8250^{ft} crop said creek.
at 8700^{ft} S W corner of No 207 on top of a
small mountain, at 95800^{ft} the S W

County 18567568

To the county surveyor of Tom
Green county, Texas -

Report of connecting lines sur-
and surveys made on the ground
by G. E. Davis, Deputy surveyor of said
county, and A. S. Howren county
surveyor of Williamson county, for
the purpose of correcting the field notes
of certain surveys situated on the Colo-
rado river between the Carlos Flores
survey No 1003 and the E. line of Block
15 S. P. R. R. Co. as shown by the Map
of Tom Green county.

We began at the North corner of
the Nathan Brookshire survey No 473 in
the south line of section No 203 H. & T. Co.
R. R. Co. which corner is well defined
by a Mesquite tree which bears N 74 $\frac{1}{2}$ E
184 $\frac{22}{11}$ From this point we ran a line
due West at a variation of 9 $^{\circ}$ 45' (which
is the variation of the Brookshire and the
river survey) at 1100 $\frac{22}{11}$ passed the S. W
corner of No 203 H. & T. Co. R. R. Co., at 3000 $\frac{22}{11}$ the
S. W. corner of No 204, at 4375 $\frac{22}{11}$ the junction
of Eagle & Oak creeks, at 8140 $\frac{22}{11}$ a bend of
Antelope creek, at 8730 $\frac{22}{11}$ cross said creek.
at 8700 $\frac{22}{11}$ S. W. corner of No 207 on top of a
small mountain, at 25800 $\frac{22}{11}$ the S. W

corner of N^o 216 H & T. C. in a valley
on the east side of Yellow Wolf creek,
a stone mound whence a Magnet 10
in bears N 87 W 57th and Bart Green's
house bears S 31 E. and an old "chory" bears
S 28 1/2 W. Thence South with the West
line of 239 H & T. C. at 300th Yellow Wolf
creek, at 1700th a bend of said creek
at 1900th S. W. corner of 239 on west bank
of said creek opposite Rendleton's sheep pen.
Thence South with West line of N^o 267
at 640th west bank of creek, at 1260th west
bank of creek, at 1380th North line of Fred
Strader's fence, at 1900th S. W. cor. of N^o 267.
and N. E. cor. of N^o 300 on west side of Yellow
Wolf creek, 8th from channel. Thence South
with N. line of N^o 299, at 20th creek, at
167th intersect Nolan & Tom Green
county line about 300th East from
the 27th mile post, at 370th top creek
again, at 1380th Big Hollow branch, at
1900th S. W. cor. N^o 299 in a valley.
Thence South with N. line of 298, passing
through a gap between two tall mountains
at 1900th a stone mound for S. W. corner
of N^o 298 at the head of a hollow that
runs southeast. Thence South with N.
line of N^o 317, at 1900th a stone mound

for its S.W. cor. on a hillside that slopes
 northeast. Thence South with West line
 of N^o 470, at 1900[±] a stone md on the
 east side of a deep hollow about 18[±]
 from the channel. Thence South with
 the East line of N^o 477, at 790[±] a point
 260[±] due West from the N.W. corner of the
 Geo Gurbell survey N^o 597, at 1610[±]
 crop Yellow Wolf creek, at 1900[±] a stone
 md for the S.E. corner of N^o 477 T.C. & J.C.
 on the north bank of a branch, where
 a Musgt 4 in bears N 77 E 1[±] - In the G. Rector ^{survey}
 Thence West with the S. line of N^o 477
 at 130[±] crop Yellow Wolf creek, at 1900[±]
 a stone md for the S.W. cor. of N^o 477, about
 60[±] East of the Sweet Water road. Thence
 South with the E. line of N^o 471, at 1360[±]
 crop Yellow Wolf creek, (conies West) at
 1900[±] a stone md and Antelope horn
 in a valley for the S.E. cor of N^o 471 in
 the Young Carothers survey, from which
 a L. oak bears S 64 E - South point of Mead-
 ow Mountain brs N 59 3/4 W - Indian Grass
 Mountain brs S 31 1/2 W - Thence South
 1900[±] to a stone md for the S.E. corner
 of N^o 484 T.C. & J.C. R.R. Co. Thence West
 at 710[±] south point of a Mountain on
 north side of a gap, at 1900[±] a stone md

41)

for the S.W. corner of 484 on East side
of Yellow Wolf creek in a bend 90⁰⁰
south from creek, whence a bunch of
4 Elms 8 in dia. from same root, bears
N17 E 67⁰⁰ From this point we went
to the N.W. cor. of No 1001 on the S. line of the
C. Flores survey which we found as de-
scribed in the field notes of the same, and
ran thence S60 E to the N.E. corner of 1001
on the East bank of Yellow Wolf creek; thence
S30 W 140⁰⁰ to a corner of the Carlos Flores
survey No 1003 in the channel of said creek.
Thence S60 E 356⁰⁰ to a stone mark for the
S.E. cor. of said Flores. Thence N30 E at 1785
varas bluff of south bank of said creek, at
1840⁰⁰ main channel, at 2100⁰⁰ creek
again, at 2268⁰⁰ a stone mark the N.E. cor
of said survey. Thence North, at 481⁰⁰ x
Yellow Wolf creek, at 1701⁰⁰ x creek again,
at 1331⁰⁰ a point 29 varas East of the
stone mark previously made for the S.W.
corner of No 484 of T.C. R.R. Co. Thus
completing the connection between
the north corner of the Brookshire and
the N.E. corner of the Carlos Flores No
1003, the latter being 15 miles, 1071⁰⁰ West,
and 9 miles, 1331⁰⁰ South from the former.
The Yellow Wolf survey - G. Carothers

C. Reector, Geo Gunkell, Robt McRea, J. R.R. 3+4, and Jms Row - were resurveyed by C.E. Davis, and the old corners with bearing trees found, and otherwise identified, showing that sections Nos 298, 317, 470, 472, 471 and 484. 26 & 7 C. R.R. Co. conflict largely with these surveys

From the N.W. corner of 1001 we ran N30E 1543⁰⁰ thence N60W 872⁰⁰ to a stone end on the East bank of the Colorado river for the West corner of the Carlos Flores survey N2 1003, from which ~~the~~ ~~course~~ ~~is~~ ~~not~~ ~~in~~ ~~line~~ ~~with~~ ~~37764⁰⁰~~ and a Meast 10 in. brs ~~8474~~ E 14 1/2⁰⁰ - the original trees called for at this corner are gone - thence up said river with its meanders as follows:

Course	Dist	N	S	E.	W	
N 8 E.	(330) 330	327		46		
N 10 W	118	116			20	
N 48 1/2 W	400	265			300	
N 59 W	580	299			497	at 474 Mouth of Rough creek
North	300	300				
N 60 W	636	318			551	
N 30 E	600	570		300		
N 43 W	620	453			423	at 460 Mouth of Meadow creek
N 63 W	600	272			535	
S 71 W	360		117		340	at 370 Little Sand creek

L6

C	DO	N	S	E	W	
S 10 E	60		59	10		
S 35 W	325		266		186	
S 60 W	210		105		182	
S 5 E	1000		996	87		
S 31 W	530		454		273	Opposite the mouth of River
S 8 W	135		134		19	crack
West	80				80	
N 37 W	480	383			289	
N 28 W	800	706			376	
N 38 W	770	607			474	
N 68 W	700	262			649	
S 82 W	340		47		336	
S 72 W	660		204		627	
S 75 W	390		101		376	
S 43 W	230		168		157	
S 52 W	300		185		236	
S 22 W	310		287		116	
S 52 W	790		486		622	
S 71 W	770		251		728	
S 45 W	610		431		431	at 580
S 67 W	470		184		433	Scott's fence at 470
N 76 W	430	104			417	Scott's fence
N 45 W	550	389			389	
North	170	170				
N 59 E	550	283		471		
N 41 E	640	483		470		
N 30 E	830	719		415		
N 2 E	940	939		33		at 35 as Big Sand crack

Z¹

67

G.	So	N	S	E	W
N1877	270	257			83
N84½77	2120	203			2110
S86¾77	600		35		599
N3577	740	606			474
N76E	430	386		189	
N3377	410	344			223
N73E	390	114		373	
N1077	360	354			63
N2377	520	479			203
N3877	630	496			388
West	300				300
S7777	390		88		380
N8477	420	44			418
S25½77	330		298		142
S4577	150		106		106
N6877	630	236			584
N8477	900	94			895
N75½77	1090	273			1055
N6477	980	430			881
N1377	1120	1091			251
N51E	150	94		117	
N7E	450	447		55	
N72E	1210	374		1151	
N7E	310	308		38	
N5477	680	400			550
N8777	1680	88			1678
N4577	860	608			608
N60E	400	200		346	

at 270 opposite China Matt

at 300 West Sand creek

L⁸

	E	N	S	E	W
N 30 E	990	857		495	
N 65 E	1500	634		1359	
N 38 E	720	173		135	
North	670	670			
East	80			80	
North	710	710			
West	400				400
N 45 W	440	311			311
S 36 1/4 W	530			476	315

cross river for
1st time

cross river

Intersect the
Tom Green &
Mitchell Co.
line 676 1/2
East from
the 4th mile
post.

Thence S 36 1/4 W from said
point in said Co. line, at 40 1/2
the Colorado river, at 2770 1/2
the South corner of section No 1
Block 15 S.P.R.R. Co. on top
of a Cedar Mountain.

The apparent error in Westing
is no doubt due to an excess in
the 14 miles of county line between
our two intersecting points.

Respectfully submitted

Variation of County
line 10° 15' E.

C. E. Davis
A. S. Howren

May 26th 1884

Examined and approved

This Aug 12th 1884 and Recorded in
Book 3 pages 547 to 568 inclusive

A. B. Parker
Co. for Tom Green Co. Ind.

29

Report of connecting
lines
C. E. Davis &
A. S. Howren

The State of Texas }
County of Williamson } I, A. S. Howren,
County surveyor of Williamson County,
hereby certify that the foregoing report
made to the County surveyor of Linn
Green County, and signed by C. E. Davis
and myself, was written by me, and that
subsequently and before the filing of the
same in the General Land Office, we dis-
covered that the field notes of the Carlos Flo-
res survey No 1003 make its East line 2768⁰⁰
long, while the sketch in one possession made
it only 2700. This necessitated a change in
the following numbers to wit: 2768, 481,
1701, 1331, 79, 1071, and 1331 on page 4;
and 1543, 847 $\frac{1}{2}$ & 14 $\frac{1}{2}$ ⁰⁰, 330, 377 & 40 on page
5; and also the measure of line thirteen on
page 5, all of which was done by me, &
approved by H. B. Tamm, County Clerk of
Linn Green County, and
statement of

given under my hand, this the 29th
day of Sept. 1884

A. S. Howren,
C. S. T. C.

Sworn to and subscribed by A. S. Howren
before me, this 29th day of September A. D. 1884
J. W. Hodges Clerk County Court
Williamson County Texas
By C. R. Paulson Deputy

Tom Green
Sketch 54

N.E. corner of
Woke Co
Sketch file 4

Woke Co. line 676 of
East from
to 4 1/2 miles
East
farm said
said Co. line at 400
to given, at 2720

Number 18577



U.S. GEOLOGICAL SURVEY

Mitchell Co.

Notan Co.

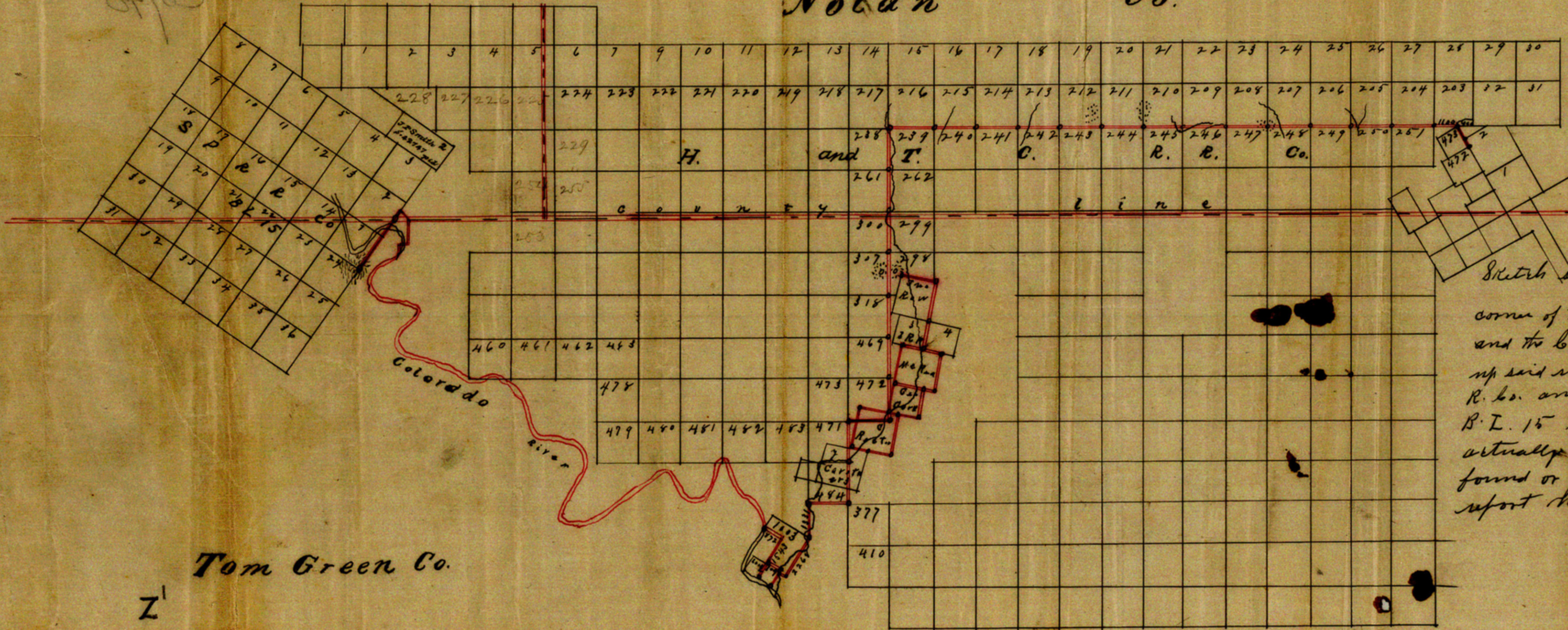

Sketch showing connection made on the ground between the north corner of the Nathan Brookshire survey No 473 in S. line No 203 to S.P.R.R. Co. and the Carlos Flores No 1008 on the north bank of the Colorado river; thence up said river with its meanders to the E. line of sec. No 7 B.L. 15 S.P.R.R. R. Co. and thence to the S.E. corner of No 1 on a Cedar mountain, B.L. 15 S.P.R.R. Co. The double red lines indicate the lines actually run by us, and the corners designated thus a river found or made by us. This sketch is made a part of the report hereto attached.

Tom Green Co.

Z¹