

A W Rowlett

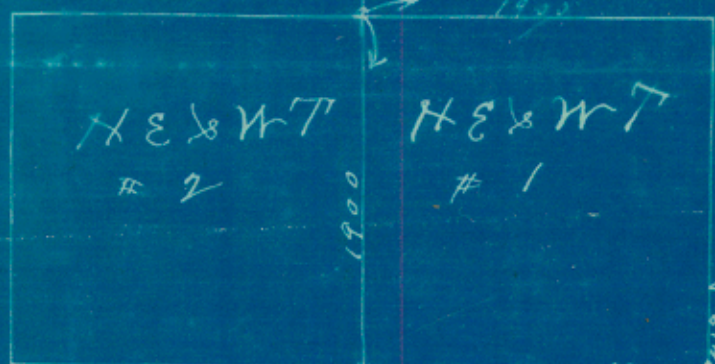

Schneider

Julius Moreau

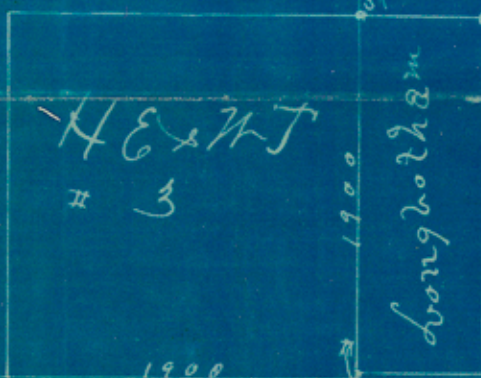

D Larkin

A B & M # 20  
685 a.

A B & M

Holgood

Ocean is N 26 E 2 00  
 Shows to be recognized  
 as one of the b.t.s. and  
 found to be there  
 by compass distance

J. W. P. Graves do hereby certify that this is a true and correct sketch of these surveys as I found them on the ground. Surveyed from original corners as shown herein defining the positions of Section # 20 A. B. & M.

J. P. Graves Co. San Jose Co  
 Nov 12 1911

11-18-11

County 18614