



Counter 18664

Coleman County

And

Sketch

Surs. in N. W.
Part County

Counter 18665

9

The Law requires all payments for University, School and Asylum Lands, and purchases made under various Acts to be made to the State Treasurer—they must not be sent to this office.
 In correspondence relating to lands, always give Name of Original Grantee, with class and quantity, and County in which it is located.



GENERAL LAND OFFICE.

W. L. McGAUGHEY, COMMISSIONER

W. M. BRAMLETTE, CHIEF CLERK

AUSTIN, Texas.

189

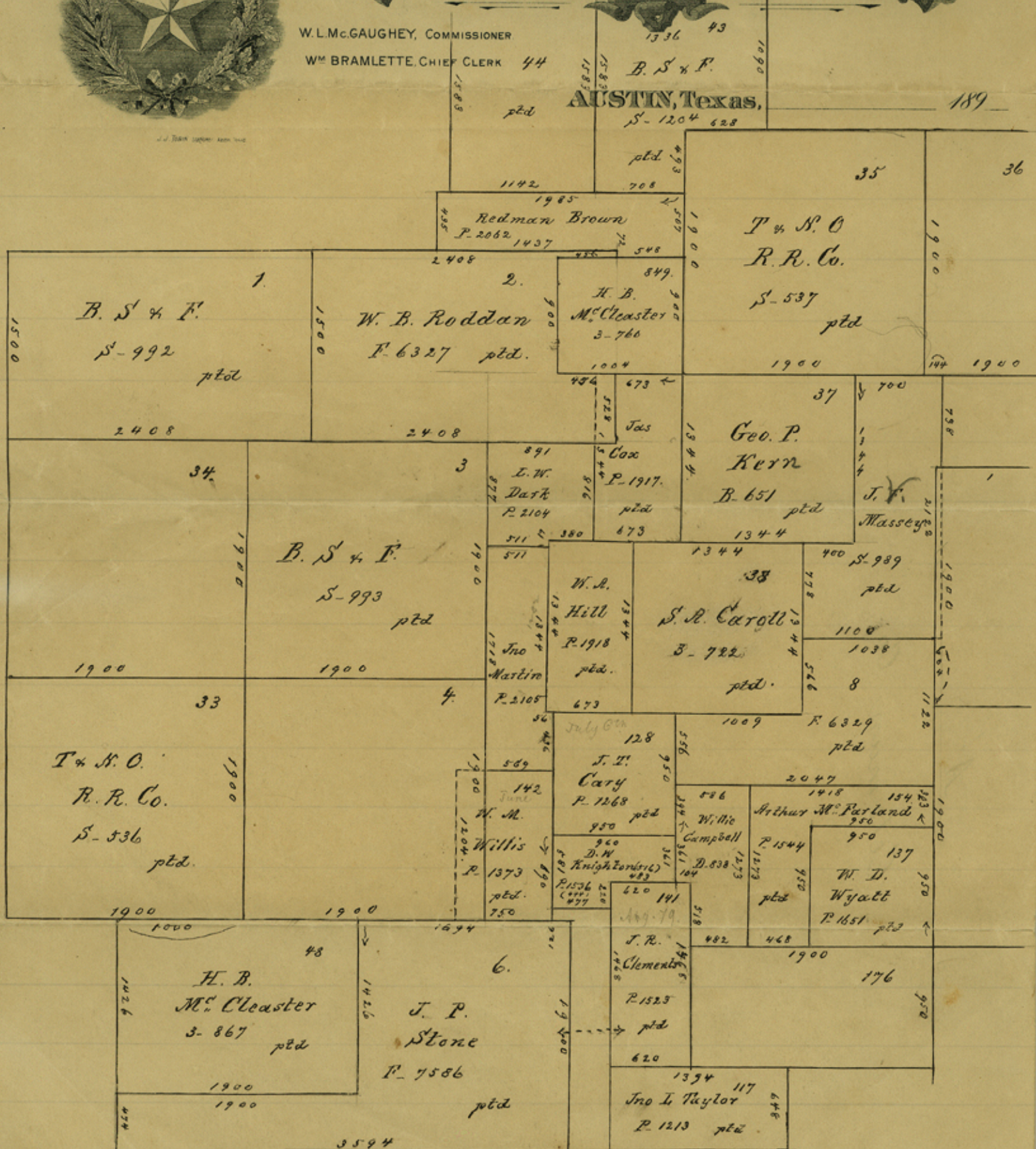

Counter 18666