

S.A.M.G.
R.R.Co.
No. 19.
John S.
Whitman

Colorado County
Field notes No. 733-746.

S.A.M.G.
R.R.Co.
No. 18.

S.A.M.G.
R.R.Co.
No. 17.

For
Grant.

N 65° E.

5100.

corner on River

S.A.M.G.
R.R.Co.
No. 8.

21/221

San

S.A.M.G.
R.R.Co.
No. 7.

21/221

Henelly.

S.A.M.G.
R.R.Co.
No. 9.

S.A.M.G.
R.R.Co.
No. 6.

S.A.M.G.
R.R.Co.
No. 10.

S.A.M.G.
R.R.Co.
No. 5.

B.B.B.C.
R.R.Co.
No. 2.

B.B.B.C.
R.R.Co.
No. 1.

2681.

Red Bluffs

corner on River

S.A.M.G.
R.R.Co.
No. 1.

H.T.A.B.
R.R.Co.
No. 2.

H.T.A.B.
R.R.Co.
No. 1.

no 10/303

no 413

no 413

S.A.M.G.
R.R.Co.
No. 2.

N 65° E 3820.

Heirs

of

Conrad

S.A.M.G.
R.R.Co.
No. 3.

no 10/307

S.A.M.G.
R.R.Co.
No. 4.

no 10/307

Gurgens

J. S.

Evans.

N 65° E 3900

corner on
River

Creole
Mustain

N 25° W 7095

N 25° W 6618

N 25° W 3222

400

N 45° W 567

[Faint handwritten notes on the left side of the page]

M2

Fito 14.
Colorado Co.
(Surveyors Shack)

West of the Colorado
R.

Filed Dec 31. 1874
J. P. [unclear]

Handwritten notes on the left margin, including "Fito 14" and "Colorado Co."

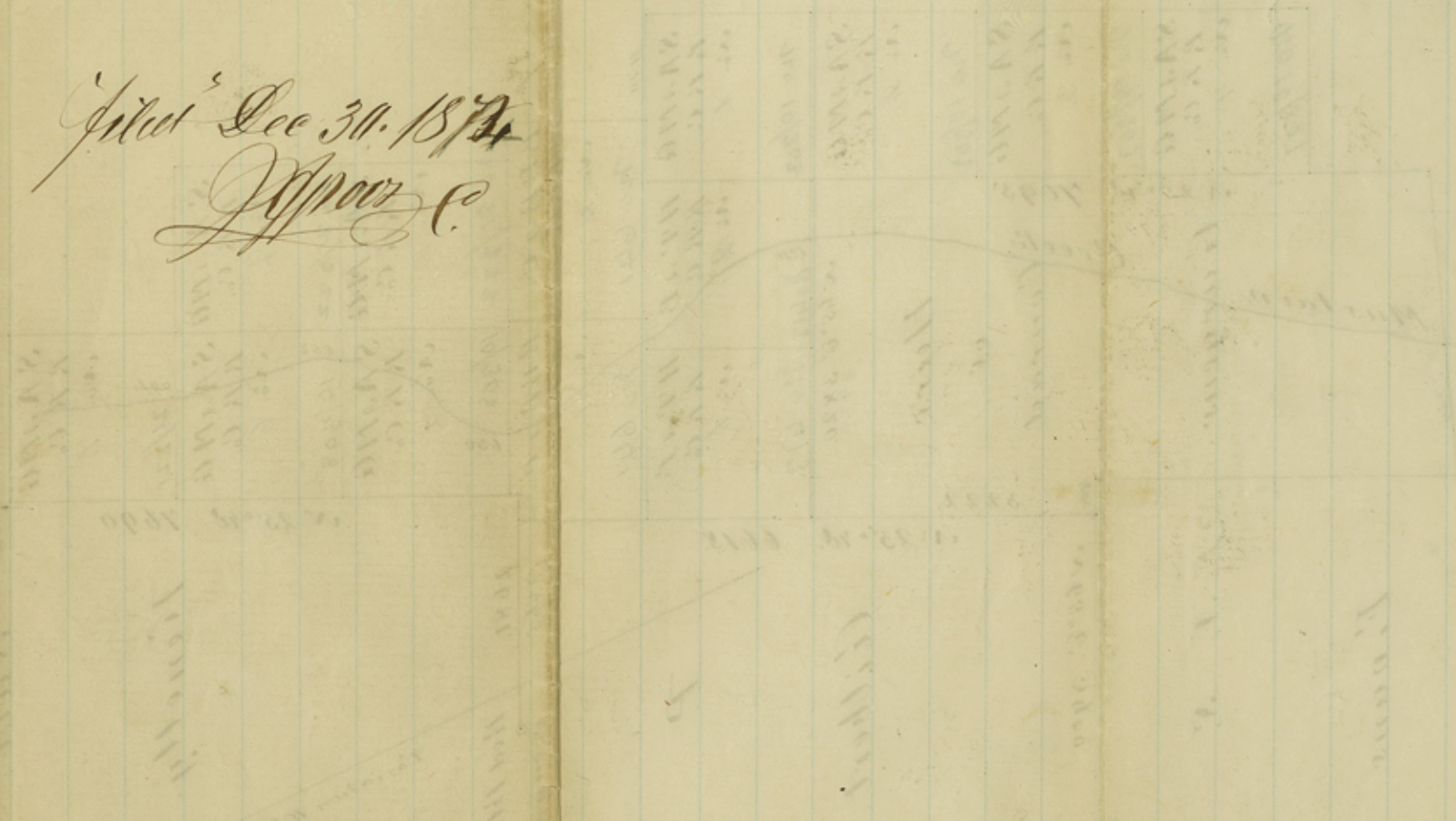
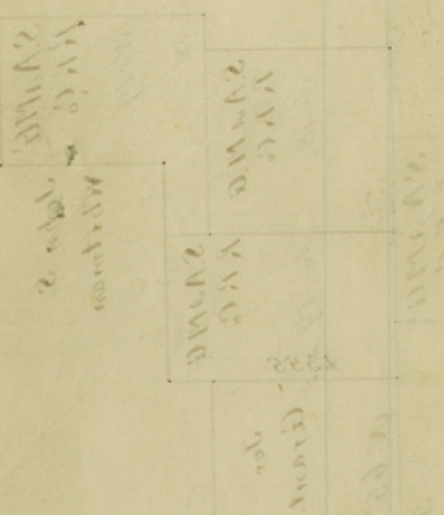

Counter 18740

MP

Plat and Report

of the Survey on Mustain Creek and Pinook Creek
West of Colorado River and South of Skull^{Skull} Green.

Before I began the Survey on Mustain Creek, I had to reestablish the corners in Prairie of the Sam. Henelly, P. Gilbert, T. S. Evans and Conrad Gurgens surveys and found the upper N.E. corner on River of Sam. Henelly survey well established, ran the Northline $S 65^{\circ} W$ well established through timber 5100 Varas (its call) and reestablished the N.W. corner by a post and mound; its division corner on River of the Sam. Henelly and P. Gilbert survey people showed me a cottonwood tree on the mouth of a Ravine on a point of River bank called Red Bluff, ran this line by its call $S 65^{\circ} W$ 2300 Varas; began the Baseline on the established N.W. corner of Sam. Henelly $S 25^{\circ} E$ and met the Division line at 7690 Varas (call 6000) and had also to prolong said Division line to make 2687 (call 2300) Varas; Began again on the River bank at the well established S.E. corner of P. Gilbert and N.E. corner of T. S. Evans survey, ran a good established line through timber $S 65^{\circ} W$ 3900 Varas and established the S.W. corner of Gilbert being also Beginning corner of Heirs of Conrad Gurgens survey, a post and mound; reestablished from this point $N 25^{\circ} W$ at 3222 Varas (its call) ^(not do) the N.W. N.E. corner of Gurgens survey and prolonged said course in all 6618 Varas (call 6000) to meet the Division line and found the Northline of P. Gilbert survey 2365 Varas (call 3500) and finished the survey of Conrad Gurgens by its field notes.

December 1st 1874.

H. F. Dillmer
County Surveyor.

Colorado County Fieldnotes No. 747-752,
753 & 754.

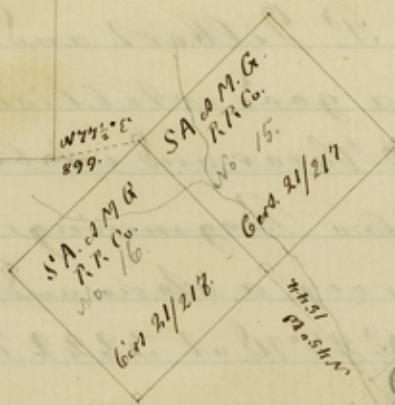
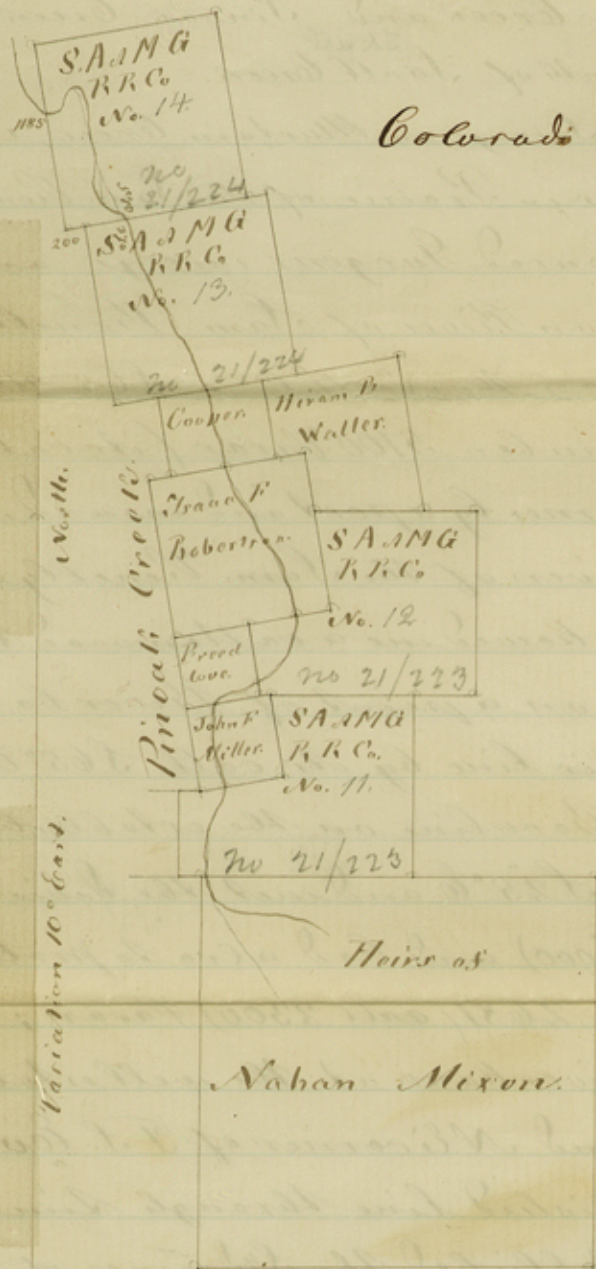

Connection from S.E. corner of Nixon N 77 1/2° E 899' to corner of No. 16.

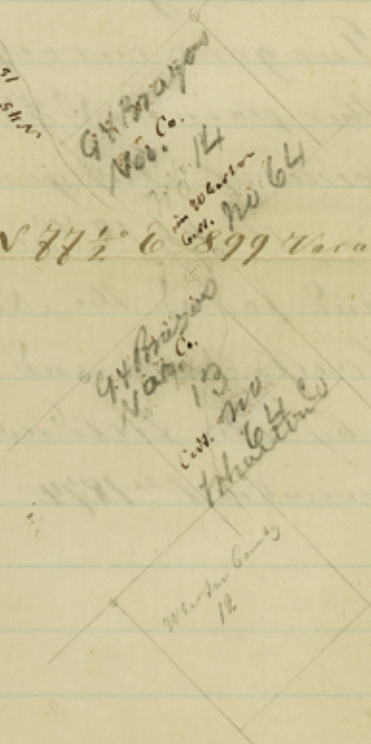

M