

Plotted Dec. 4/57.
Schilze.

995
1757
2388
519

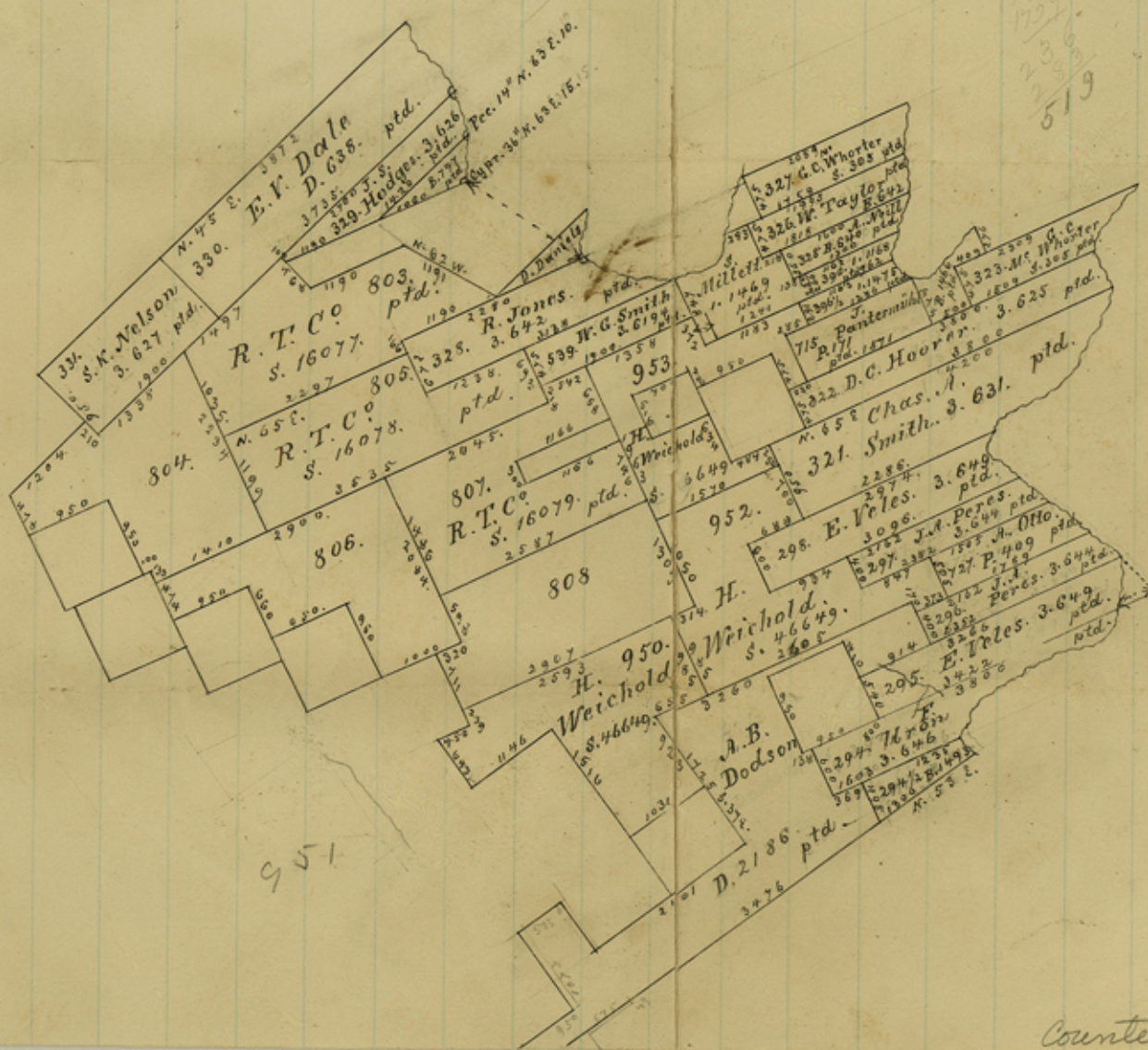

951



(32)

- 1. P. N. N. 7 1/2 S 2 3/4
N 30 W 17
- 2. P. N. W. 7 1/2
S 30 W 18 N W 2 0 0
- 3. P. S. S. W. 2.4
N 27 W 2 10
- 4. 6.0
- 5. P. S. 2 0 W 14
N 10 W 15
- 6. N 10 W 5.6

File 18.

Comal Co.

10 miles N. 30 W.
from New Braunfels.

1. N 30 W 17
2. S 30 W 18
3. N 27 W 2 10
4. 6.0
5. N 10 W 15
6. N 10 W 5.6

1. P. N. N. 7 1/2 S 2 3/4
N 30 W 17
2. P. N. W. 7 1/2
S 30 W 18 N W 2 0 0
3. P. S. S. W. 2.4
N 27 W 2 10
4. 6.0
5. P. S. 2 0 W 14
N 10 W 15
6. N 10 W 5.6