

To the Commissioner }
 Genl Land Office }

I A. H. Tuggle County Surveyor of Comanche County do hereby Certify that I did begin at a Stone Monument for the the South West Corner of a survey made for John B. Grimes from which a Mesquite tree N. 22 W 2100 = Thence I run West - 6861 acres. I then run South 100600 to a Stone Monument for the N E Corner of No 42 made for the School Commissioners of Comanche County from which a Live Oak tree N 65 W 2800 and a Live Oak tree N 51 W 3200 acres. I do further Certify that I did begin at the N E Corner of a survey made for Vina Campbell (a State), from which a Mesquite tree S 19 W 1600 and a Live Oak tree N 43 E 63 1/200 = Thence I run South passing the S E Corner of said survey at 195000 continued South 424000 to the North line of No 42 Comanche County School Land = Thence East 158000 to the N E Corner of No 42 The above distances I formed by actual measurement Given under my hand at Comanche

This 11th day of May 1872

A. H. Tuggle
 District Surveyor of Comanche
 Dist

file 19.
Comanche Co.
Surveyors Sketch
filed May 23/72
Three pages
S. West part.

Counter 19094

- File 19 -

Surs. S. W. part of County -
Comanche Co

Counter 19095

file 19.
L. M. M. D.
Surveyor's Office
field, July 24/72
Trilley

S. W. Park.

The state of Texas & Greenleaf Gilt District Surveyor Brown
 County of Brown 3 District do hereby certify that I have examined
 the foregoing field notes showing the true position of the several
 tracts of land therein named and the sketch herein below made
 and find them correctly made given under my hand at office
 in the Town of Brownwood this 2nd day of July A.D. 1842

Greenleaf Gilt District Surveyor Brown District

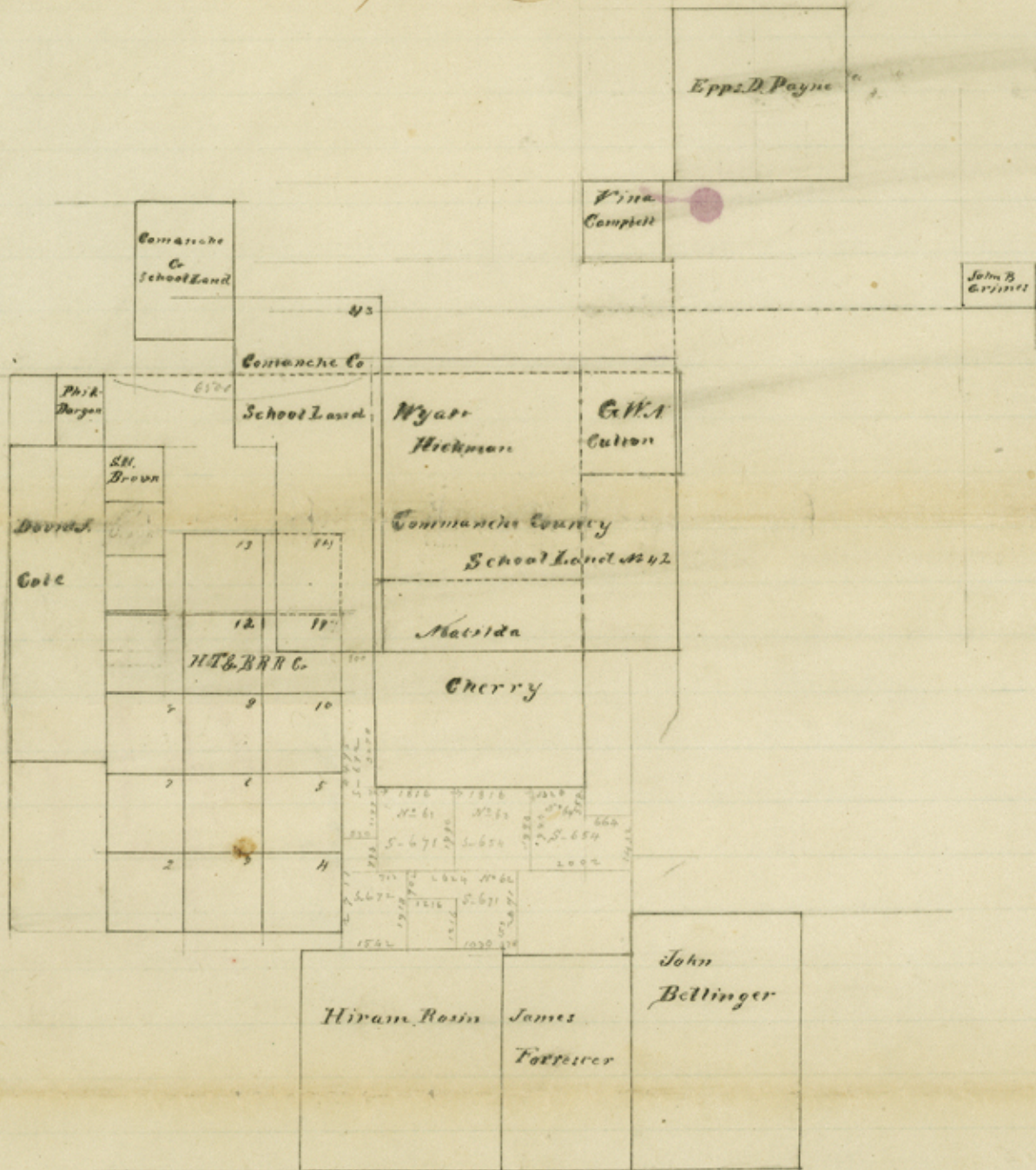

To The Commissioners
Gen^l Land Office
Austin Texas

1

J. R. G. Armstrong

Deputy Surveyor of Brown County do hereby Certify
that I did find the following described Courses and
distances by actual measurement to wit:

1st - Beginning at the N.E. Corner of a Survey made
for Philip Dargam from which a post oak 8 in dia
bears S 21° E 112 Varas thence E 6500 Varas to the N.W.
Corner of a Survey made for Wyatt Hickman Contained E 6721
Varas in all to the West line of No 42 made for the School
Commissioners of Comanche County thence N 349 Varas
to a Stone mound for the N.W. Corner of No 42 for said Com^{rs}
from which a live oak brs West 90 Varas another live oak brs S
N 87 Varas bearings as shown "S"

2nd - Beginning at a stake for the S.W. Corner of No 42 for
School Com^{rs} of Comanche County from which a Black Jack brs S 57 N
3 Varas another Black Jack brs S 53 N 3 Varas thence N 2842 Varas
thence N 1021 Varas to a stake for the N.E. Corner of section No 14
made for the Houston, Dap & Brazoria Rail Road Company from which a Post
Oak brs N 1. V and a double Post oak brs S 30° E 8 Varas

3rd - Beginning at a Stone mound for the S.E. Corner of No 42
from which a live oak brs S 65½° E 7 Varas another live oak brs
N 72 E 15 Varas thence S 6389 Varas to the North line of No 315
made for John Bellinger thence N 1204 Varas to a stake for the N.W.
Corner of No 315 from which a Black Jack 6 in dia brs S 66½°
E 3 Varas another Black Jack 6 in dia brs S 14 E 3 Varas

The above described Courses and distances are correctly shown
by the accompanying Sketch

J. R. G. Armstrong Deputy Surveyor of
Brown District