

~~File 17~~

File 7.
Coudes
Deer County
Recd January 5/57

County 19129

M.

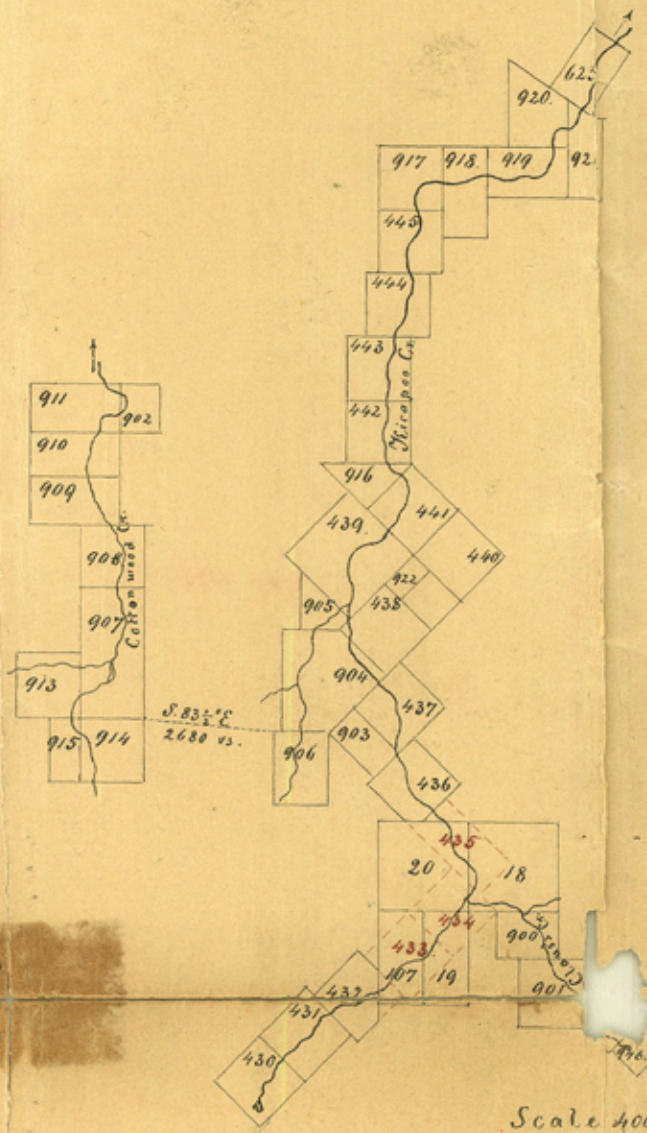

Scale 4000 vs to the Inch.
Variation 9° 45' E.

Reference.

Survey N ^o 900. of 224 ac.	heirs of Michael Meyer.
901 320	Heinrich Altan.
902 148.6	Olto Prehn.
903 171.4	
904 563.7	Gottlieb Gerbing.
905 106.4	heirs of Rudolph Haab.
906 320	Georg Parsky.
907 640	
908 320	Ludwig Fosse.
909 320	Phil. W. France.
900 320	Hubert Bonzano.
911 320	Franz Anton Miller.
913 320	H. Chr. L. Aschoff.
914 320	heirs of Mr. Roth.
915 160	heirs of Georg Blum.
916 160	
917 320	Wm. Vilas.
918 320	heirs of Georg Haab.
919 320	Adam Schuhmacher.
920 336.5	Heinrich Kuchn.
921 303.2	
922 66 1/2	Gottlieb Gerbing.
947 96	heirs of Michael Meyer.
948 51	Christ. Friedr. Wetzel.
436 313 1/2	heirs of Johann H. Braun.
432 288	Christoph Thizme.

Surveyed by W. Friedrich Dep. Surv.
Bex. Dist.

J. Francis Giraud District Surveyor of Bexar District do hereby certify that I have examined the above plat of the work on the heads of Kickapoo and Cotton Wood Creeks, and found it correct.

San Antonio
Nov. 1857.

J. Giraud
Dist. Sur. Bex. Dist.

Filed January 5th 58
E. W. Pfeiffer.

M.

counters 19/30