

File 18-
Sketchs & FN by
~ H B Tarver, ~

Couchs Co

Counter 19137

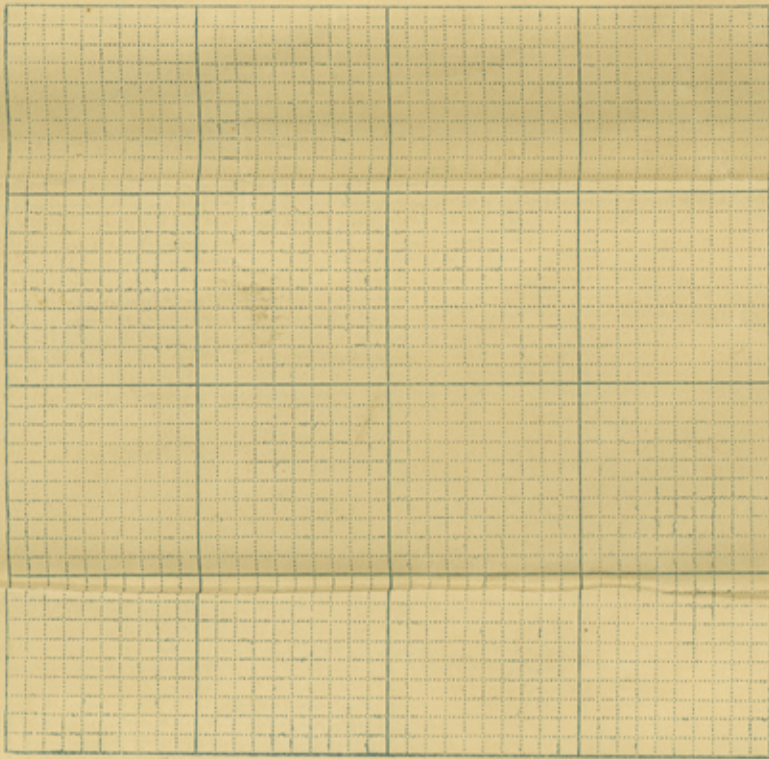

THE STATE OF TEXAS,

Survey No. _____

Tom Green County.

FIELD NOTES of a Survey of *The German*

Land made for *Emigration Co* surveys on the Concho River in Tom Green & Concho Coos: Including sur 142 to 572 on South side of river: No 596 to 585:- 358 to 355 on the North side of river. Made for Louis Runge.

Said Survey is No. _____ in _____ County, Texas, situated on the waters of _____, a tributary of _____ River, about _____ miles _____ of _____

SCALE _____ VARAS PER INCH.

VARIATION *9° 5'*

Beginning at *Common Corner of 142/143 one bearing standing & identified.*
Thence *S 666 varas:- W. 561 varas to Cor 143/546: Trip Pecan. S. 72 W. 10: stump of other bearing in river.*
Thence *S 355:- W. 470:- N. 220 to Cor. 546/547. One bearing standing*
Thence *W. at 461 point 810 varas S of river at cor. 547/548:- at 1042*
~~Thence~~ *varas point 1060 varas S. of river at Cor. 548/549:- at 1567*
W line ^{sur} 549
Thence *N. 1016 to river for cor. 549/550: point 41 varas S of cor. 596/597*
" *S 98 :- W. 509 to river for cor 550/551*
" *S 300 :- W. 529 " " " 551/552*
" *S. 580:- W. 509:- N. 120. to river for cor. 552/553.*
" *S. 120:- W. 484:- N 361 to corner. 553/554. one bearing standing*
" *W. 498:- N. at 120. cross branch: 247 to corner. 554/555 one bearing standing*
" *W. 434:- N. 1146 to corner 555/556: Large pecan N. 64. W. 12.*
" *S. 113 :- W. 995:- N. 400 to. corner 557/558 both bearings*
" *W. 477:- N. 200: to river for corner. 558/559*
" *S. 140:- W. 550:- N. 400 to river for Corner 559/560*
" *W. 503:- N. 1190 to river for Corner. 560/561*
" *S. 355 :- W. 537 to corner of 561/562 one bearing standing*
" *S. 260 :- W 496 to river for Corner 562/563*
" *S. 203 :- W 512 to Corner 563/564 both bearings standing*
" *S. 220 :- W 509 :- N. 106 to Corner. 564/565: Elm. 12. S. 85. W. 6/10*
_____ to the place of beginning.

Bearings marked _____ } CHAIN CARRIERS.
Surveyed _____ 188 _____

I, _____, County Surveyor of _____ County, Texas, do hereby certify that the foregoing described Survey was actually made by me on the ground, according to law, on the date and with the Chain Carriers aforesaid, duly qualified, and that all the Corners, Lines, Boundaries and Marks of the same, whether natural or artificial, are truly and correctly described and set forth in the foregoing Plat and Field Notes.

By _____ Deputy. _____ County Surveyor. _____ County, Texas.

Filed for Record the _____ day of _____ 188 _____, at _____ o'clock _____ M.

Surveyor.

Center 19138

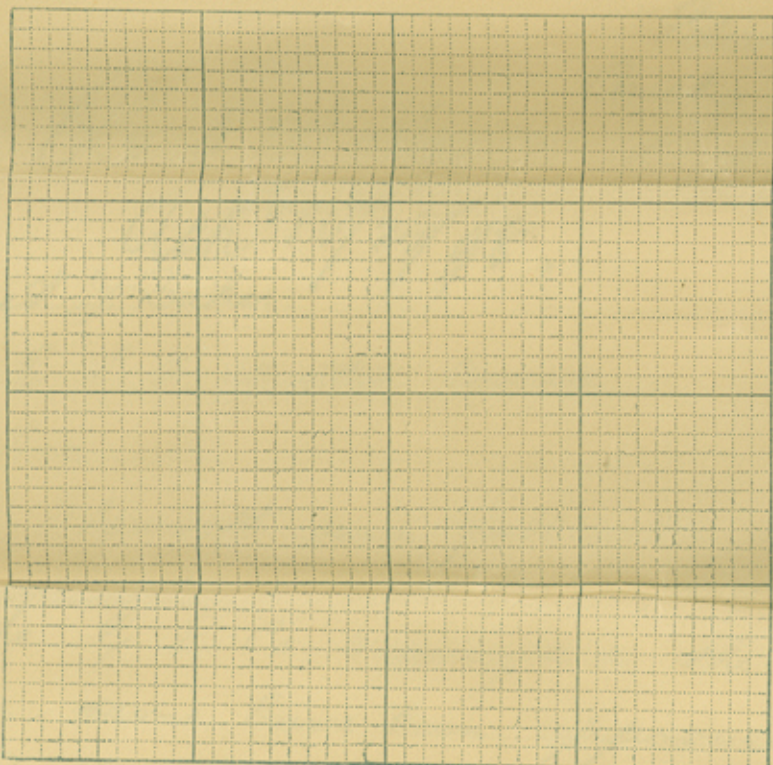

THE STATE OF TEXAS,

Survey No. _____

County. _____

FIELD NOTES of a Survey of _____

Land made for _____

Said Survey is No. _____ in _____ County, Texas,

situated on the waters of _____, a tributary

of _____ River, about _____

miles _____ of _____

SCALE _____ VARAS PER INCH.

VARIATION _____

Beginning at
 Thence S. 417 :- W. 200 to river for corner. S. 100 :- W. 17 to river Cor. 565/566
 " S. 100 :- W. 507 to river for corner. 566/567
 " S. 40 :- W. 539 :- N. 110. to river for Cor. 567/568
 " S. 454 :- W. 507 :- to corner 568/569 : Elm 12. S. 71. W. 8 1/2
 " S. 300 :- W. 504 :- corner. 569/570 :- Pec. 10. N. 9 :- Stump Pec. 40 inch for other bearings
 " S. 280 :- W. at 270 cross branch, at 500 Cor. 570/571 : Pec. N. 42. W. 5 1/2
 " S. 246 :- W 500 to corner 571/572 :- Elm 10. N. 7. E. 4
 " S. 440 :- W (at 390 cross branch) 500 : N. 126 to Cor. 572/573 both bearings
 " W. 500 :- N. 1619 to N.W. Cor. 573 :- Elm. 10. N. 25. E. 5.

Commence again at Cor. of 142/143.

Thence. S. 468 :- W. 528 to Cor of 600/601. on N. side river: both bearings

North Side of River.

Commence again at Cor. of 596/597 both bearings standing

Thence W (at 72 varas County line) 1020 :- S 380 to river for corner 594/595.

" W. 509 :- S. 460 to river for corner 593/594

" N. 250 :- W. 479 to corner 592/593 :- Pecan N. 32 W. 7 :- Pecan N. 16. W. 6 : this corner is 62 varas. N. 95 varas E. of Cor. 550/554. on S. side of River

Thence N. 1630 :- W. 469 :- S. 65. to River for corner 591/592

Thence N. 60 :- W. 469 :- S 152. to corner. 590/591: Pecan. 18. S. 72. W. 10 :- This corner is 101 varas N of the Cor. 555/556 on South side of River.

Thence N. 245 :- W. 1069 to River Cor. 588/589 :- Large Elm marked on S.W. side, on bank of river, which would place corner in river. This corner to the place of beginning is 109 varas

Bearings marked _____

Surveyed _____ 188 _____

CHAIN CARRIERS.

I, _____, County Surveyor of _____ County, Texas, do hereby certify that the foregoing described Survey was actually made by me on the ground, according to law, on the date and with the Chain Carriers aforesaid, duly qualified, and that all the Corners, Lines, Boundaries and Marks of the same, whether natural or artificial, are truly and correctly described and set forth in the foregoing Plat and Field Notes.

By _____ Deputy. _____ County Surveyor. _____ County, Texas.

Filed for Record the _____ day of _____ 188 _____, at _____ o'clock _____ M.

Surveyor.

Eden
Concho Co Texas

STATE OF TEXAS,

Survey No. _____

County. _____

Recd Oct 28/98.

Oct. 22nd 98

NOTES of a Survey of _____

ACK'D 11/29/98.

Hon. A. J. Baker.

Com. G. L. O. Austin Texas

D^r Sir.

Herewith send field notes & sketch

of connections made by myself in 1895

of the G. E. Co. surveys on the Concho

River. same have been approved by

H. B. Farver & surveyor. Tom Green

& Mc Louis Range of Galveston for

whom I made the survey, wishes it

put on record in Land Office; please

let me know charges for filing

recording & c & c.

Yours sincerely

H. M. Gardner

Acknowledge receipt of field notes and sketch, and tell him they have been filed with Concho County sketch files, no. 18. & please return them to _____

Counter 19140

Bound

I, H. M. Gardner do certify that the foregoing described survey of the G. E. Co's surveys was made by me on the ground, with the chain carriers herein mentioned, and that all the corners mentioned with bearings were identified by me on the ground, that all distances mentioned were actually measured on the ground, and that wherever a shortage occurred in the E & W measurement, or any discrepancy whatever found, in the measurements, compared with original field notes, the measurements were taken twice, & that they are all truly & correctly described & set forth in the accompanying Plat. H. M. Gardner

to the place of beginning.

Bearings marked _____

Abner Harris

CHAIN CARRIERS.

Surveyed _____

May 25th to June 7th 1898

Pape

I, _____

H. B. Farver

County Surveyor of _____

Tom Green

County, Texas, do hereby

certify that the foregoing described Survey was actually made by me on the ground, according to law, on the date and with the Chain Carriers aforesaid, duly qualified, and that all the Corners, Lines, Boundaries and Marks of the same, whether natural or artificial, are truly and correctly described and set forth in the foregoing Plat and Field Notes. That I have examined the above and foregoing field notes of survey and find them correct, and do hereby approve the same.

By _____

Deputy.

County Surveyor _____

Tom Green

County, Texas.

Filed for Record the _____

5th day of October

1898, at _____

9 o'clock

A. M. and recorded in Book E

pages 316, 317, 318 and 319

H. B. Farver

County Surveyor.

T. G. Lee Texas

Counter 19141

STATE OF TEXAS,

Survey No. _____

County. _____

FIELD NOTES of a Survey of _____

Land made for _____

Said Survey is No. _____ in _____ County, Texas,

situated on the waters of _____, a tributary

of _____ River, about _____

miles _____ of _____

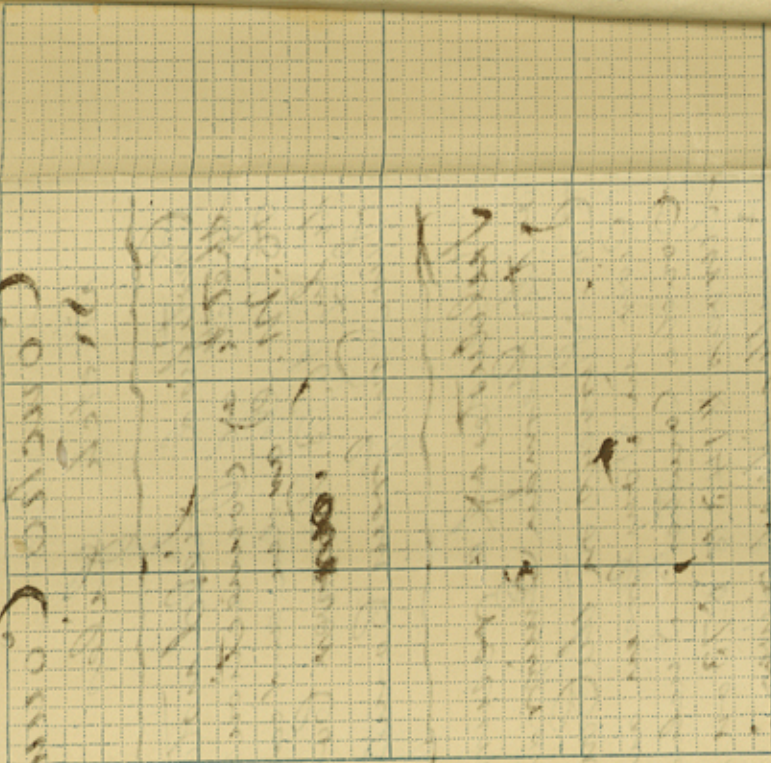

SCALE _____ VARAS PER INCH.

VARIATION _____

Beginning at North & 74 varas W of Cor 557/558 on South side of River
Thence N. 460 :- W 990 to river at point 569 varas N & 1060 W of Cor. 557/558
" N. 1444 :- W. 500 :- S. 280 to River
" N. 280 :- W. 500 :- S. 620 to River at point 98 varas N of Cor. 561/562

Commence at Corner. 358/359, both bearings standing on N. side river :- this
Corner is 5 varas W of ^{Cor} 571/572
Thence N 1305 :- W. 1024 to river for Corner of 356/357, which point is
98 varas N & E.W of NW Corner 573
Thence N. 500 :- W 500 :- S. 125 to river for Corner 355/356.
" N. 125 :- W 500 :- S. 135. to river for Corner SW of 355.

J. W. M. Gardner do certify that the foregoing described ^{re} survey of the G. E. Co's
survey was made by me on the ground, with the chain carriers herein
mentioned, and that all the corners mentioned with bearings were identified
by me on the ground, that all distances mentioned were actually measured ^{on the ground}, & that
wherever a shortage occurred in the E & W measurement, or any discrepancy
whatever found, in the measurements, compared with original field notes, the
measurements were taken twice, & that they are all truly & correctly described
& set forth in the accompanying Plat. H. M. Gardner

to the place of beginning.

Bearings marked 7

Abner Harris

CHAIN CARRIERS.

Surveyed May 25th to June 7th 1895

Pape

I, H. B. Tarver, County Surveyor of Tom Green County, Texas, do hereby
certify that the foregoing described Survey was actually made by me on the ground, according to law, on the date and with the Chain Carriers aforesaid,
duly qualified, and that all the Corners, Lines, Boundaries and Marks of the same, whether natural or artificial, are truly and correctly described and set
forth in the foregoing Plat and Field Notes. That I have examined the above and original field notes
of recurring and find them correct. And do hereby approve the same H. B. Tarver
By _____ Deputy. County Surveyor Tom Green County, Texas.

Filed for Record the 5th day of October 1898, at 9 o'clock A. M. and recorded in Book E

pages 316, 317, 318 and 319

H. B. Tarver County Surveyor.

T. G. Lee Texas

Sketch File 18.
Concho County
Sketch files

Certified field notes and
sketch of connections by
H. M. Garden and certified
to by H. B. ~~Towner~~ County
Sur. Tom Green County.

Field notes of a resurvey
of the German Emigration
Cos. Surveys on the Concho
River in Tom Green and
Concho Counties; Including
surveys # 143 to 573 on the
South side of river; nos.
596 to 585; - 358 to 355 on
the North side of river.

Filed in the Geol. Land Office
October 28th 1898.

Audun Bakv
Commissioner

See sketch filed
with this

See old map.
Beasar Dist. Filed
Sept 20/56.

D. van Rosenberg

Sketch File 18
 Concho County
 24. for files -
 The field notes
 filed with this
 Book is 1895

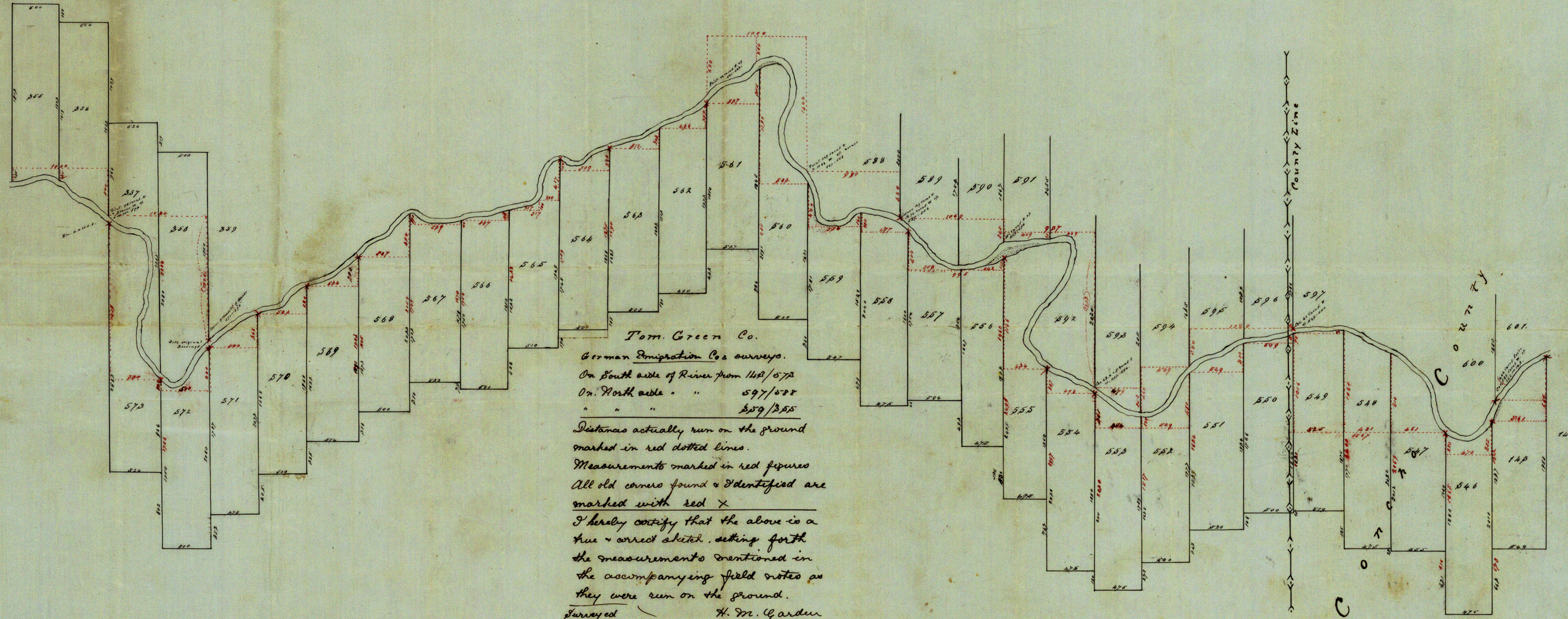

See sketch in D. 2603
 See letter to Yorkill
 7/3/02

J. H. Jarver County Surveyor in and for Tom Green County
 do hereby certify that I have examined the above sketch
 of a portion of surveys in Tom Green County, also attached
 field notes and find the same correct, and hereby
 approve the same this 5th day of October 1898
 J. H. Jarver
 Co. Sec. Tom Green Co.

Filed in the Gen. Land Office
 October 28th 1898.

Samuel Johns
 Commissioner

Sketch File 18
 Concho County
 Sketch file