

I, M. Peery District Surveyor of Cooke Land District do hereby certify that the above is a true and correct sketch of the surveys as represented on record in this office.

M. Peery Dist. Sur.  
 C. I. Peery  
 Counter 19223

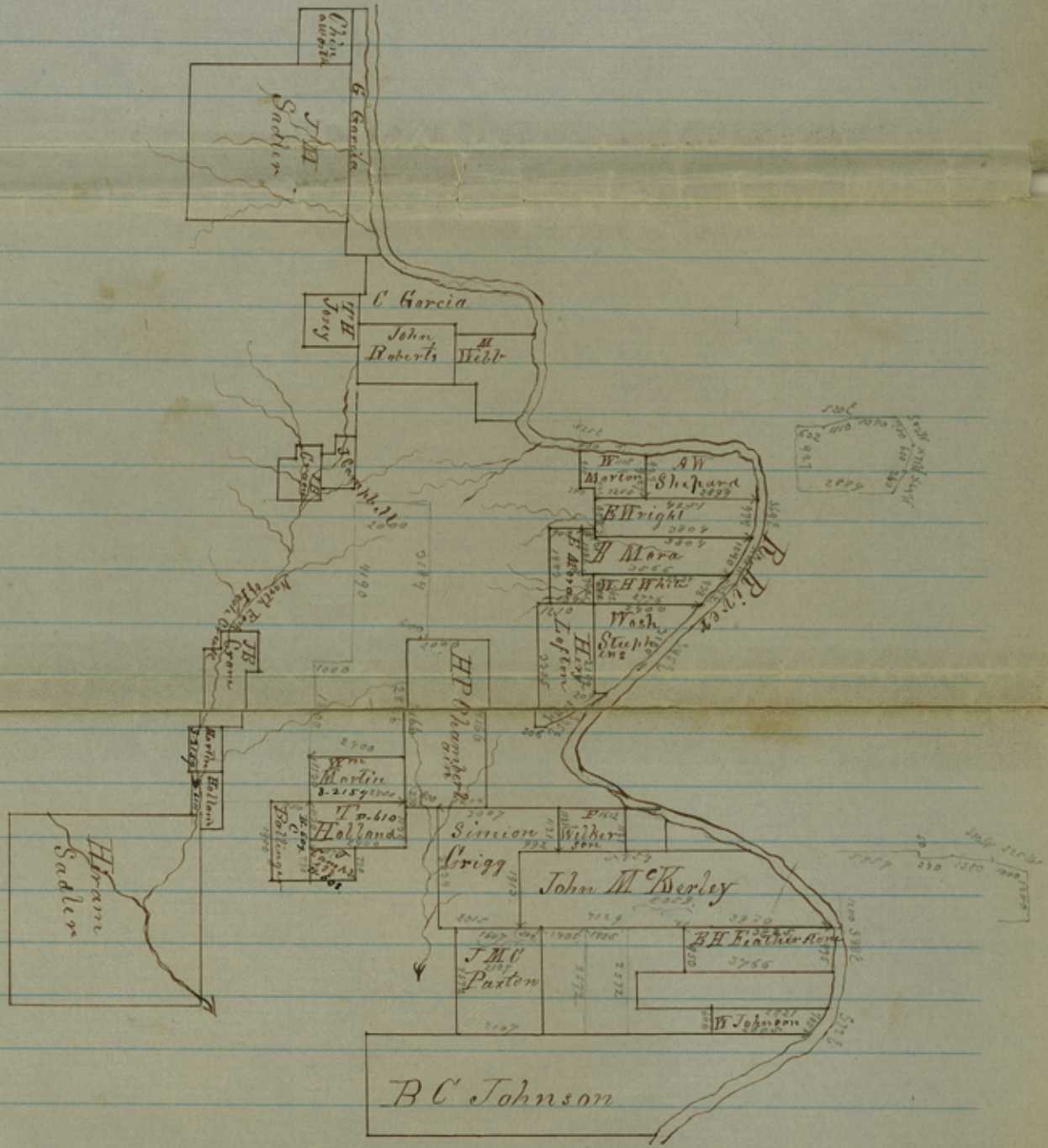

I Daniel Montague District Surveyor for  
 Cooke Land District do hereby certify that the  
 foregoing Sketch Map is a true and correct  
 representation of the surveys herein delineated  
 and on record in my Office

GIVEN under my hand at  
 Gainsville this 20<sup>th</sup> day of  
 January 1856 Daniel Montague  
 Dist Sur C. L. D.

File 4.

Certified Sketch  
on Red River  
& Fish Creek

Cooke County

On Red River near the N.W.  
Corner of the County.

Survey March 25<sup>th</sup> 1856

Plotted on Map.

W. Hudson

Courtesy 1925