



I George & Brill District Surveyor for
 Cook Land District do hereby certify that
 the above sketch is a correct sketch of
 twelve surveys made for the Buffalo,
 Bayou Brazos and Colorado R.R. Co.
 partly in Cook and Montrose Counties
 Guinsville Texas July 27th
 1861.
 Geo & Brill
 D. S. C. & D.

File #

Cooke Co.

Rec^d August 13th 1860

Cooke Co. St. File # 16, 17, 18

Counter 19453

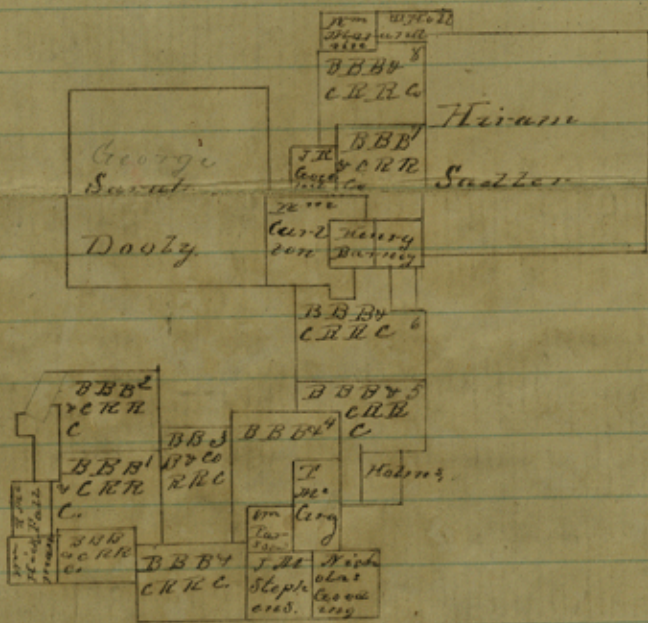

I Geo. Briel district Surveyor of
 Cook's Land District do hereby certify that
 the above is a correct sketch of six
 surveys made for the Buffalo, Tonawanda
 and Colorado Railroad, and
 are again in surveys
 Geinsville July 27th 1860.
 Geo. Briel
 D. S. & L.

File 16

Cooke County

Rec^d August 25th 1860

Sketch of
8 sections

Counten 19255

Cooke Co. St. File # 16, 17, 18

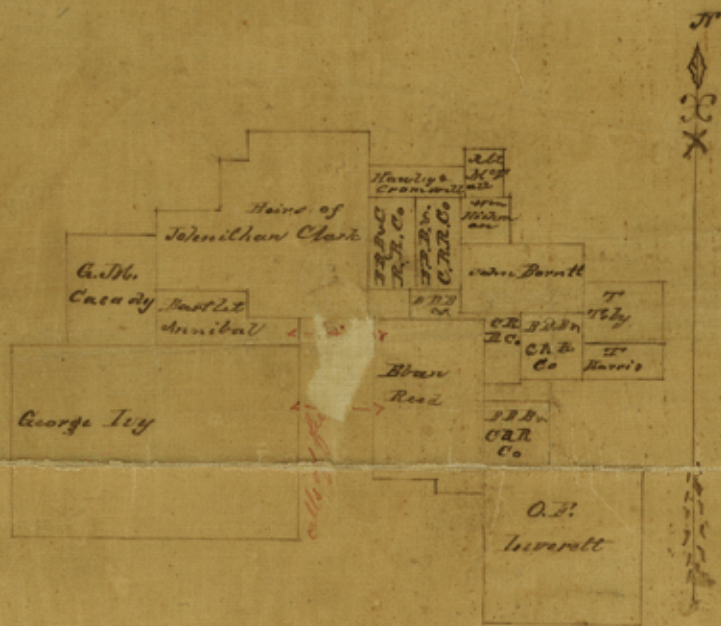

I Wm Cloud District Surveyor for
 Cooper Land District do hereby Certify
 that the above Sketch is a true and
 correct Representation of the Survey
 it contain as shown by the Record
 of this Office

Samusville November 12th
 1860

Wm. Cloud
 D. S. L. S. D.

Filed Nov 21/60 to sketch file 16-17-18.
 C. W. Proffers

File No. 17, 18.

Cooke Co.

Between Elm fork
and Fish Cr.

CONTENTS

No. 1-	_____
No. -	_____
No. -	_____
No. -	_____
No. -	_____
No. -	_____
No. -	_____
No. -	_____
No. -	_____
No. -	_____
No. -	_____
No. -	_____
No. -	_____

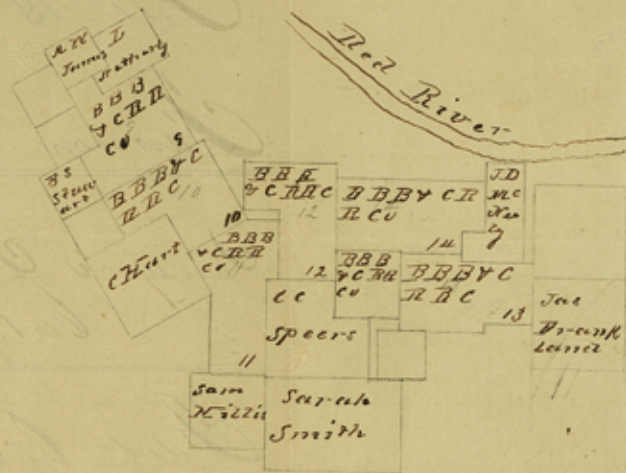

Geo. Y. Bird District Surveyor
 for Croke Land District do hereby
 Certify that the foregoing is a correct
 Sketch of Six Surveys made for
 the Buffalo Bayou Brazos and
 Colorado Rail Road Company
 No. 9, 10, 11, 12, 13, 14.

Gainesville August 25th
 1860.
 Geo. Y. Bird
 D. S. C. L. D.

File 18

James Scrip

Surveyor's Sketch and
Certificate.

Filed Oct 17th 1860

File 18

Cooke Co

October 7/60

Courtesy 19259