

Coyell County  
Rec'd Sept 26/59

File 4

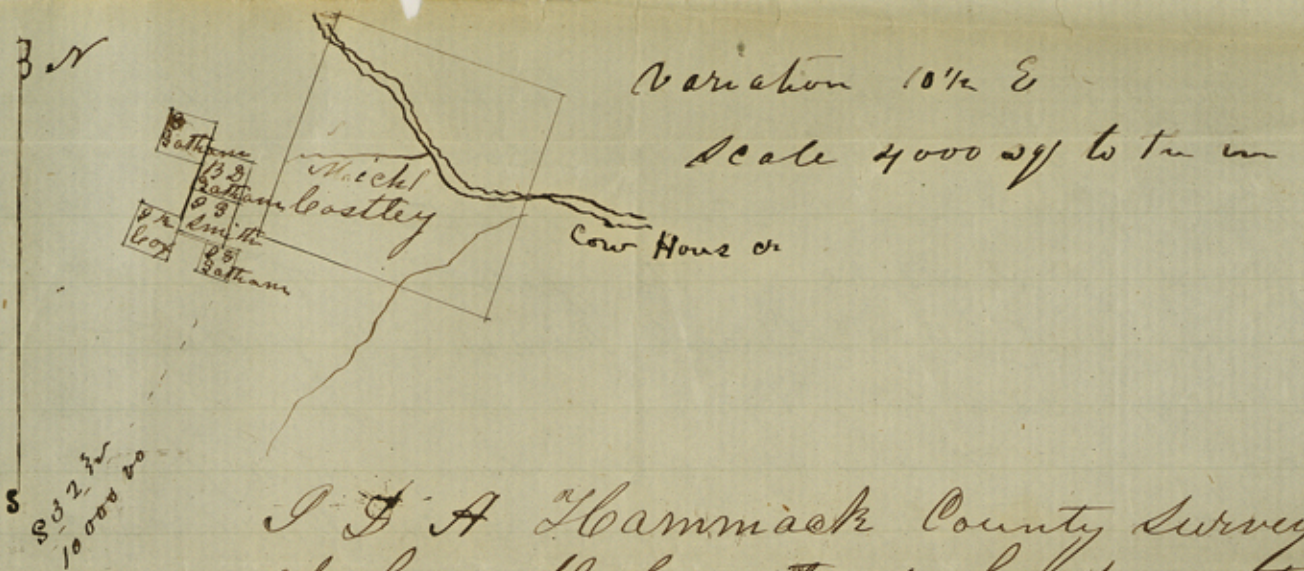

I J A Hammack County Surveyor  
 of Coyell County do hereby certify  
 the above is a true and correct  
 sketch as in office and that the  
 lot of Thomas was surveyed after the  
 Reservation was upon this section of  
 country and therefore is null and void  
 it is also the case with the I S Ewert  
 survey which the B D Satham covers  
 I hope this will be sufficient to put  
 out the I S Smith, B D Satham and  
 Joseph J. Levy's presumption surveys  
 Gatesville this 19<sup>th</sup> Sep 1859  
 I A Hammack  
 Surveyor of Co. do



Milam (3-1246)

(3-1408)

(3-1735)

(3-1788)

3-1746

Filed September 26/59.  
C. W. Pfeister.

J. J. Latham (3-1749)

Sarah Latham 3-1761

This sketch is of course so far  
 as the presumptions surveys are concerned. The field  
 notes being on file we can tell as well as the sur-  
 veyor where they were made - Their validity does  
 not depend upon the date of survey but the time  
 of settlement and the continuous residence. If  
 they have been abandoned, or if they were settled  
 counter 19350

Subsequent to date of the Resurvey they are  
void. This Certificate does not touch upon  
these facts. This Sketch cannot be re-  
garded as decisive of the position of the M<sup>r</sup>. P. Harde-  
man and R. Holmark Surveys. The field notes of Harde-  
man's Survey calls for "beginning at a pile of rocks 10100  
S. 32 W. from the S. W. corner of a Survey made for the Miss  
of John Costley" - supposed to be Mich<sup>l</sup>. Costley and  
so plotted and patented. - The map returned  
to this office by the Surveyor of Cassell (D. H.)  
changed the connecting line of Harde-  
man's Survey to 1100 and our map was changed accordingly.  
This Sketch shows the said line to be 1000  
suffering from both previous connections. We  
cannot change the position of the Harde-  
man Survey without a special certificate of the  
Surveyor giving the true position of the said  
Survey as found on the ground.

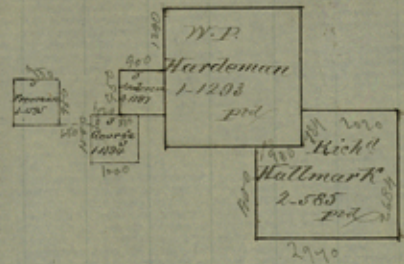
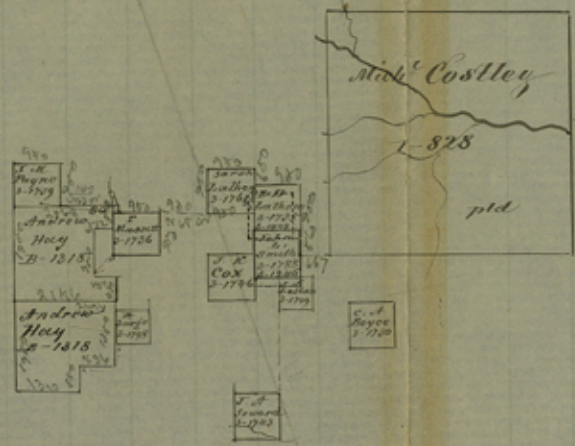

Counters 19349

22



I Sec of Adams county surveyor of Boyle county do hereby certify that the foregoing is a true and correct sketch as shown by actual measurement taken under my hand at Tabitha this 15<sup>th</sup> of July 1858

Sec. of Adams co  
Surveyor of Boyle

Received July 29/58  
C. W. Frosser

Coarter 19353

Subsequent to date of the Resurvey they are  
void. This Certificate does not touch upon  
these facts. This Sketch cannot be re-  
garded as decisive of the position of the W. P. Harde-  
man and R. Holmark surveys. The field notes of Harde-  
man's Survey calls for "beginning at a pile of rocks 1000<sup>ft</sup>  
S. 32 W. from the S. W. corner of a survey made for the Miss  
of John Costley" — supposed to be Michl. Costley and  
so plotted and patented. — The map returned  
to this office by the Surveyor of Carroll Dist.  
changed the connecting line of Harde-  
man's Survey to 1100 ft and our map was changed accordingly.  
This sketch shows the said line to be 1000<sup>ft</sup>  
differing from both previous connections. We  
cannot change the position of the Harde-  
man Survey without a special certificate of the  
Surveyor giving the true position of the said  
Survey as found on the ground.

File #

Cornell County

Recd. August 27<sup>th</sup> 1858

July

The Cornhouse Co.

Cornell 19354

Chas. H. De. 1936

1936

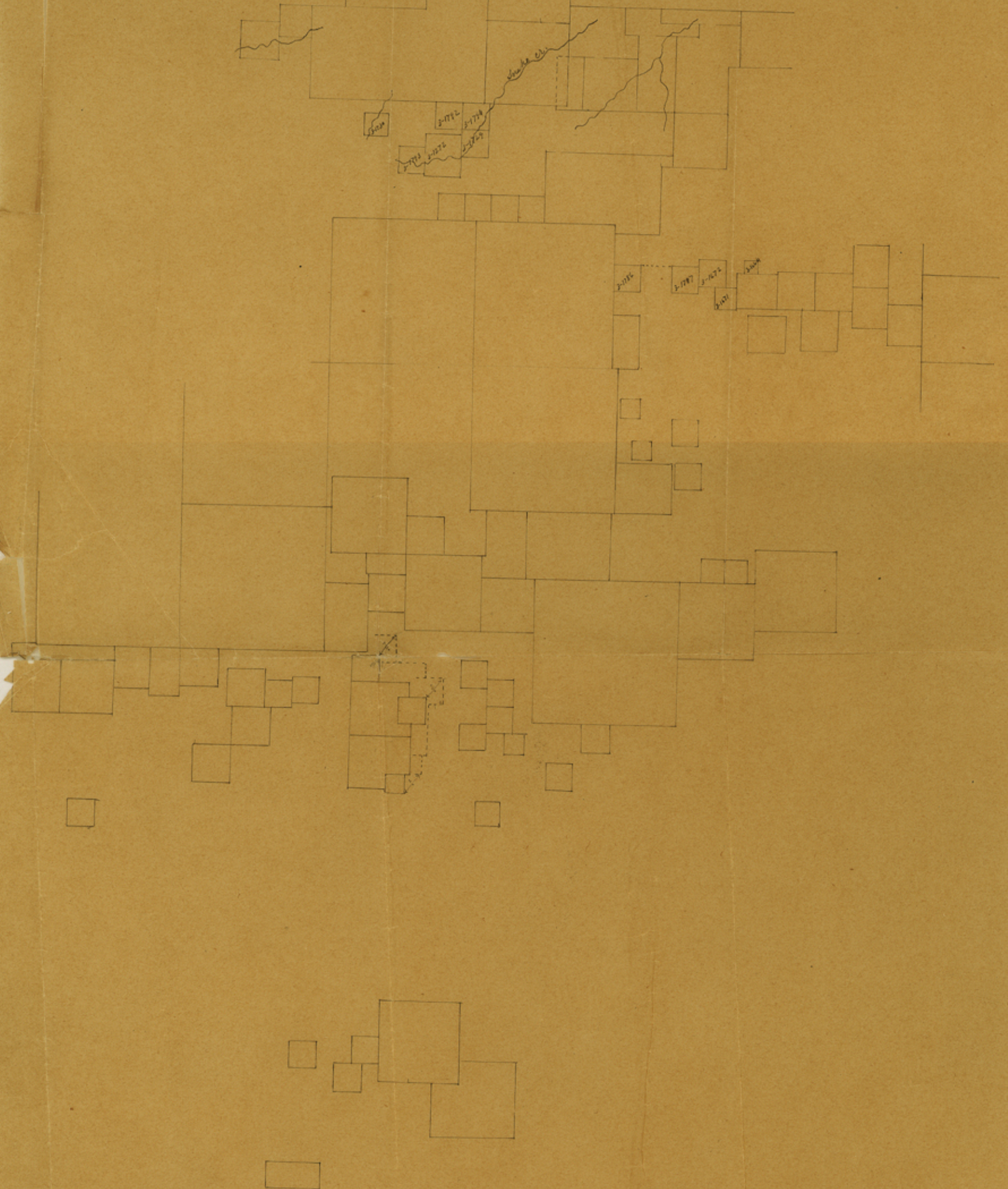

See sketch in gravel

July 16/61  
Chas. H. De.

Coates 1936

J. D. A Hammack, County surveyor of Conell  
County, do hereby Certify that I have examined,  
The Connection of the <sup>Survey</sup> ~~Line~~ ~~of~~  
and find it to be from the S.W. Corner  
of the Costly. League - 10.500 ft.

June 18<sup>th</sup> 1860.

J. D. A Hammack, Surveyor  
of Conell County,

of no use, being too indefinite.  
Hays



file 7. - Corryell co.  
Received Aug 15/60

of no use, being too  
indefinite.

Hays

Canter 19352

File 7,  
Coryell Co. Sketch Files.  
Surs. on Cowhouse Cr.  
Hammack, Surveyor, 9-19-59  
Filed. 9-26-59.

Counter 19355