

Sketch N^o 21

Crockett County

Connection line run from
West corner of Survey N^o 17
corner of Washington C. R. R.
on South side in Crockett
to the N. W. corner of survey
N^o 538 in name of P. Reiman
at Fort Barrett.

Surveyed by Will H. Bunch
Super. Van. Roads

Filed in the Land
Office for the
Hadden & Bro.

100% COTTON FIBER
DID YOU TREE

100% COTTON FIBER
DID YOU TREE
BOND

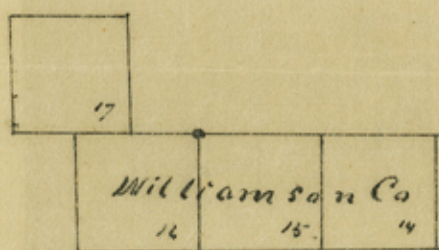

Scale 2000 yards = 1 inch
 Var. $9^{\circ} 45' \text{ East}$



Counter 19683

Three Ranged L.O. on Divide.

Scale 4000 yards per inch
 Var. $9^{\circ} 45' \text{ East}$

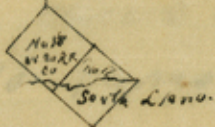

Counter 19684

" " Near 1900 " Star
 mound in Cray of McHenry's hollow
 of South Linn.
 Mound North 1900 Star mound

Counter 19685

NO 537
A. Blinnell
NO 538
* Fort Terrell.

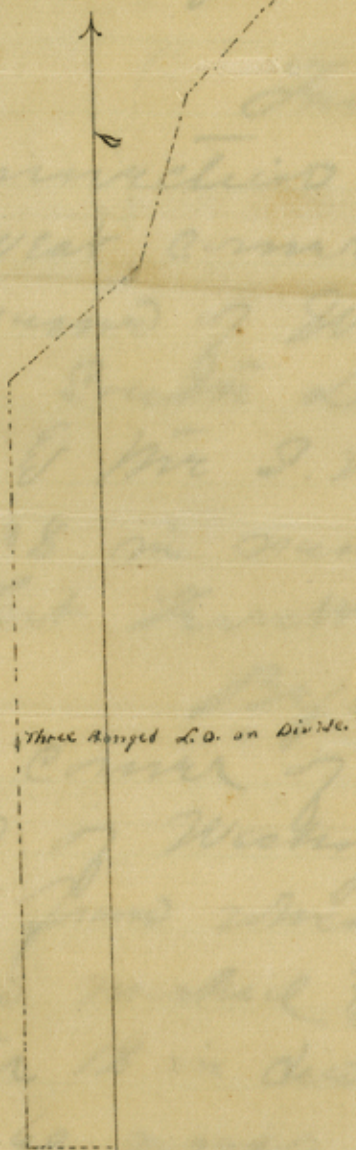

Scale 4000 yards per inch
Dir. 9° 45' East.

Counter 19684

" 1900 " Star
found in Cray of McHenry hollow
of South Leno.
" 1900 Star found

Counter 19685

State of Texas.
District of Bexar

Field Notes of
a connection line run from
the West corner of Survey No 17
in name of Washington Co RR
Co on South Land in Crockett
County to the S.W. corner of Survey
No 538 in name of P. Hamilton
at Fort Worth land county.

Beginning at the
West corner of Survey No 17 in
name of Washington Co RR Co
a line ^{run} from which a Live Oak 12
in dia marked \bar{x} bears S 9° E 64 rods
Another 18 in dia marked \bar{x} bears
S 12° E 60 rods.

1. Thence N 45° E 1344 rods Stone
mark. Live Oak 11 in dia bears
S 65° E 70 rods. Another 11 in dia bears
S 58° E 72 rods. North corner of
Survey No 17.

2. Thence N 45° W 1344 rods Stone mark

3. " North 2920 rods Stone mark

4. " West 1900 " Stone mark

mark in Cray of McKezies hollow
of South Land.

5. Thence North 1900 Stone mark

on high Plain no trees within half a mile.

6 Turned North crossing Prange of McManis hollow. @ 5080 a Live Quercus live oak 18 in dia marked \bar{x} in line. @ 8400 head of hollow on North Lane side of divide.

7 Turned North 7520 marked mound on head of hollow that runs 15 N.E.

8 Turned N 50 E 3732 vases a Point on mountain.

9 Turned N 17 E going down hollow 3600 vases to E Stone mound

10 Turned N 44 E 2480 vases, Point

11 " N 41 1/2 E 2000 " "

12 " N 47 E 1000 vases Point on side of mountain above Fort Lowell.

13 Turned N 49 1/2 ¹⁷⁸⁰ E Crossing North Lane to a Point.

14 Turned N 23 3/4 W 162 vases to a Stone mound on side of hollow. Cedar 10 in dia brs S 88 E 43 vases. A Live Oak 17 in dia brs S 71 1/2 E 71 vases. The S.W. cor of Sur No 538 on mound of

P. Roman & Survey upon which
Fort Turner is situated.

Therefore making it evident
from the above connection that
the S.W. cor. of Survey No 338
is ³³⁷ 31850 varas North ^{70 73} & 7145
varas East of the West corner
of Survey No 17 Washington Co RR
Co on South Land.

I Will W. Burnell Dep. Sur
Gen. Dis. do hereby certify that the
above connection was made
according to Law. & that the
distances & marks natural &
artificial are truly described
in foregoing Plat & Field Notes
from a Survey made by me
upon the ground.

Will W. Burnell
Dep. Sur. Gen. Dis.

Surveyed Dec. 15th 16th & 17th. 1880.

James Brunson.
H. Nolan.
Chairman

* See Sketch File 21
for correction.
Filed July 17/82

I W. M. Lockwood Dist. Sur. Gen.
District Do hereby Certify That
I have examined the foregoing
Plat & Field Notes & found them
Correct & that they are recorded
in my office in Book D 17010
on pages 485 & 486.

Given under my hand at
San Antonio this 24th day of August
1881.

W. M. Lockwood,
District Sur. Gen.

N. 21.

W. M. LOCKE

BEXAR DISTRICT
COMPRISES THE FOLLOWING
COUNTIES

- BEXAR
- CROCKETT
- ZAVALLA
- DIMITT
- MAVERICK
- EDWARDS



St. Louis, Mo., Feb. 1889

1889

Dear Mr. C. Walsh.

Dear Gen. L. O. Austin Esq.

Dear Sir,

In the field notes of the connecting line from the W. cor of sur A to 17 Washington Co. Ry Co. to the S. W. cor sur A to 538 in name of O. Remman sur upon which Ft Bennett is situated, you will please make the following correction to agree with the records in this office.

In the recapitulation it should read:

Thus making it evident from the above connection that the S. W. cor of sur A to 538 is 33750 or S. of the W. cor of sur A to 17. W. Co. Ry. Co. instead of reading S. 31550 as in the original H. C.

W. M. Locke
D. S. B.

Sketch Title 21.
Crickett, C^o.

Correction of
connecting - Lind.

Filed July 17/82.