

Field Notes of a survey to determine
the positions of surveys 30 and 30 Block
28 of and G. N. R. R. Co. surveys Crosby Co
Texas

(A) Originally surveyed 1873 at Declination of $10^{\circ}45'$ E.
Beginning at a rock monument the N.W. corner
sy 141 of 2nd G. N. R. R. Co. surveys Block 2.
Thence East at 620 yards cross White River
continuing East 1900. yards to N.W. corner 140
Block 9. Thence E. 1900. yards to the N.E.
cor. sy 140 Block 9. in full. Thence North 1900.
yards to the N.E. corner sy 144 Block 9. and
N.W. corner sy 3. of and G. N. R. R. Co. sy 3
Block 28

(B) Variation originally 12° E.
Beginning at N.W. corner sy 3 aforesaid
Thence North 1900 yards to N.E. corner
sy 4 Block 28. Thence North 1900. yds.
to N.E. corner sy 13. Block 28. Thence
North 1900. yds. to N.E. corner sy 19 and
S.E. corner sy 30, a pile of rocks near foot
of plain. Thence West 1900. yds. to N.W. corner
sy 30, a pile of rocks on mesquite flat
Thence North 1900. yards to N.W. corner sy
30 aforesaid a pile of rocks on North
side of drain near cottonwood wood.
Thence E. at about 1500 yds edge of plain
continuing E. 1900. yds a stake in plain
N.E. corner sy 30. Thence S of plain 1900.
counter 20011

5700
 1147
 6847

ward to S.E. corner by 30 paces, a pile
 of rocks near foot of plained

I R. P. Smyth, Dep. Sup. Crosby
 Land District do hereby certify that the
 foregoing survey was made on the ground
 according to law and that the marked
 natural and artificial are truly described
 herein, and that said survey is H.
 and G. M. R. P. L. Dec. 28 does not
 contain on front upon any water

R. P. Smyth

I H. C. Knight, Dist. Surveyor, Crosby Land Dist.
 do hereby certify that I have examined the foregoing
 plot and field notes and find them correct and
 that they are recorded in my office, in book 2
 page 476

Aug 27th 1887

H. C. Knight

Dist. Surveyor Crosby Ld Dist

C)

Beginning at N.W. corner sy 30. Hand G. N. R. I. Co. survey Block 28, a pile of rocks on North side of draw near Catfords mill (which said corner was established from M.M. Co. 141 Bk 2 see field notes designated (A) and (B) sheets attached)

Thence West 1900.0' to M.M. Co. 29. Bk 28. Thence West 3800.0' to M.M. corner sy 27 Bk 28.

Thence North at 6847 varied stakes cap rock of plain, containing North in all 11400 (varied) to S.M. corner sy 30 Bk 28. in plain. Thence North 1900.0' to M.M. corner sy 30. Thence East 1900.0' varied to S. E. Co. sy 30. Bk 28. Thence Smith 1900.0' to S. E. corner sy 30.

Thence West 1900.0' to M.M. corner 30 Hand G. N. R. I. Co. Bk 28. (Catfish Co. on White River to Medwood dist 2 miles

I R. J. Smyth Dept. of Crosby Land Dist. do hereby certify that the foregoing survey was made on the ground according to law, and that the marks natural and

artificial as truly described herein, and
that said survey so H & M R.R. Co. Blk
28 does not contain or front upon any
water

R. B. Smyth

I, H. C. Knight, Surveyor Crosby Land Dist, hereby certify
that I have examined the foregoing plat and field-
notes, and find them correct, and that they are re-
corded in my office in Book 2, page 477.

Aug 27th 1887.

H. C. Knight
Dist. Surveyor, Crosby Land Dist.

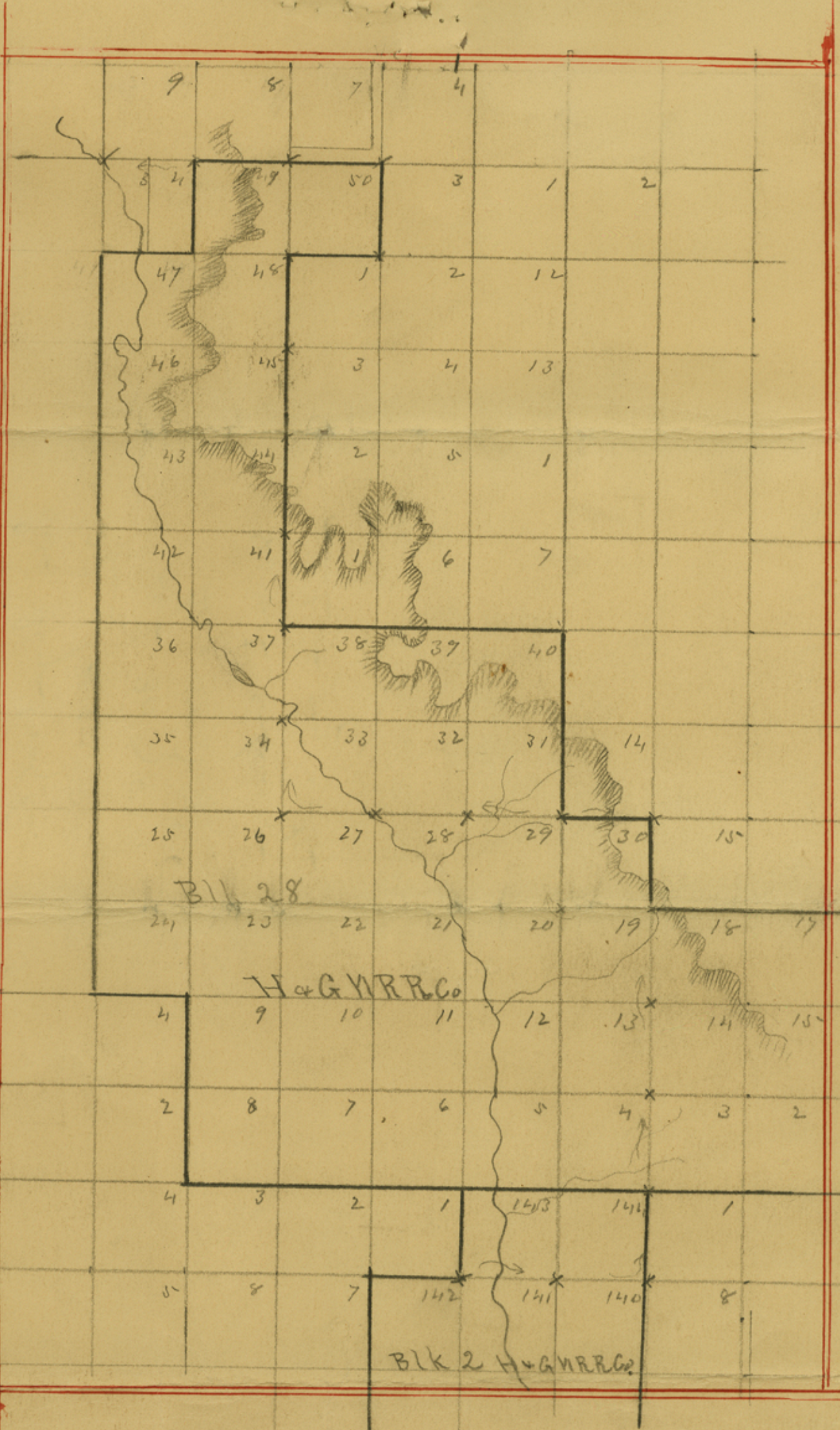

ET

File: 10.
Crosley Co
Report & Sketch

from
Deft. Morgan County Co.

Showing that
Sec. 30 } H. & G.
Sec. 50 } N. R. B.
 } Any.

do not contain an
front on any water

Filed in the General Land Office
Octob. 5th 1887.

R. Shively
Chief Clerk.

See State Surveyors report
p. 11.

W. R. Johns & Son.

15981
16152
17228

Counter 20016

53