

W. D. TWICHELL
 AMARILLO, TEXAS

Amarillo, Texas,

11 3rd, 1911

Dear Sir:

After you have agreed upon the boundaries which you wish to locate, I will request Hon. J. T. Robison to authorize me to do the work as State Surveyor, and I will go upon the ground as soon as my work will permit, to locate all the lines which have been agreed upon by all the adjacent owners. If a considerable number of land owners, holding land in a solid body, should sign the attached agreement, Mr. J. T. Robison will probably instruct the work to be done officially.

Yours truly,
 W. D. Twichell.

THE STATE OF TEXAS }
 County of Crosby

We the undersigned, being the owners of the respective tracts of land indicated opposite our names on the following list attached hereto, for the purpose of permanently fixing the land boundaries in which we are jointly interested, do hereby employ W. D. Twichell, an experienced practical surveyor, to go upon the ground and mark the boundaries and corners of our land; and we singly and severally do hereby expressly agree that the boundaries so marked shall thereafter be the boundaries of our respective tracts of land, and each of us do hereby expressly bind ourselves to construct our improvements and yield possession in accordance, and to conform with, the land boundaries as so surveyed and marked by said W. D. Twichell; and we herewith deposit in the bank of _____, Texas, \$ _____ per section, same being the amount set opposite our respective names as a part of a general fund for surveying said lands, and we hereby instruct said bank to pay the money deposited, for surveying each tract, to W. D. Twichell when the four corners of that survey have been marked under his direction as state surveyor for the state of Texas, and we further agree to supply stone for making corners, to the surveying party when it reaches each corner of our respective tracts.

NAME	Amount Deposited	Survey to be Marked and Corrected Field Notes Returned	Block No.
<i>John Billipie</i>		<i>Abstract 1137 out 1187 sub 18</i>	
<i>ii ii</i>		<i>of J. Torrey Original Grants</i>	

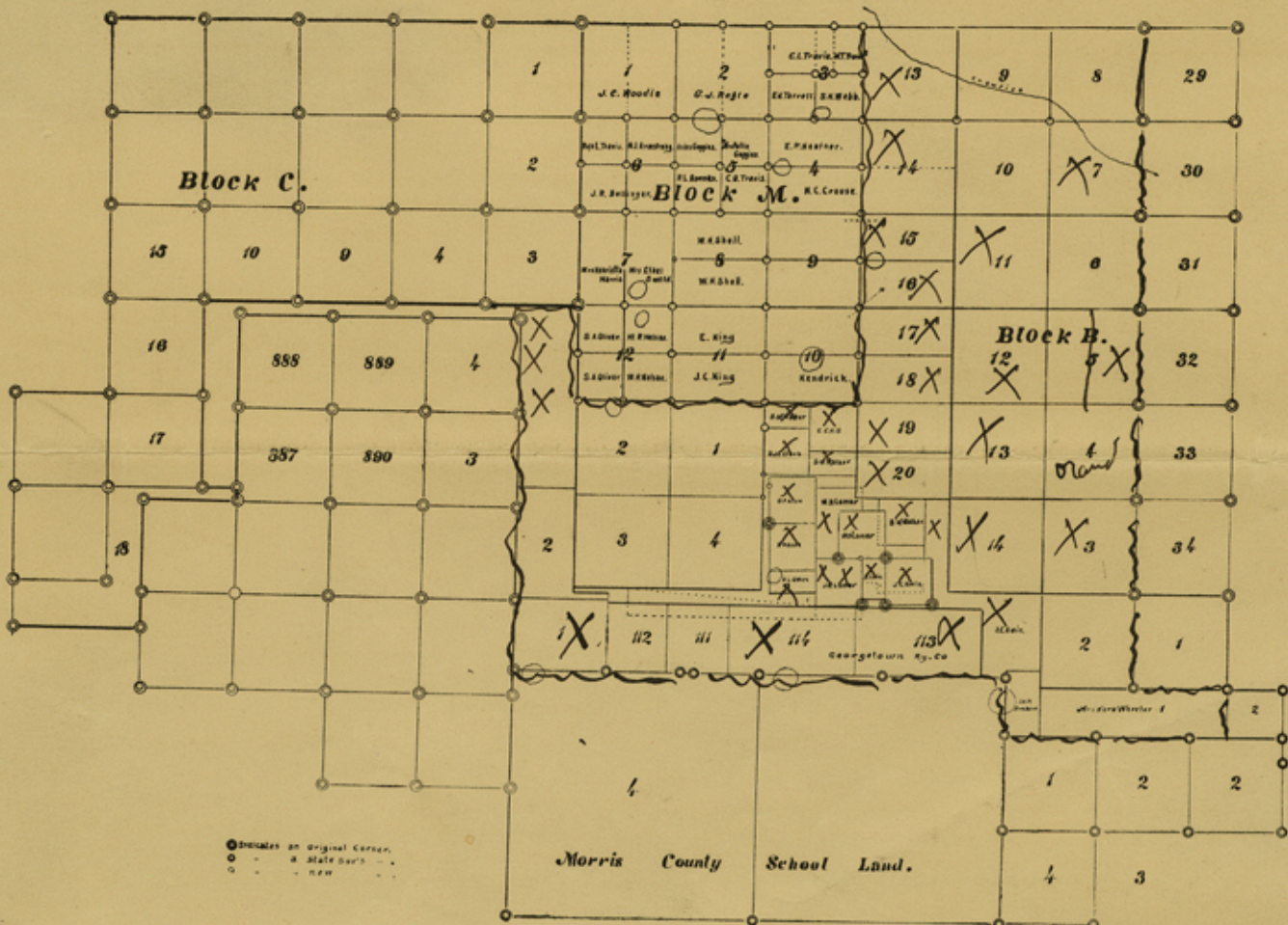

Counter 20087

Crosby Co. St. File # 25

W. D. TWICHELL
AMARILLO, TEXAS

Apr

Amarillo, Texas,

Dear Sir:

After you have agreed upon the boundaries which you wish to locate, I will request Hon. J. T. Robison to authorize me to do the work as State Surveyor, and I will go upon the ground as soon as my work will permit, to locate all the lines which have been agreed upon by all the adjacent owners. If a considerable number of land owners, holding land in a solid body, should sign the attached agreement, Mr. J. T. Robison will probably instruct the work to be done officially.

Yours truly,

THE STATE OF TEXAS

County of *Crosby*

We the undersigned, being the owners of the respective tracts of land indicated opposite our names on the following list attached hereto, for the purpose of permanently fixing the land boundaries in which we are jointly interested, do hereby employ W. D. Twichell, an experienced practical surveyor, to go upon the ground and mark the boundaries and corners of our land; and we singly and severally do hereby expressly agree that the boundaries so marked shall thereafter be the boundaries of our respective tracts of land, and each of us do hereby expressly bind ourselves to construct our improvements and yield possession in accordance, and to conform with, the land boundaries as so surveyed and marked by said W. D. Twichell; and we herewith deposit in the bank of _____, Texas, \$ _____ per section, same being the amount set opposite our respective names as a part of a general fund for surveying said lands, and we hereby instruct said bank to pay the money deposited, for surveying each tract, to W. D. Twichell when the four corners of that survey have been marked under his direction as state surveyor for the state of Texas, and we further agree to supply stone for making corners, to the surveying party when it reaches each corner of our respective tracts.

NAME	Amount Deposited	Survey to be Marked and Corrected Field Notes Returned	Block No.
<i>Dora C. Stone</i>		<i>E. L. & R. R. Co #1</i>	
<i>" " "</i>		<i>Georgetown R.R. Co # 11 3</i>	<i>113</i>
<i>" " "</i>		<i>June 7 1911 B.S. & F.</i>	<i>B</i>
			<i>12</i>
			<i>13</i>
			<i>14</i>
			<i>15</i>
			<i>16</i>
			<i>17</i>
			<i>18</i>
			<i>19</i>
			<i>20</i>
			<i>21</i>
			<i>22</i>
			<i>23</i>
			<i>24</i>
			<i>25</i>
			<i>26</i>
			<i>27</i>
			<i>28</i>
			<i>29</i>
			<i>30</i>

~~19~~ #21
Crossby Co.
Sketch fill

4-3-1911