

# Crosby County

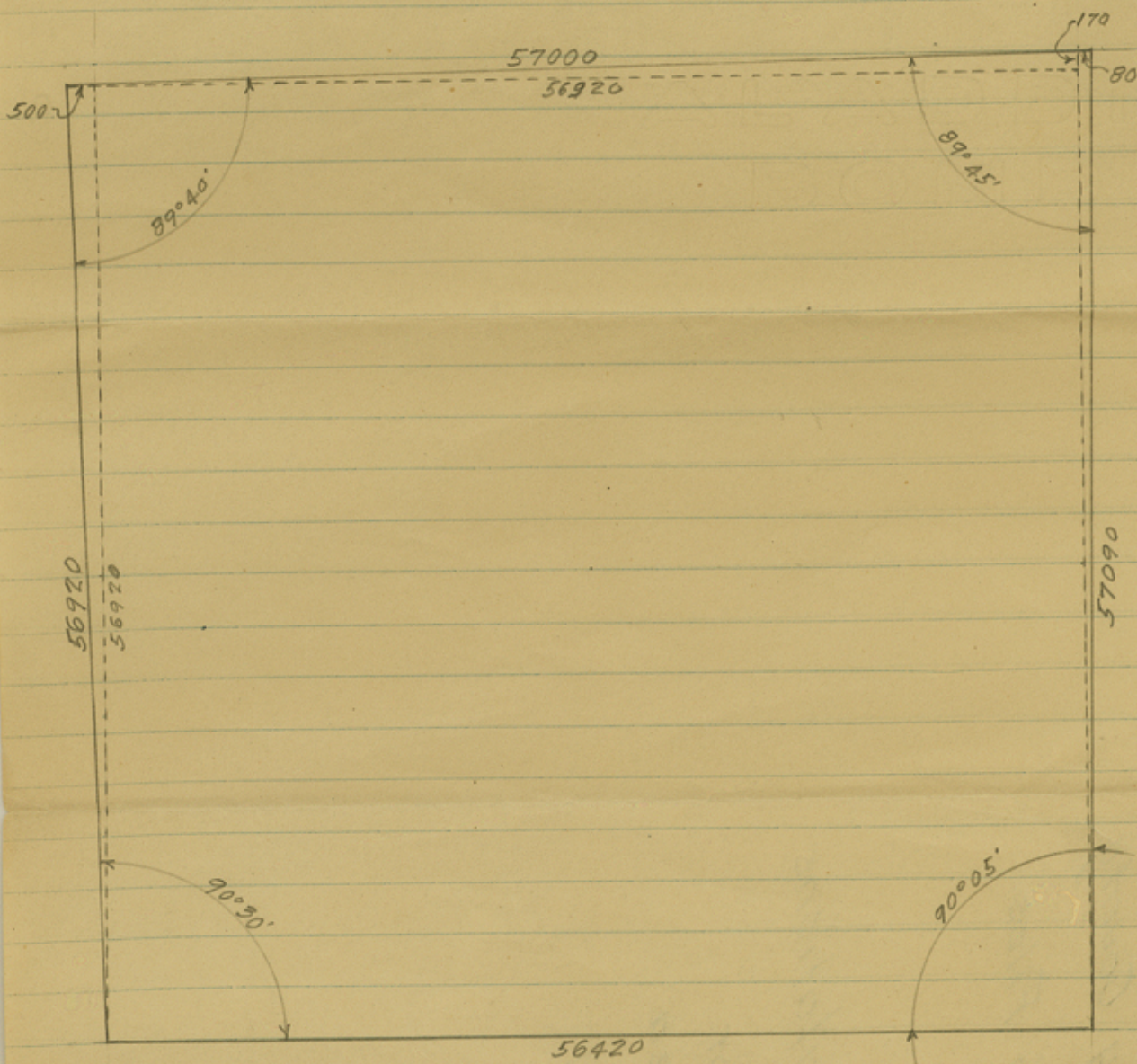

$$56420 \times 56920 = 3\,211\,426\,400$$

$$56920 \times 250 = 14\,230\,000$$

$$56920 \times 85 = 4\,838\,200$$

$$57090 \times 40 = 2\,283\,600$$

3,232,778,200 sq. vs.

572,639.35 Acres

894.75 sq. mi.

*J. Barron*  
2-15-35

# 30  
Crosby County  
Sketch Files

Calculations

for  
Area

✓