

6.

File 3.

Culberson Co.

El Paso Co.

Near El Paso del
Norte.

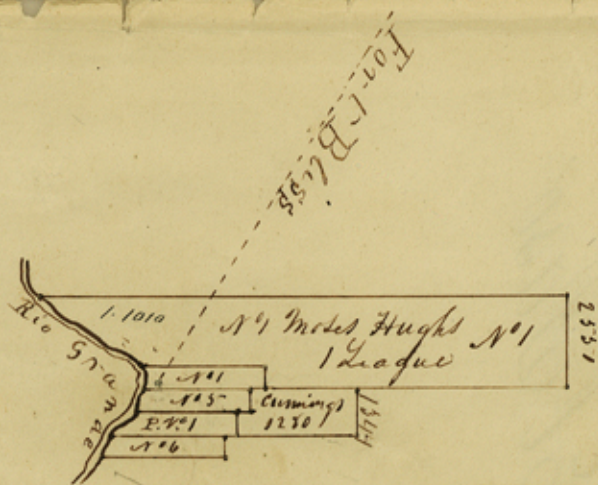

Scale 4000 feet to the inch
 Variation 11° 50' East

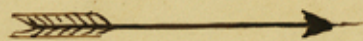

Cummings for F. B. Bliss

See Sketches 185 (Sketch of El Paso) File No 3

San Elizario
September 9th 1857

Agreeable to an order received from the United States Court by me I send you the following map and a description of the different surveys

N^o 1 is on the league survey made for Moses Hughes. It includes all the improvements at Fort Bliss and was surveyed for James W. Magoffin

N^o 5 commences on the Rio Grande at the lower corner of survey N^o 1 (League survey) or the upper corner of survey N^o 2 made for Jonathan W. Cummings by Robt. B. Hays in 1849, upon which is about 18 Tackals and one adobe house - about 125 acres irrigated and cultivated - survey made for James W. Magoffin.

N^o 1 is a Prescription Claim surveyed for Rufus Hoane, the lower line of the survey passing through his house and bearing about one fifth of it on survey N^o 6. On this survey is about fifteen Tackals and two adobe houses - about 150 acres irrigated and cultivated

N^o 6 was surveyed for Hugh Stephenson on which he resides and does not conflict with Jonathan W. Cummings' survey

Each of the above surveys contain
Coun. 2014

El Paso Co.
Sketch File

Callington Co

4

File 3

320 acres of Land

The only surveys that conflict with the survey made for Jonathan W. Cummings are ~~the~~ N^o 5 made for James W. Magoffin and N^o 1 Preemption Claim surveyed for Rufus Hoane

I Stevenson Archer District Surveyor of El Paso District do hereby certify that the foregoing surveys N^o 1- N^o 5- P. N^o 1 and N^o 6 were made according to Law and that the limits and boundaries and corners, with the marks natural and artificial are truly described in the foregoing Plat and that the above description thereof is correct

Given under my hand at San El Paso this 9th day of September 1857-

Stevenson Archer
District Surveyor of
El Paso District.

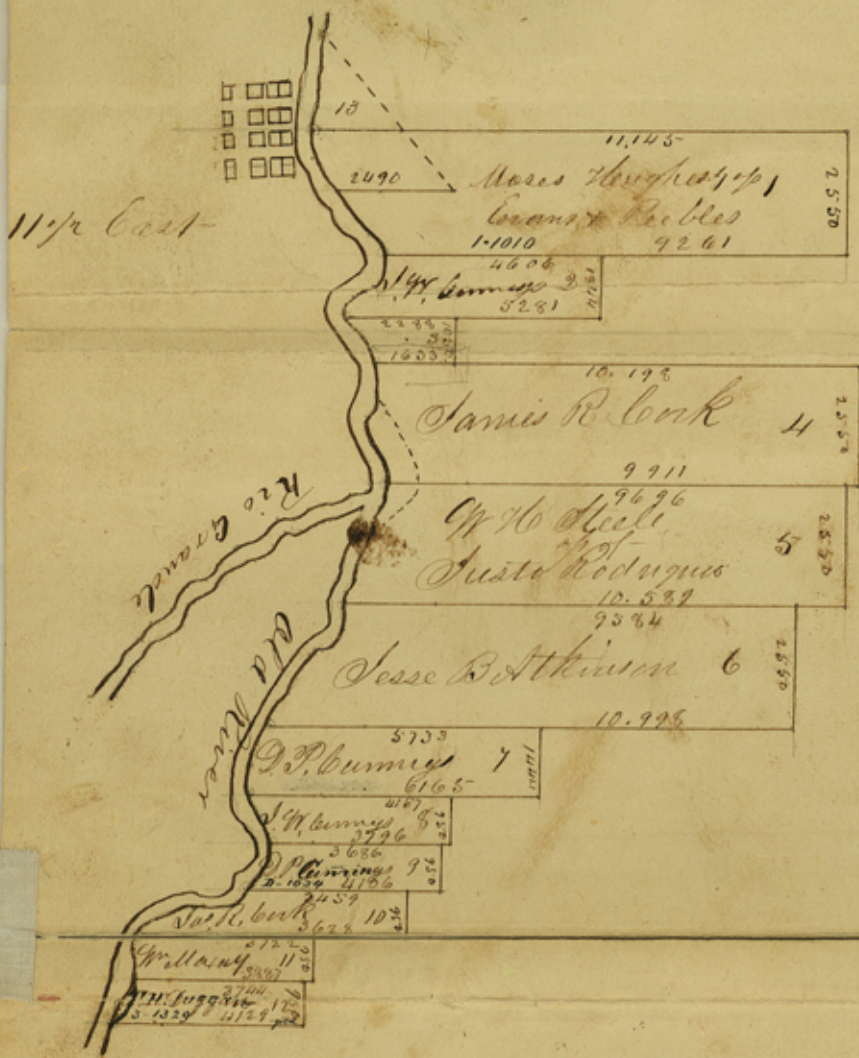

I hereby certify that the above
is a correct copy of a map returned
to this office by Robt B Hays
a Deputy Surveyor of Survey made
by him on the Rio Grande
for H. C. Fountain

San Antonio
Sept 25th 1831

J. H. Donald
District Surveyor Basin Dist

3

R B Aays Dep. Sur.

is

Hartty & Fountain
Culberson Co.

El Paso Co.

Maj of Anna Saroyca at El Paso

Filed in Draftsman Department, March 4th/55. Presler, but was received on an earlier date and rec'd with a letter.

See letter file 9593-4

S. von Rosenberg

counter 20117

129
BRACON
Cava. p. 937.

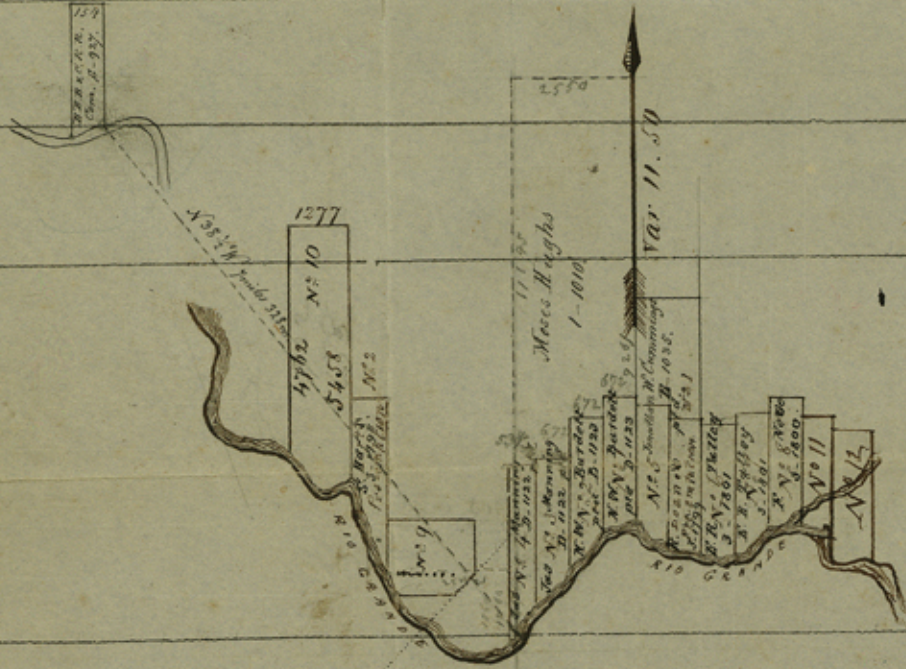

Scale 4000 ^{27.53 E} varas to the inch.

Counter 20118

Contents

- No. 1. Sketch 40000⁰⁰ per Inch.
- No. 2. Sketch by R. B. Hays D. S. B.
approved by J. S. McDonald
Dec. 3rd / 1849
filed by L. O. Dec. 1849
- No. 3. Sketch Cert. to Ley
J. S. McDonald
D. S. B. D.
San Antonio Sept 25/51.
- No. 4. Letter of explanation
accompanying Sketch 5.
below Letter & sketch
by J. Archer Dist.
S. El Paso Dist.
Sept. 9 / 57
- No. 5. Sketch. see Letter 4
- No. 6. Old Wrapper.

C. von Rosenberg
Draftsman

Sketch file 3.

El Paso Co.

Culberson Co.

Near El Paso del Norte

over for Contents

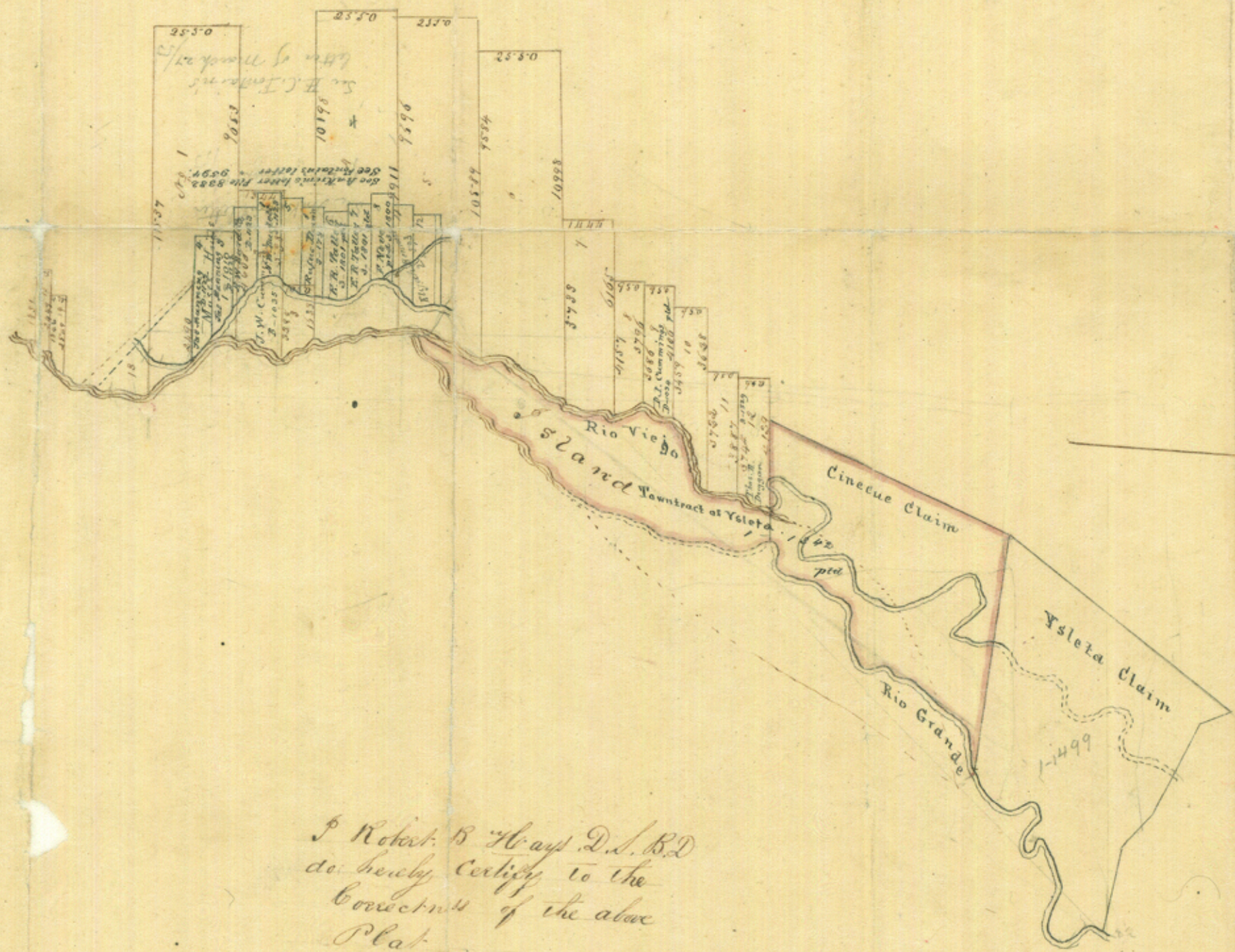

I Robert B. Hoop D.S. B.D
do hereby certify to the
correctness of the above
Plat
Robert B. Hoop D.S. B.D

I J. S. McDonald District Surveyor Biscoe
do hereby certify that the foregoing is a true
copy of a map returned to my office by R. B. Hoop
N.puty Surveyor
J. S. McDonald
District Surveyor Biscoe
Mexico 3rd 1849

Received in Genl. Land Office
Dec. 13 1849. C.

2

File 3

Culberson Co

El Paso Co.

Near Fort Bliss.