

SCHOOL LEAGUES

ADJACENT LANDS

Situated in
MARTIN AND DAVSON COUNTIES
TEXAS

ANDERSON WELLS CORNER 284
1500 FEET OF SOLID ROCK 150 FEET IN DIAMETER

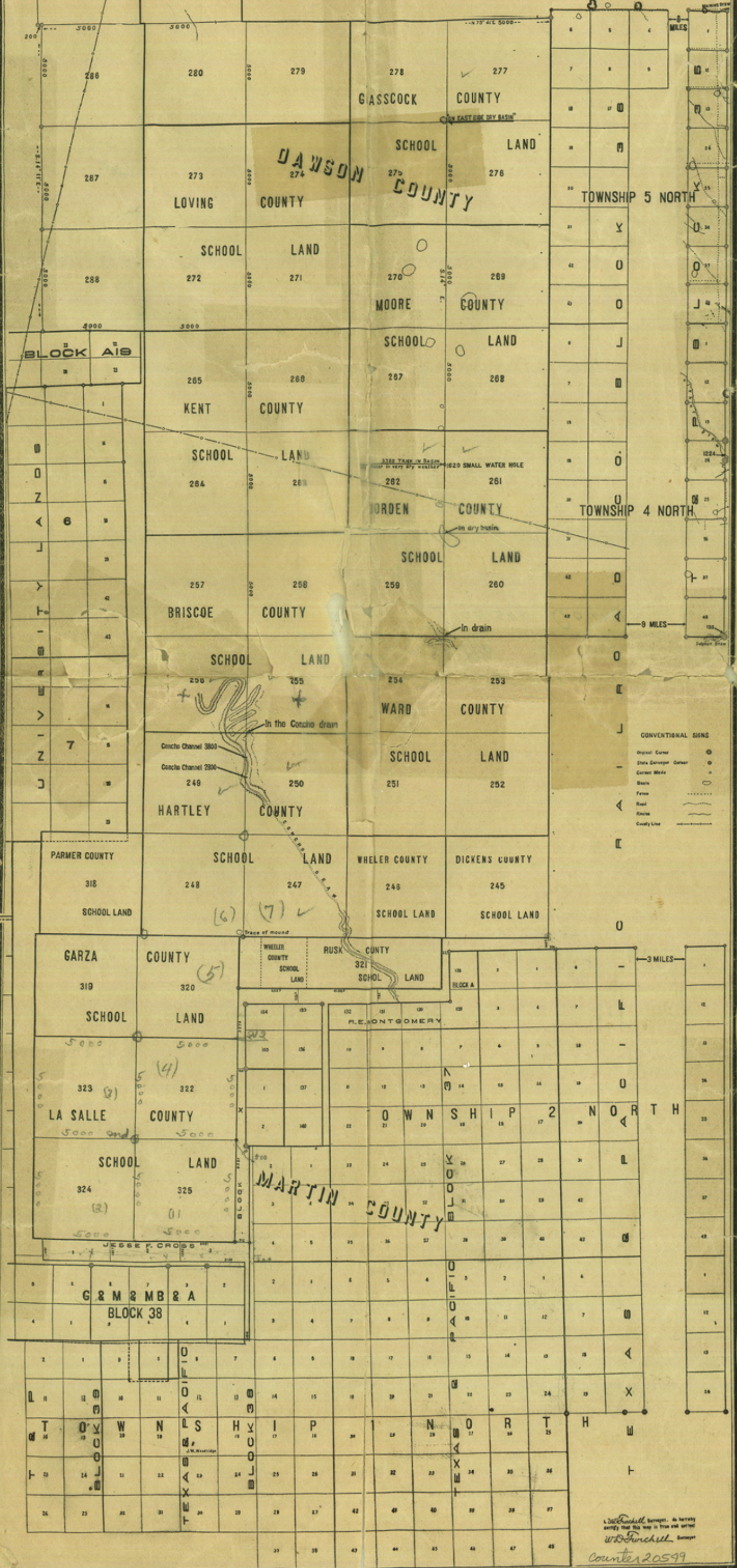

- CONVENTIONAL SIGNS
- Original Corner
 - State Surveyor's Corner
 - Corner Mark
 - Basin
 - Fence
 - Road
 - Railroad
 - County Line

W.D. Funchell, Surveyor, in hereby certify that this map is true and correct.
W.D. Funchell, Surveyor
Counter 20599

DAWSON
Box 2 NO 15

Sk. File # 15
Dawson County

Litho Map - School
Leagues of Martin + Dawson
Co's -
W. D. Swichell -