



General Land Office,

State of Texas.

Austin.

JOHN J. TERRELL, COMMISSIONER.
J. T. ROBISON, CHIEF CLERK.

June 22, 1906.

Capt. A. S. Howren,
Amarillo, Texas.

Dear Sir:-

Yours of the 19th inst together with sketch duly received. I appreciate the interest and time you have taken in straightening the differences of conflicts in surveys Nos. 5 to 20, Block A, made under the Act of Feb. 23, 1900 by Mr. G. R. Jowell, County Surveyor of Deaf Smith County, lying between Capitol leagues 374, 373, 367, 357 & 357-1/2 and South and West lines of block K 11 in the Northern portion of Deaf Smith County.

I have this day notified the County Surveyor of Deaf Smith County and Oldham County sending them blue print of your sketch and copy of letter of explanation instructing them to correct the several surveys accordingly. Please have the Surveyor of Oldham County send in a certificate correcting the distances and the area in the field notes of the Capitol league No. 357-1/2 so as to conform to the position of section 111, Block K 11 as established by Mr. Twitchell on the line of Oldham and Deaf Smith Counties.

Yours truly

Act'g. Commissioner.

E. von R-Guyer.

H. H. BARBEE, PRESIDENT
J. J. BURNS, VICE-PRES. & TRAFFIC MGR.

PROF. H. W. CAMPBELL
SOIL EXPERT—SUPT. MODEL FARMS

5-9-05
C. F. RICKEY, TREASURER
H. C. SHIMP, SECY. & MGR.

The Western Lands and Immigration Company

REPRESENTING
THE FARM LAND DEVELOPMENT CO., Chicago Ill.
AMARILLO, FARWELL, PERIGO and TEXTLINE
TOWNSITES

OFFICES
COLORADO SPRINGS, COLO.
AMARILLO, TEXAS

CHOICE LANDS ON MAIN RAILWAY LINES
WHOLESALE AND RETAIL
EASY TERMS TITLES PERFECT

Amarillo, Texas' 6-9-06.

Hon. John J. Terrell,
Austin, Texas.

Dear Sir:-

Referring to your letter of Dec. 21st, 1905 asking for an explanation of the nonagreement of my two sketches as to the distance from the most eastern line of Capitol league No. 357-1/2 and the west line of Blk. K II, G.C. & S.F. Ry. Co. in Oldham and Deaf Smith Counties, I will state that my first work on this survey was done in October, 1902 at which time I clearly identified all the original corners shown on my former sketches and the one hereto attached. From the stone monument at the N.W. corner of survey No. 103, Blk. K II, I measured east 3800 varas to a point for the N.E. corner of survey 104, same Blk.

Thence South 7600 varas to a point for the N.E. corner of survey 102, same Blk.
Thence West 1900 varas.
Thence South 3800 varas to a point for the S.W. corner of survey No. III, Blk. K II.

I then went to the N.E. corner of Capitol league 357, previously identified, and measured East 3128 varas to Syndicate fence. Thence North 1700 varas to the south line of survey No. III. Thence West 104-1/2 varas to the S.W. corner of III. This corner is 3023-1/2 varas East from the west line of Capitol league 357-1/2, and a line extended South will intersect the South line of said league at a point 2717-1/2 varas West from its S.E. corner—(5741-3023-1/2 = 2717-1/2) From this point to the west line of Blk. K II is 3800 varas, hence 3800 minus 2717-1/2 = 1082-1/2 varas as shown by my first sketch. But in February and March, 1903, Mr. W. D. Twitchell, under your instructions, resurveyed Blk. K II and finding an excess of 85 varas in the North line, he gave it all to surveys Nos. 103 and 104 making the North line of each 1942-1/2 varas. This placed his East line of these two surveys 85 varas east of my line and his variations being about one-fourth of a degree more than that used by me, will make a further easting of 59 varas in the distance of 7 miles South to the most eastern N.E. corner of Capitol league No. 357-1/2 or 144 varas, which added to my former distance, 1082-1/2, makes 1226-1/2 varas as shown on sketch hereto attached. The West line of Blk. K II, as thus located, and the East line of Capitol league 367 and 357-1/2, approach each other going North at the rate of 16-1/2 varas to the mile, or one-half degree difference in variation—causing the North lines of surveys II, 12, 16 and 17 to be a little shorter than their South lines. This is a fact and not theory. Surveys 13, 14 and 15 have parallel lines and right angles—Surveys 5 to 16 inclusive contain 640 acres each—Survey 17, 526-1/4 acres—Survey 18—429 acres—Survey 19—640 acres—Survey 20—413 acres. Field notes of each can be made from sketch.

Yours truly,

counter 20649

A. D. Kooten.

XIT Surveyor

Handwritten notes:
Check with original
Sketch files

File 5-
Deaf Smith County
Sketch files

Sketch and explanation
suggesting how to correct
surveys No. 5 to 20 Blk. A,
out of conflict with Capital
Leagues 35 1/2, 367, 373 &
374 in Deaf Smith Co.,
on line of Oldham Co.,
by Capt. A. S. Howren
Capital Syndicate Surveyor.

Filed June 6/06.
John J. Tomrell
Clerk.

By Mary de Zavala
File Clerk

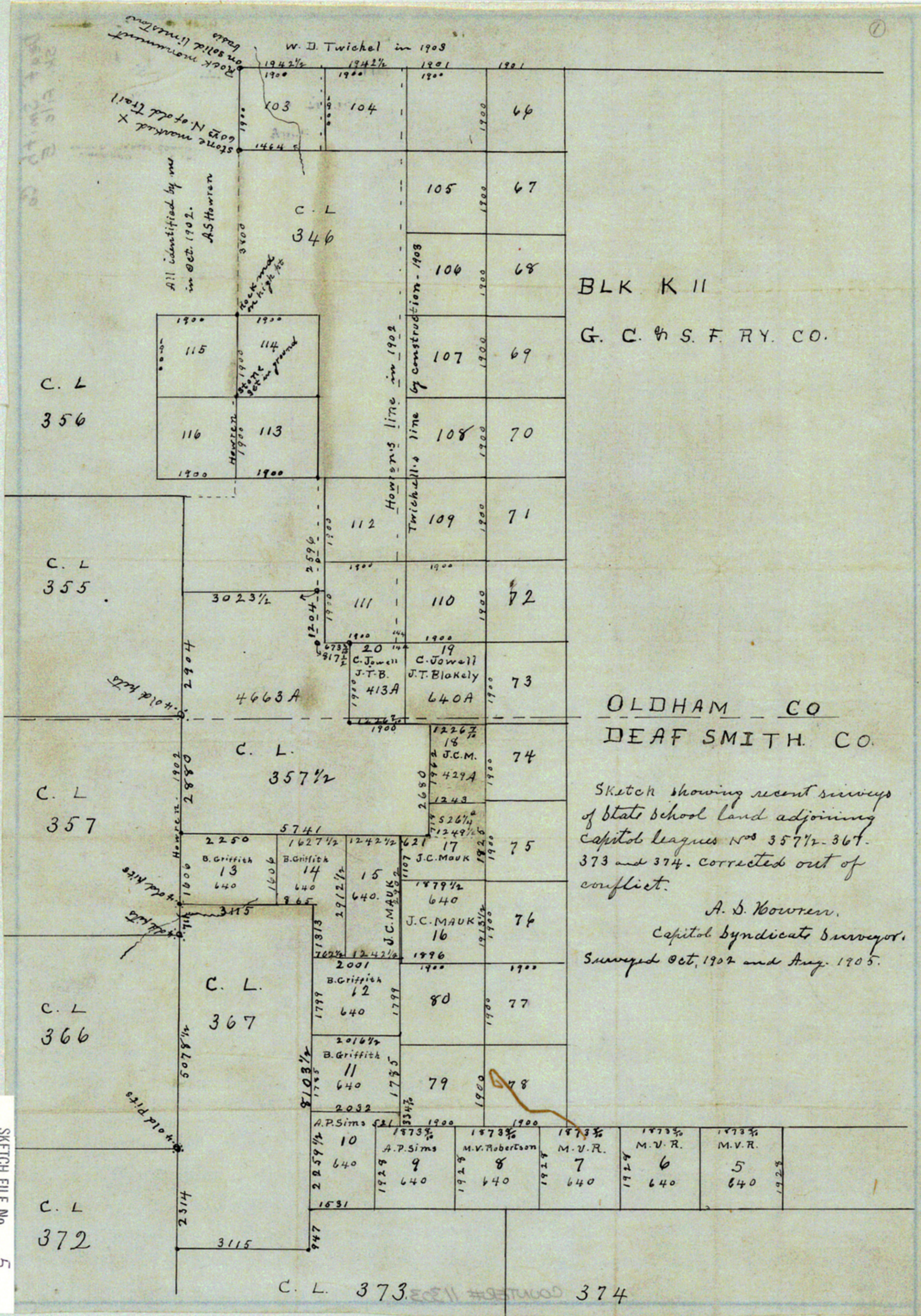

BLK K II
G. C. & S. F. RY. CO.

OLDHAM CO
DEAF SMITH CO.

Sketch showing recent surveys
of State school land adjoining
Capitol leagues Nos 357 1/2-367-
373 and 374. Corrected out of
conflict.
A. S. Howren,
Capitol Syndicate Surveyor.
Surveyed Oct, 1902 and Aug. 1905.

C. L. 373 374