

File # ~~7~~ # 8
1855

File # ~~7~~
~~7~~

Denton County

North West of Denton.
Recd. May 8th 1856

West and S. West of
Denton.

Counter 20702

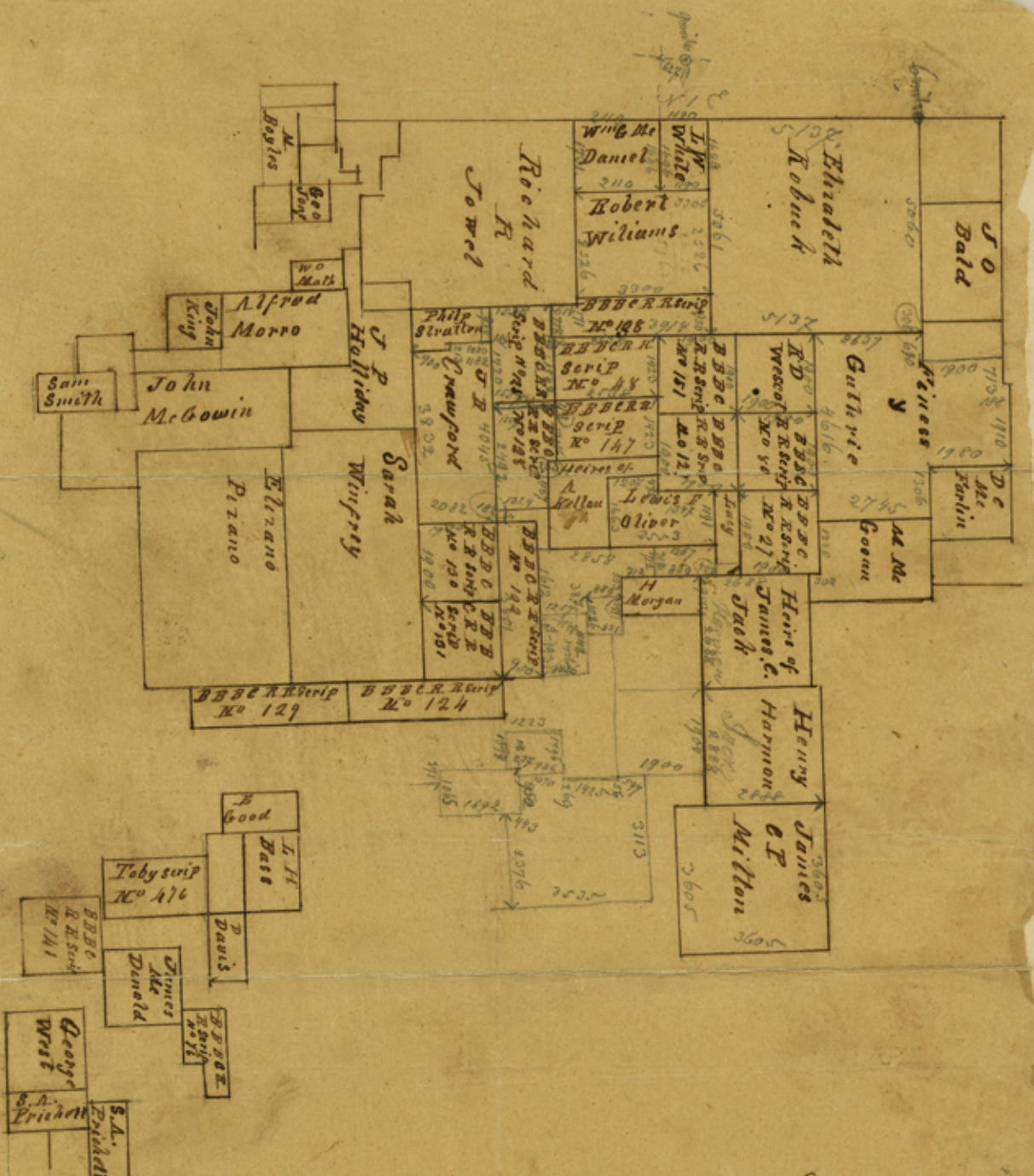

I R N Allen Dist Surv for Denton Land Dist do hereby
 Certify that the foregoing sketch is a correct representation of the
 Surveys thereon set forth as taken from the maps of my office
 Given under my hand at Alton
 Apr 22nd A D 1856
 R N Allen Dist Surv
 D L Dist

