

1870  
 1875  
 1880  
 1885  
 1890  
 1895  
 1900  
 1905  
 1910  
 1915  
 1920

Smith Co.  
 Schoolland  
 1-576 1/2  
 71,735953 042

Green B.  
 Buchanan  
 26 Labors  
 1-595

Smith Co.  
 Schoolland  
 1-576 1/2  
 28,204 947 046

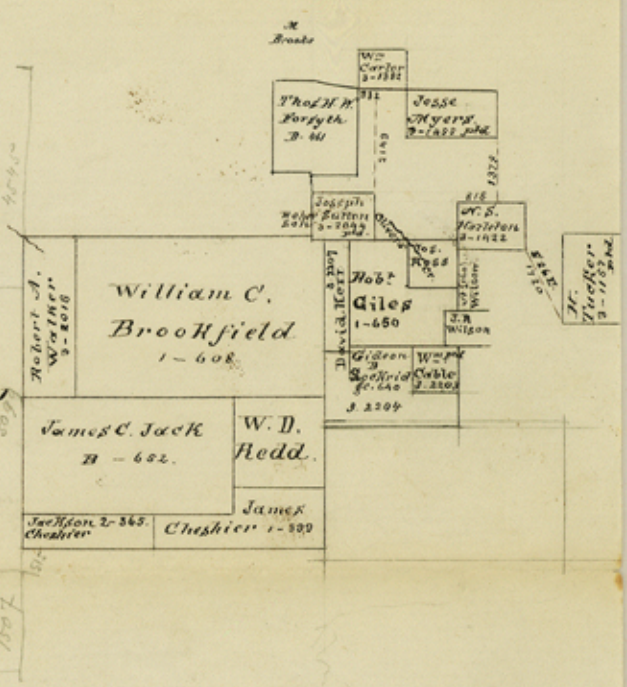

Plotted in office May 29/56.  
 by C. Stremme



21008 Johnson

County 20714

Map of the office...

Map of the office...

Map of the office...

Map of the office...

Map of the office...

Map of the office...



13 File #

Sketch file & 13-

Wise County. 1856.

+ Denton Co.



~~1858~~  
1858

#13  
##

file #

---

Denton County

in Hickory Cr.

Rec<sup>d</sup> Nov 1<sup>st</sup> 1856

---

Counter 20715





I Chas Lacy District Surveyor  
 of the Denton Land District do hereby  
 certify that the above is a correct  
 sketch of the survey in my office  
 as given under my hand  
 at Denton this the 5<sup>th</sup> day of  
 August 1857 - Chas. Lacy Dist Sur  
 of Denton Land Dis





Blue ~~marked~~ ~~marked~~

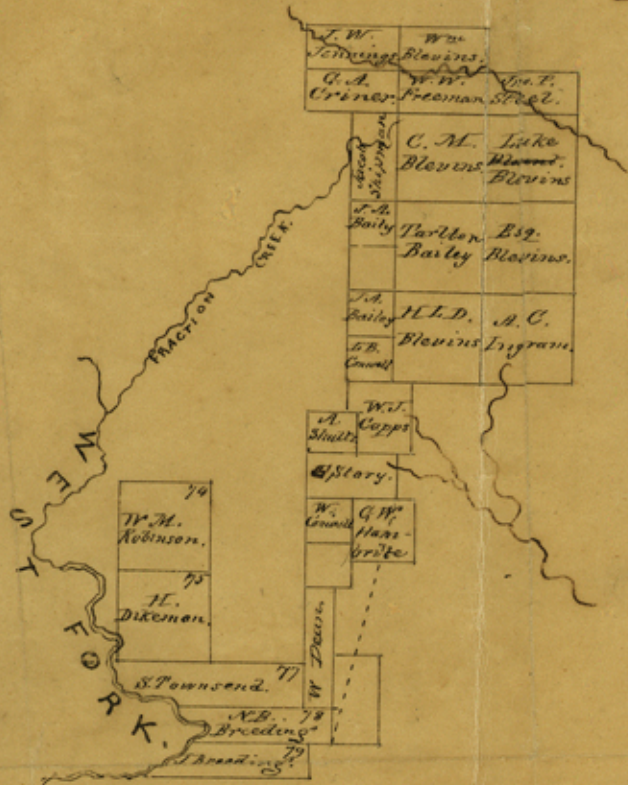

I, Charles Lacy District Surveyor of Newton Land District do hereby certify that the foregoing sketch or plot is a true and correct sketch of the map of my office  
 Given under my Hand at Atton, this 19<sup>th</sup> day of November 1856  
 Charles Lacy District Sur of New Land District

Recd Dec. 5/56.  
 Propley