

111

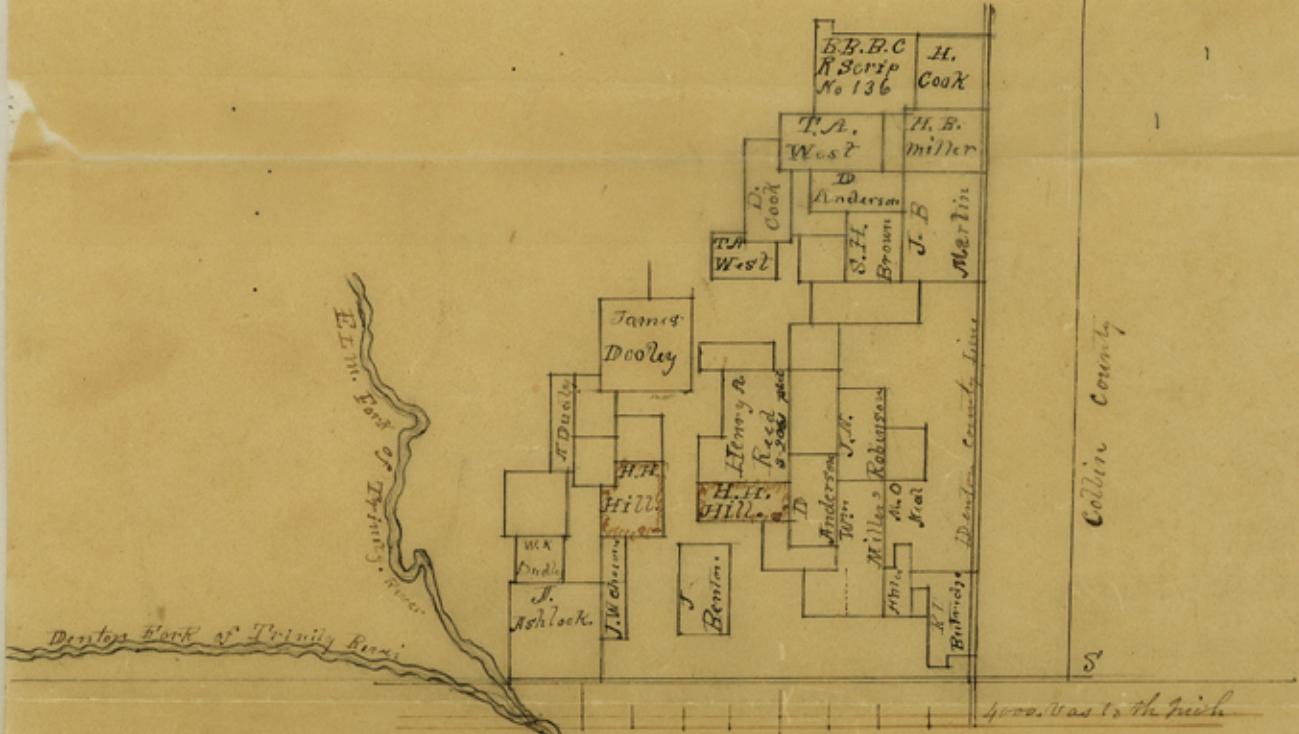

I, A. C. Lacy District Surveyor of Denton Land District do hereby certify
 that the foregoing is a true sketch of the original map of my office
 given under my hand at Atton this the 27th
 day of November 1856. A. C. Lacy District
 Surveyor of Denton Land District

Denton Co. 2k File # 18

Counter 20731

File 18
1855

18

File ~~28~~ ~~23~~

Denton County

South East Cor. of the Co^s

Rec^d May. 28/57

Counter 20732