

I, Charles C. Lacy, do hereby certify that the above is a correct copy of the survey represented, from the Map in my office. Witness my hand this 18th day of Feb. 1834.

Charles Lacy
Dist Surveyor
Denton Land Dist.

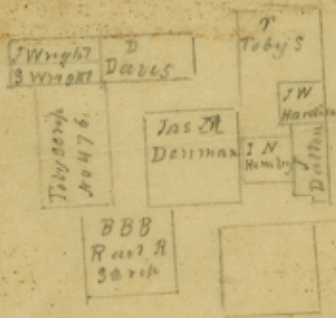

Scale 4000 is to the inch

I Chas Lacy district Surveyor of the East
 Land district Surveyor of the State
 do hereby certify that the above is a
 correct sketch of the Survey as
 delineated upon the map in this office
 August 13th 1857
 Chas Lacy Dist
 Sur Dent Land Dist

for Pittsfield 22 of record Counter 20735

3

S



A	White	JO
	Nathan	collars
	Wade	
F	Balson	

Scale 1/2 inch = 100 feet to the west

I Chas Lacy District Surveyor Bent Land District do hereby certify that I have examined the above is a correct sketch of the survey in my office

as in under my hand

this the 13th August 1867

Chas Lacy Dist Surveyor

fee 50c

Denton Co. St. File # 11

Counter 20736

File 19
1855

#19

File 31
~~26~~

Denton County

Received August 27/57.

North of Denton.

Counter 20737