

De Witt

District Line $N. 51^{\circ} E.$

County.

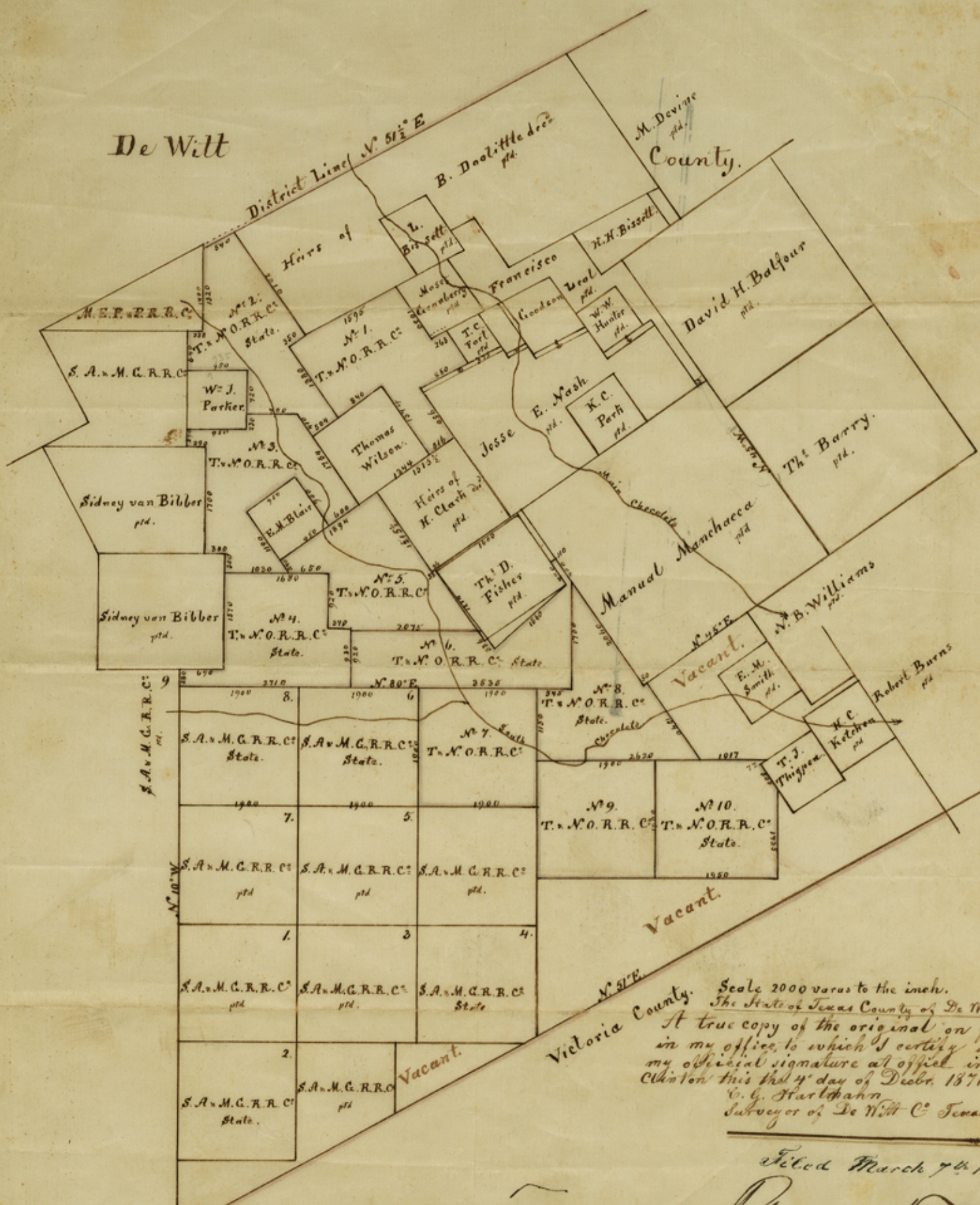

Scale 2000 varas to the inch.
 The State of Texas County of De Witt.
 A true copy of the original on file
 in my office, to which I certify under
 my official signature at office in
 Clinton this 4th day of Decr. 1876.
 C. G. Hartmann
 Surveyor of De Witt Co Texas

Filed March 7th 1877.

Charles Fisher
 Ch. C. C.