

A Section of the Eastern part of Wichita Co. Texas

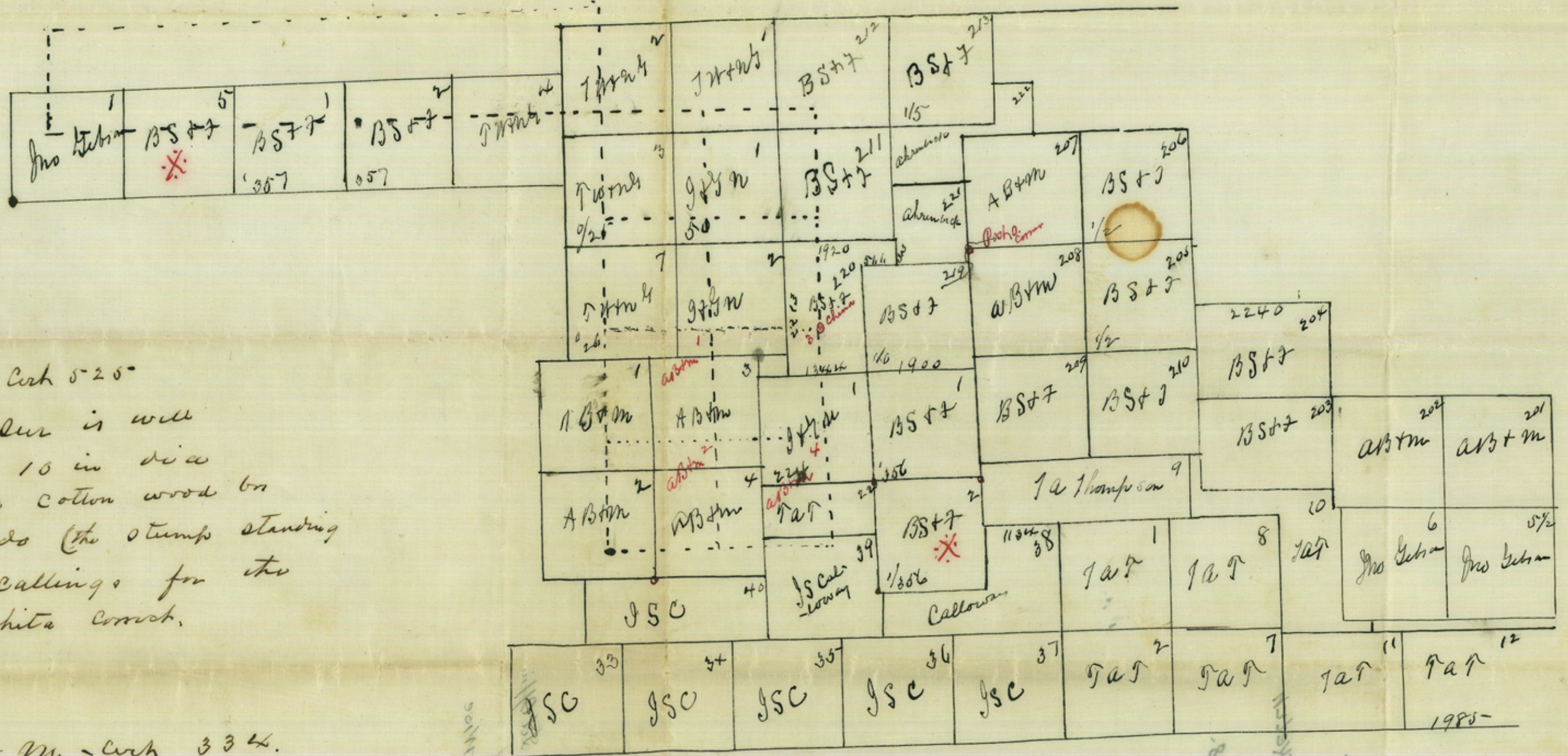
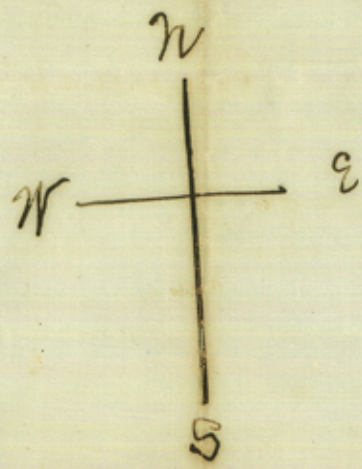

Sur 207. A B + M Ck 5-25-

SW Corner of the sur is well defined - Post 10 in dia on N 71 E 116 on a cotton wood on N 35 W 29 on a do (the stump standing N 9 W 10 1/2 M. The callings for the Crappings of the Wichita Coast.

Sur No 3 - A B + M - Ck 334.

China Tree called in draw. but seems to be in 220 BS + T an older sur.

T. G. Wags

1861

See letter Jno A Green Co. Sur in str files 6/21/98 and endorsement on same

John A. Green's Sketch
& Explanation
Filed June 25, 1898.

"D1" Dickens Co.

6/25/98

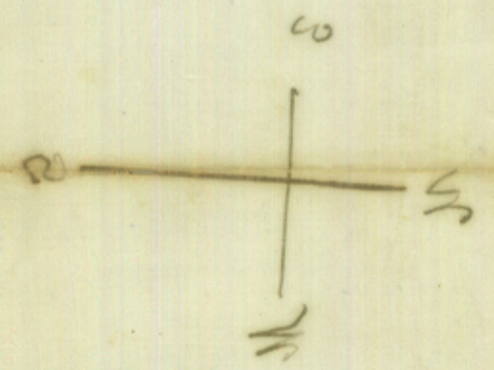
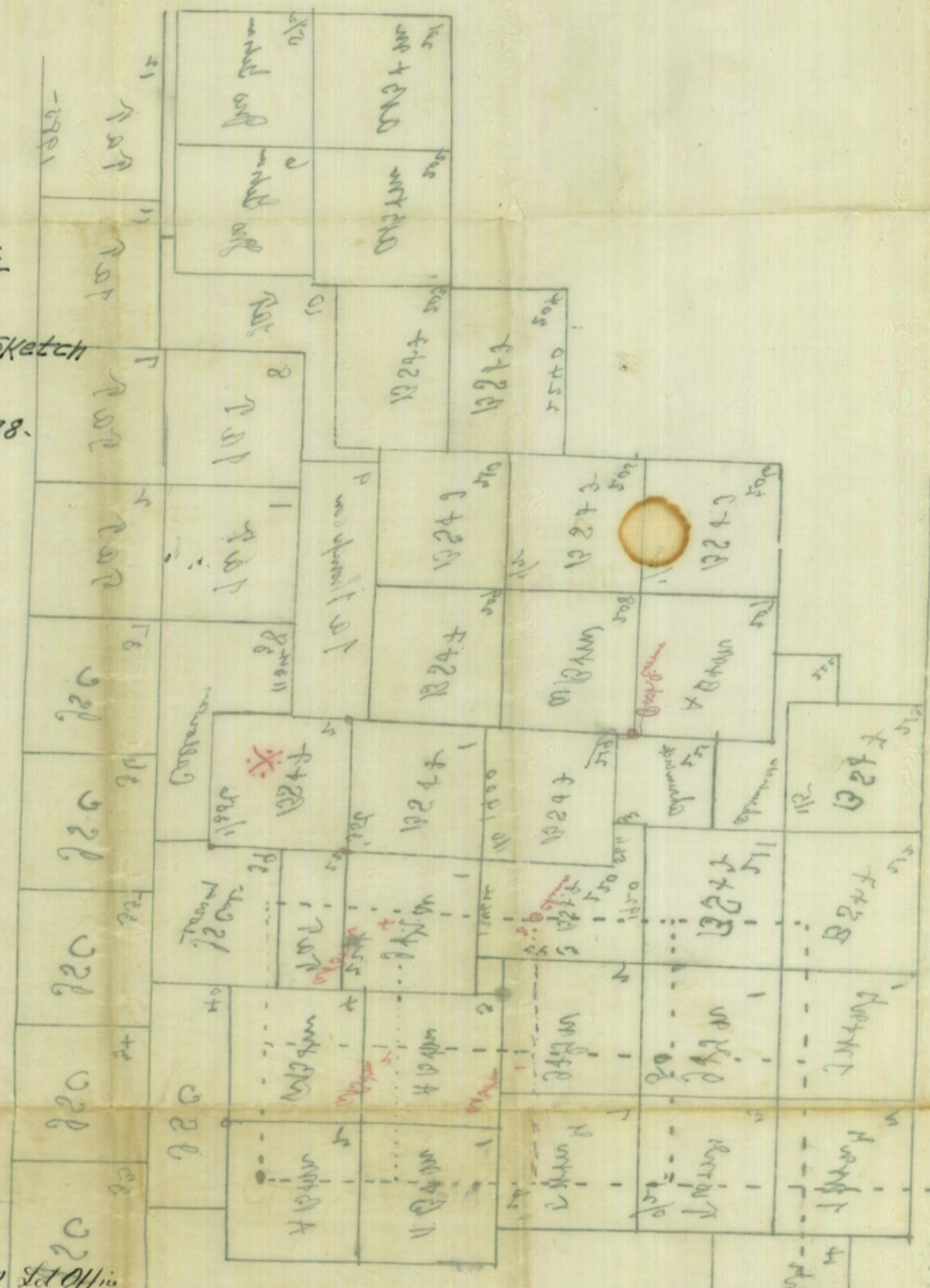

File D1

Filed in Genl. Sct. Office
June 25th 1898
J. C. Wise

Handwritten notes in cursive script, possibly describing the survey or the parcels shown in the sketch.

Handwritten notes in cursive script, providing further details or explanations related to the survey sketch.

JNO. A. GREEN,

● COUNTY SURVEYOR

DICKENS COUNTY.

Dickens, Texas, June 21st 1898

310

Hon A. J. Baker
Comr Gen Land office
Austin Texas

Dear Sir.

I had occasion some time ago to do some work in the Eastern part of this County. And find some conflicting work there, which I have concluded to submit to you for instructions. 1st The S W Cor of sec no 207. Cont 525. seems to be a noted corner. from which several of the former Dist surveyors ran their base line to Abbie Pt. (to the west) this cor is on the ground. & well defined. The enclosed plat is made from this corner. The dotted lines will show where the conflict comes in on the ground. The

JNO. A. GREEN,

© COUNTY SURVEYOR

DICKENS COUNTY.

Dickens, Texas,189.....

(2)

N.E. Corner of of sec No 3. A.B. &
M. Cert 534 calls for a Hackberry bearing
I find this Hackberry as running
from the P. oak Cr. in Sec 220. B.S. & F
and from this corner, 1900 on west and
3800 south for the S.W. Cor of sec
No 4 which calls for a cotton wood
8 in in dia. we found on a high
naked hill - in the near distance of
which no cotton wood could we have
grown. Mr Merwood our late surveyor
adopted this Cor. showing the land
on the ground both East & North -
but from which I can find no land
marks as called for in the original
field notes. I also find that 220
B.S. & F is an older sur than no 3
A.B.M. Will you instruct me which

JNO. A. GREEN,

© COUNTY SURVEYOR

DICKENS COUNTY.

Dickens, Texas, 189.....

of these works your office recognizes
as the true and original work.
It is true that China Tree on the N.E.
Cor of sec No 3- seems to be all right
but the S. Pt of No 4. will be missing
and it is equally true that No 3- begins
on No 1. and No 1. calls to begin on
on the East line of the Elizabeth King
sur. whilst in fact it lays some
6 miles eastward. Some surveyors run
from one of these corners and some
from the other creates great confusion
wherefore I ask to be advised by the
Land office in the premises.

Yours Truly

Jno. A. Green
Co Surveyor

~~76~~
Sickens Co Sketches
File D1.

June 25th 1898.

See sketch file herewith.

69901
09612

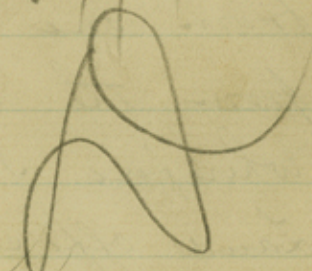
W. S. Sickens
6/27/98

66901
67901

It is shown by this sketch + statement, and also
by W R Norwoods sketch in 1894, that the
SW cor of No 207 AB + No 7 NE cor of No 3
AB + No (S-10679) have been identified and,
that the sd NE cor of No 3 is inside of
Sur No 220 B S + T (S-10191) an older
sur. This position of No 3 to No 207 has been
recognized, as the present map of the County shows.
This statement that a cottonwood tree 4 in dia
S 40 E 78 70 was looked for 7 mile West + 2 miles
South from NE cor of No 3, shows that the Sur-
veyor's record of notes of No 4, does not
agree with notes of No 4 on file here. The
field notes here, call for said Cottonwood
at the "SE" + not at the "SW" cor of said
Section. Where corners can be identified on the
ground, they will hold the surveys over ^{other} calls.

6/25/98.

Hill

This statement + sketch
might be filed in
Dickens Co sk files.)