

# Dickens Co. Sketch

General Land Office, Austin Texas.

Scale:- 2000 Varas to 1 Inch.

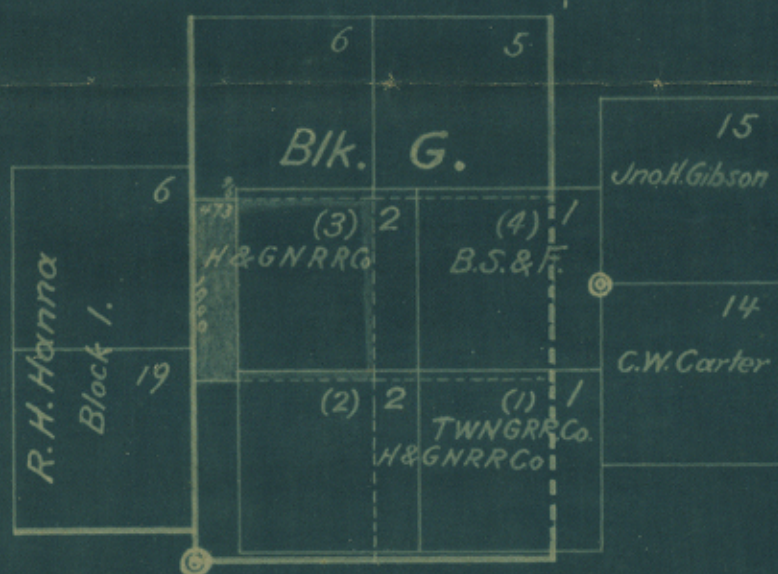

*NOTE:- The corners marked by a double circle on the plat hereon have been identified, as original corners, by State Surveyors R.M. Kenney and Geo. M. Williams.*

*Survey No. 3 Blk. G. as corrected out of conflict and approved by this office is 473 Varas East and West by 1900 Varas North and South, and contains 159.2 Acres. (See State Abstract Volume 27.)*

5-11-14. R

County 20790



- 23 - ~~45~~

Working SK. Showing BIK

G. - 5-11-14.

Dickens Co

5/11/14.



# Dickens Co. Sketch

General Land Office, Austin Texas.

Scale:- 2000 Varas to 1 Inch.

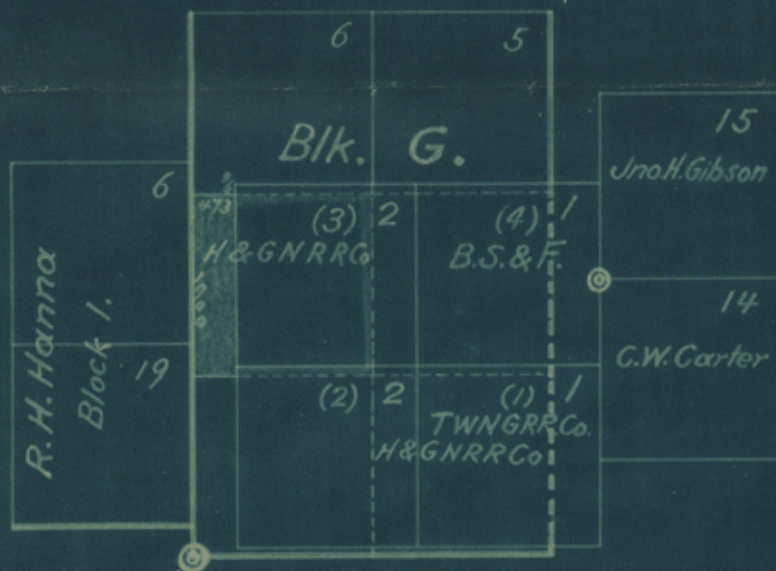

*NOTE:- The corners marked by a double circle on the plat hereon have been identified, as original corners, by State Surveyors R.M. Kenney and Geo. M. Williams.*

*Survey No. 3 Blk. G. as corrected out of conflict and approved by this office is 473 Varas East and West by 1900 Varas North and South, and contains 159.2 Acres. (See State Abstract Volume 27.)*

5-11-14. R

Created 20992