

Surveyors Certificate.

Hall County.

I James H Parks Deputy Surveyor of Jack Land District do hereby Certify that I have surveyed the lands and streams in Hall & Dorcy Counties, Texas, from forty (40) to fifty six (56) miles west of the one hundred (100th) meridian, W.L. and that the accompanying map truly represents Topography of the country. The true position and size of the Prairie Dog Town Fork of Red river with its main tributary the Mulberry river (or Scott's Creek) the next in size Battle creek, with Little Red creek and Oxbow creek John Mann Arroyo so far as it has a water course Big Sandy creek Bitter creek Cate creek and their minor tributaries, with their permanent waters represented by blue, Bitter lake, and Timber Lake, and Deep Lake. Which map bears even date herewith. And further that after a careful survey of the land lines by proper field notes I am unable to locate any corners by said field notes except the S.W. corner of Survey No 4 Block 2 and the N.E. corner of Survey No 45 which is also the S.E. cor of Sur No 76.

(over)

Counter 21219

of said Texas Pacific RR Block No 2,
which last corner is well defined by
one witness tree properly marked, and
the stake properly marked as called
for by said field notes as the true corner,
and further that there are other corners
on said block that can be identified
by the field notes thereof, and that the
china trees and cottonwood trees where
called for are miles away from the true
position of the corner and that the same
are not marked. and I further certify
that the half mile surveys marked
green on the map will if they conform
to the meander of the river as called for
by their field notes occupy the position
indicated on said map, and if they
are held in true position by course and
distance would cross the main Red
river and a portion of them lie entirely
on the south side thereof. and that
Survey No 280. Block S. 5 by virtue
of D. & P. E. ^{2d} ⁴⁰ Act No 275 as shown thereon
lies in position East & South from the true
true NE cor of survey No 277 as set by J
Summerfield, which by mistake of drafting was
taken as the N.W. cor of Survey No 280.

As further evidence of the true position of
the water course herein named see certificate
of J Summerfield, dated Jacksboro Texas
May 19th 1880, of No. 100 taken by

Done by No. 58 F. 4

run from the Critical Monument on
the 100th Meridian N. & W. to Hall
Creek on by going there down same
to intersection with Mulberry or Byrne
fork, there down same passing Big
Pondy, or Charley creek, & Mand Red
river at mouth of Byrne fork thence
up the North bank of same passing Battle
creek and to the mouth of Hoekberry or
Signed J. Sumnerfield Deputy Jack Land Dist.
and approved May 27, 1880.

This certificate noted at
Clarendon, Texas, September 28th
1881.

James H. Parks
Deputy Surveyor Jack Dist.

Filed Oct 10th 1881 Examined and recorded
in my office on ^{Oct 11th 1881} Book No 929, pages 144, 145.
W. C. Roberts Surveyor Jack Dist
By J. M. Hughes Special Deputy

Donley County
Hall County.

18/81 2/20 175

18/81 Oct. 18/81

Filed Octob. 15/81.

Rhododendron
chrysanth.

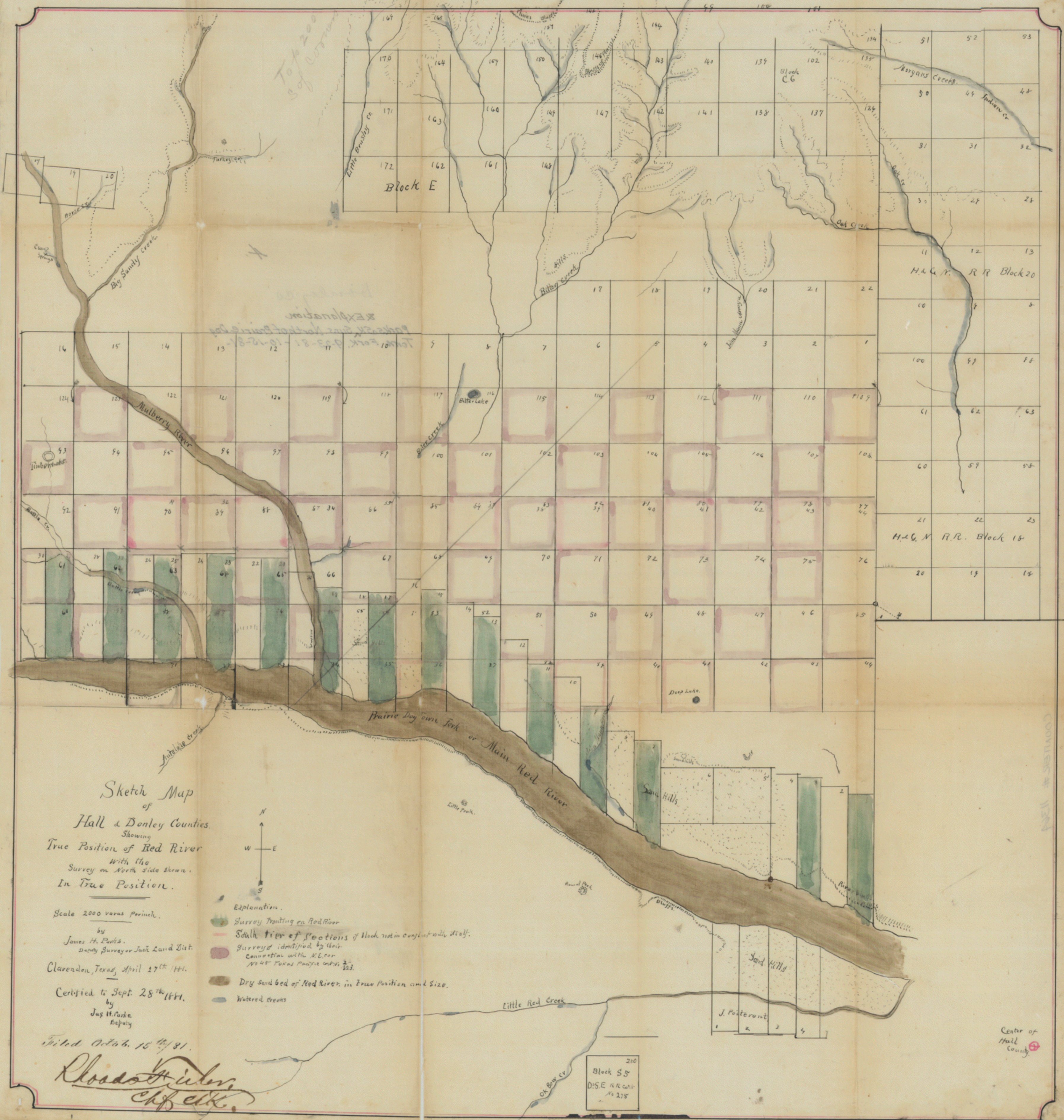

Sketch Map
of
Hall & Donley Counties.
Showing
True Position of Red River
With the
Survey on North Side shown.
In True Position.

Scale 2000 varas per inch.
by
James H. Parks,
Deputy Surveyor Jack Land Dist.
Clarendon, Texas, April 27th 1881.
Certified to Sept. 28th 1881.
by
Jas H. Parks,
Deputy

- Explanation.
- Survey trouting on Red River
 - South tier of sections of Block not in constant with itself.
 - Surveys identified by their connection with N.E. corner No 45 Texas Pacific lands 223.
 - Dry sand bed of Red River, in True Position and Size.
 - Watered creeks

Filed Octob. 15th 1881.
Rhoads & Wilson
Chas. Wilson

210
Block S.S.
D:SE R.R. cont.
No 215