

Field notes of connecting lines
in Edwards Co. Tex.

Beginning at A st md made for
the N.E. cor. of sur. no. 82 the S.E. cor. of sur. no. 82
Blk III G.W. T & P Ry Co. and the N.W. cor
of sur. no. 8 the S.W. cor. of sur. no. 10 Blk A. B.
an \bar{x} on rock by $S 83 W 8 \frac{1}{2} r$ a L.O. $4" S 3 W 38 \frac{1}{2} r$
Thence $N 70 E 1900 r$ to the N.E. cor. of sur. no. 8.
Thence $N 20 W 1137 r$ to st md in East line of sur. no.
18. Cert. No. 4/1186 G. O. X & A Ry Co.
Thence $N 30 E 1165 r$ to the S.W. of sur. no. 72 Blk 10
G. O. X & A Ry Co.
Thence $S 60 E$ passing st md the S.E. cor. of sur.
no. 73 at 3800 r a L.O. $5" S 14 W 48 \frac{1}{2} r$ a $50 6' S 54 \frac{1}{2} r$
 $W 97 \frac{3}{4} r$, at 5700 r a st md with witness trees it
being the S.E. cor. of sur. no. 74, at 7600 r a st md
with witness trees the S.E. cor. of sur. no. 75, at 15200
r a st md with witness trees the S.E. cor. of sur. no. 79
in all 17,100 r to the S.E. cor. of sur. no. 80
Thence $N 30 E$ at 1900 r a st md with witness
trees it being the N.E. cor. of sur. no. 80. in all
9500 r st md the N.W. cor. of sur. no. 41 a L.O. $9"$
 $N 41 \frac{1}{2} E 37 \frac{3}{4} r$ a L.O. $8" N 44 \frac{1}{2} E 38 r$
Thence $S 65 E 1900 r$ to the N.E. of sur. no. 41 a L.O.
 $10" S 88 E 89 \frac{1}{2} r$ a $50 10 S 88 \frac{1}{2} E 90 r$
Thence East 436 r —
Thence South 290 r to S.W. cor. sur. no. 11 Blk. 11 G. O. X
A. P. Ry Co.
Thence East 1300 r to ^{the original} S.E. cor. sur. no. 11. a L.O. $12"$
 $N 3 E 115 r$ a L.O. $11" N 7 E 113 r$.
Thence South with west lines of survey no. 15, 18,
21, 26 & 27, 9500 r to S.W. cor. of sur. no. 27, a st md

1 from which a L.O. 7" S 2 E 8 m a Cd. 8" 883 W 40 m,

2 Thence West passing st md with witness trees at 1900²
3 the S.W. cor of sur No. 38, at 2800 m a st md with witness
4 tree, the S.W. cor of sur No. 31, in all 17100 m to the
5 S.W. cor of sur No. 8 and the N.W. cor of sur No. 9 Blk. 17,
6 G.O. & P. Ry co.

7 Thence South with west line of Survey No. 9,
8 129, 128 & 127, 11140 m to the S.E. Cor. of sur No. 1
9 in name of Rebecca Watta, Blk. 76^{1/2} and N.S. Co. No. 17⁶⁰⁰₁₆

10 Thence West with south line of sur. No. 1 2419 m
11 Thence South 831 m to a cor. of sur. No. 17 Blk. 86,
12 and the S.E. cor of sur. No. 2 W.H. Woodson.

13 Thence West 17 m to East line of sur No. 41 Blk. 71
14 G.O. & P. Ry co.

15 Thence N 20 W 09 m st md the N.E. cor. of
16 sur No. 41 a st md from which a Pin. C. 4" 864 W 83³·0
17 a Cd. 6 S 6 E 16 m.

18
19 I, J. L. Hunter Co surveyor do hereby
20 certify that the foregoing field notes truly describe
21 lines as run on the ground and that all marks
22 both natural and artificial are truly described
23 therein.

24 Witness my hand this 18th day of July A.D. 1903.

25 J. L. Hunter
26 Co. Surveyor
27
28
29
30
31
32

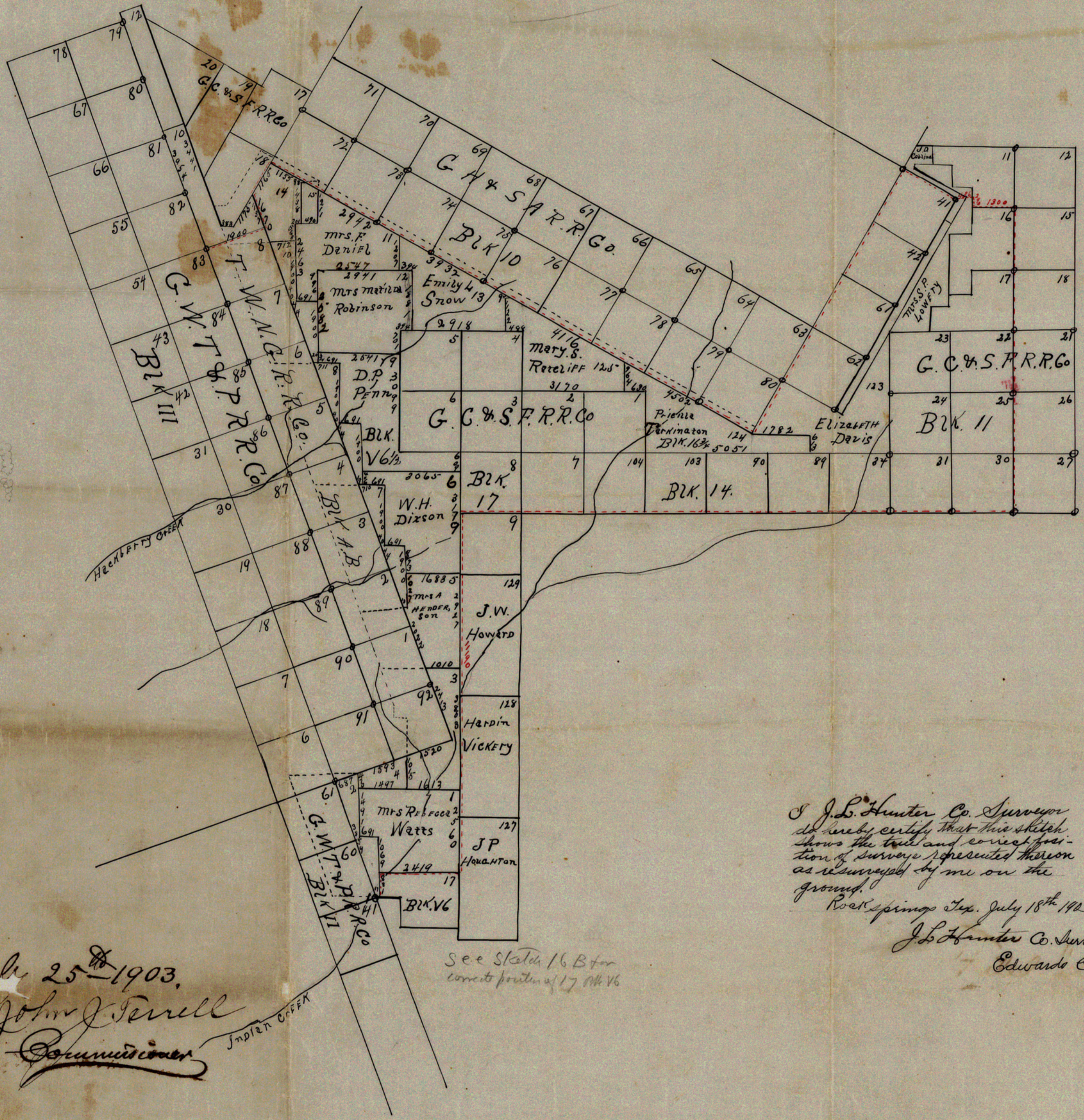

R.W. of York & Co.
 Filed for sale
 P. Kester No. 16A
 Edwards Co.

Filed July 25th 1903.
 John J. Ferrell
 Commissioner

See sketch 16 B for
 correct position of 17, V6

I J.L. Hunter Co. Surveyor
 do hereby certify that this sketch
 shows the true and correct posi-
 tion of survey represented thereon
 as surveyed by me on the
 ground.
 Rock Springs Tex. July 18th 1903
 J.L. Hunter Co. Surveyor
 Edwards Co. Tex.