

Sketch of R. A. Davis

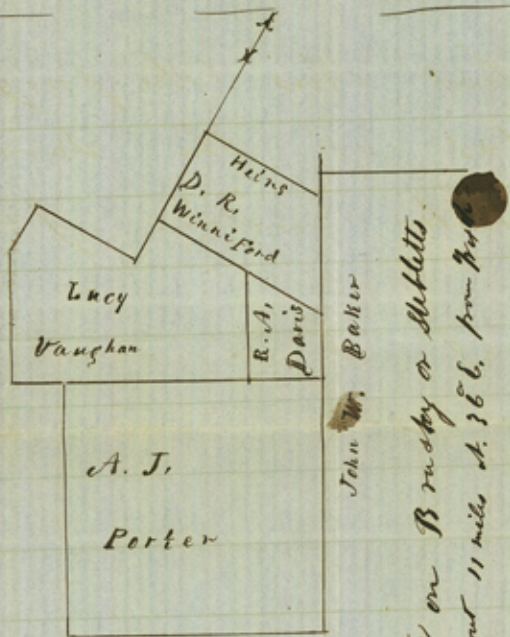

Situated on Rocky or Shelt's  
Creek about 11 miles N. 36 E. from  
-Ashi.

Scale 2000 m. to the inch.

Sketch of R. A. Davis

Scale 2000 m. to the inch.

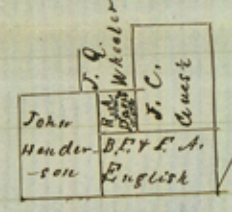

Situated on Mountain  
Creek about 20 miles N. 60 E.  
W. from Wotchaachie.

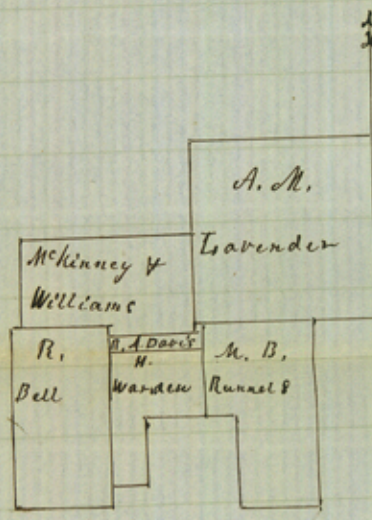

Sketch of R. A. Davis

Scale 2000 m. to the inch.  
Situated on the waters of Red Oak Creek  
about 10 miles N. 16 E. from Wotchaachie.



Sketch of D. B. D. & C. R. Co.  
Scale 2000 m. to the inch.  
Situated on Grove Creek about 4 3/4  
miles N. 53 E. from Wotchaachie.

Sketch of Hugh Henderson

Scale 4000 m. to the inch

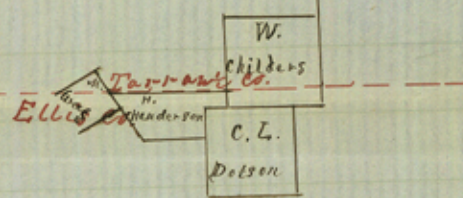

Situated on Mountain Creek  
about 20 miles N. W. from  
Wotchaachie.

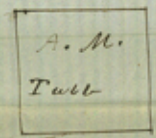

Sketch of A. M. Tubb  
Scale 2000 m. to the inch.  
Situated on Grove Creek

I do here by certify that this (the foregoing)  
is a correct sketch of the survey  
made in last quarter ending January  
the 1st 1861

John L. Richardson  
Sur. Ellis Co.

File 14

Ellis County

January 9<sup>th</sup> 1861

John J Richardson's Sundry  
Sketches.

Dated Jan. 1, 1861.  
Filed do, 9, 1861.

County 21855