

File 15

Ellis County

Rec^d May 30/61

*Different parts of
the County.*

*John J Richardson's Sundry
Sketches,*

Dated April 18, 1861.

Filed May 30, 1861.

County 21856

Sketch of D. B. B. & C. R. co.
 V. W. G. Parks
 Scale 2000 m. to inch.
 Situated in Ellis
 county on the waters of
 Frenchachie creek about 3 1/4 miles N. 25 W.
 & N. 28 W. from Frenchachie.

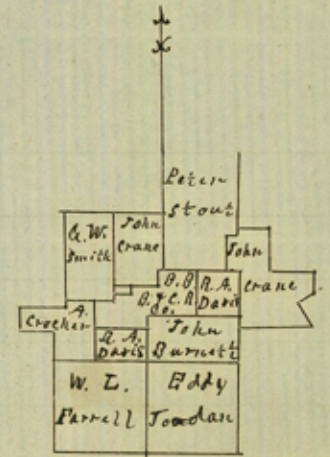

Sketch of D. B. B. & C.
 R. co, R. A. Jarvis and
 R. A. Jarvis
 Situated on the waters of
 Grove creek about 8 1/2
 miles and 9 miles
 from Frenchachie.
 Scale 4000 m. to the inch.

Variation 10° E. Sketch of R. A.
 Jarvis
 Scale 2000 m. to the inch.
 Situated on Grove
 creek about 7 1/2 miles
 N. E. from
 Frenchachie

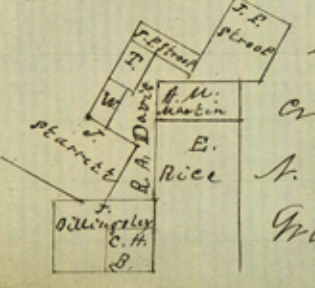

Sketch of Gendolupa Garcia.
 A. S. Variation 9.45° E.
 PreWett Scale 2000 m. to inch
 Situated on Grove
 creek about 4 miles
 N. E. from Frenchachie

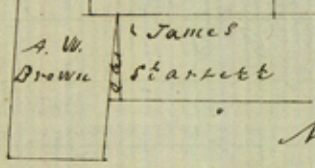

I, do hereby certify that the
 above sketches are correctly represented
 and that they are sketches of
 all the survey made in last
 quarter ending April 1st 1861
 given under my hand
 April 1st 1861

John S. Richardson
 Sur. Ellis Co.

G. M. Stewart
 1861