

Filed July 15/61.
E. W. Prebles.

The expression herein used
"without variation"
means magnetic.

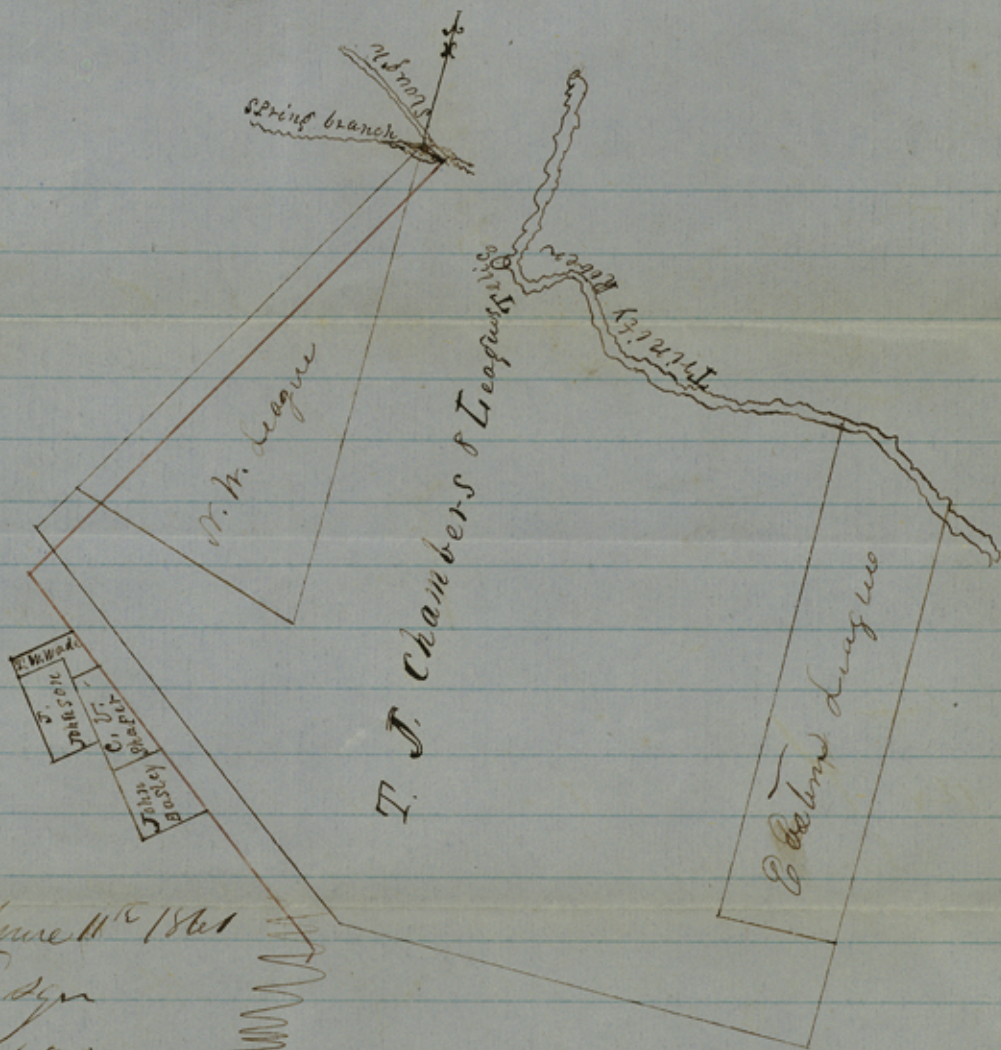

Map of Achaie June 11 1861
H. M. White Esq
Austin Texas

Upon Sir;

This is an explanation of T. J. Chambers & League
I began at the S. E. corner of the Eastern League
I found a large Pecan which showed old marks
which is called for in said Chambers - field notes, which
br. N. 40° E. 75 m. — Thence South (without variation) 1242
— Thence West 10,000 m. — Thence N. 52° W. 11,000 m.
(The lost mound call is 150 m. farther than is called for
in the field notes) — Thence N. 30° E. 1941 m. I
found 2 Elms in the head of a ravine with old
marks upon them bearing S. 70° E. 120 m. The said
Elms are called for in the Surveyors pass Book
that did the surveying, on the Book that has
been introduced into the suit as such. —

Then I began at said Chambers North corner
on which is claimed by said Chambers as
his proper corner, at the junction of a Spring
branch with a slough, I found Pecan and
Oak this being the description the said

field notes give of this corner, but did not find the bearings. — Thence S. 30° W. the distance that is called for in the field notes brought me to a point S. 52 E. 552 m. and S. 30° W. 208 m. of the place I made for the corner by running from the S. E. corner of the Eastern League by reference to the foregoing. Sketch you can see the position of it the lost run is represented by the dead lines, and I made

the following surveys by the lost run so as to be certain not to conflict with some of Leagues, J. N. Wade 154 acres, Charles V. Shaper 320 acres, John Easley 369 acres, Henry B. Bland 320 acres, and Moses Jones 320 acres I have set forth the facts in the case and I think when you consider them you will have no hesitancy in issuing the patents on the above named claims

Yours truly
John S. Richardson
Sole Ellis co.

File 16.

Ellis County.

Recd. July 15/61.

Wm. Trinity & Co.

John Richardson's Sundry

Sketches.

Filed July 15, 1861—

Surveyor's sketch and
substance showing the
position of S. E. corner
of League and surrounding area

