

Scale 2000 ns. to the inch.

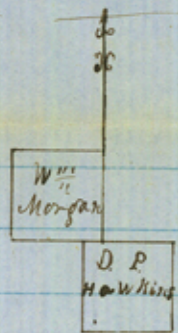

Sketch of S. P. Hawkins  
Situatd on the waters  
of Machachie crk about  
8 3/4 miles from Machachie

Scale 2000 ns. to the inch.

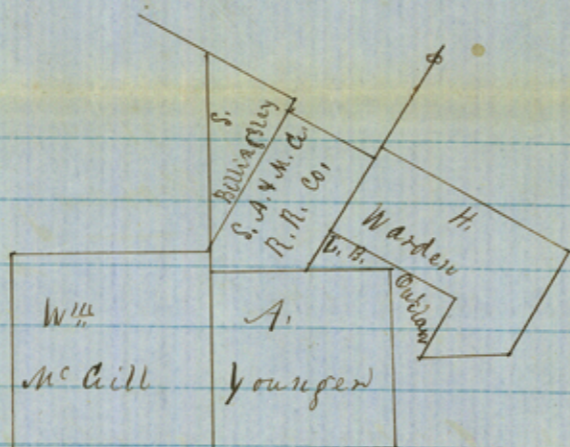

Sketch of S. A. & M. G. R. Co.  
R. Co. Situati'd on Red  
Oak crk about 9 miles  
N. 15° E. from Machachie

Scale 2000 ns. to the inch.

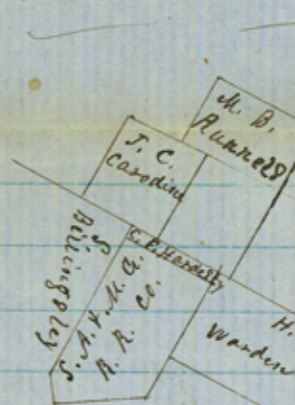

Sketch of G. H.  
Woodruff  
Situat'd  
in Ellis co.  
on waters of  
Red Oak crk about 9 miles  
N. 15° E. from Machachie.

Scale 4000 ns. to the inch.



Sketch of M. J. & J.  
Nicholson Surveys.  
Situat'd in West  
corner of Ellis co. on the  
waters of Mountain crk

Sketch of S. L. Lough

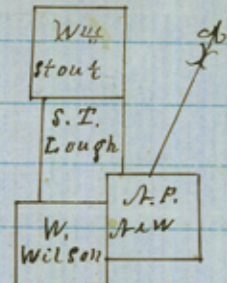

Situat'd in the N. W. corner  
of Ellis co. about 25 1/4 miles  
N. 6 1/2 W. from Machachie  
Scale 4000 ns. to the inch

Sketch of J. W. Wade.  
Scale 4000 ns. to the inch.

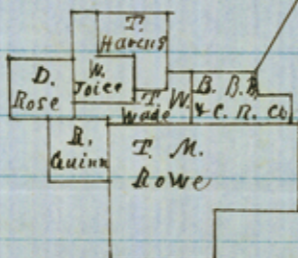

Situat'd on Cummins crk about  
15 miles S. 75° E. from Machachie.

Sketches of J. W. Wade, C. V. Shaffer,  
Henry Bland, Moses Jones & John Easley.

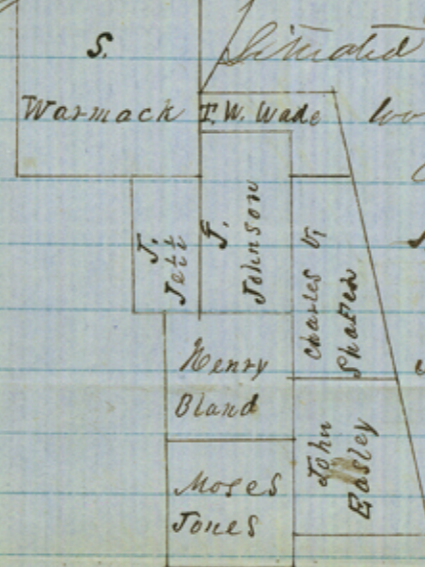

Situat'd in Ellis co. on the  
waters of Cummins  
Creek about 20 miles  
S. 65° E. from  
Machachie  
Scale 2000 ns. to the  
inch.

Sketch of C. B.  
Cornelius & J. J.  
Cornelius  
Situat'd on the waters of  
Chambern crk about  
11 3/4 miles S. 35° W.  
from Machachie.  
Scale 2000 ns. to the inch.

Sketch of James B. Moyers.

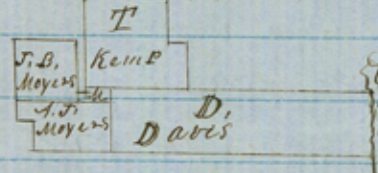

Situat'd on the waters of  
Trinity River about 16 1/3 miles  
N. 46 1/2 E. from Machachie  
Scale 4000 ns. to the inch

I, John S. Richardson Surveyor of Ellis  
County do hereby certify, that the foregoing  
Sketches are correct, & including all the  
Surveys made in last quarter ending August  
the 1<sup>st</sup> 1861

Given under my hand  
This August 1<sup>st</sup> 1861  
John S. Richardson  
Sen. Ellis Co.

Vol 17  
Ellis County  
Surveyors Report  
& Sketches

---

Different parts  
of the County:

John Richardson's Sundry  
Sketches.

Dated August 18, 1861  
Filed August 19, 1861-

2  
x

Counter 21861

Filed Aug 19/61  
E. W. Prepper.