

Site 18

Ellis County
Sundry sketches in Ellis
County - Filed 9-28-61 -

Filed Sep. 28-1861

Filed Sept. 28/61.
C. W. P. 1861.

Scale 2000 varas to the inch
Sketch of E. Euberton

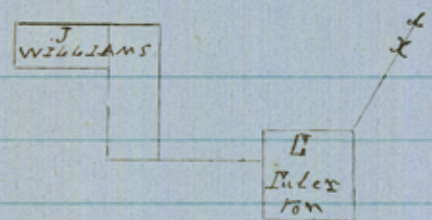

Situated on the waters of Chambers Creek - about 10 1/2 miles S. 72° W from Waxahachie

Sketch of Asa Newton
Scale 4000 varas to the inch

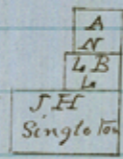

Situated on the waters of Chambers Creek, about 9 1/2 miles N 67° W from Waxahachie

Sketch of Elizabeth Rice
Scale 2000 varas to the inch

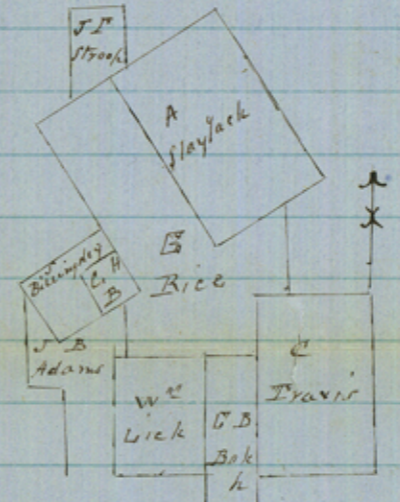

Situated on Groove Creek about 4 1/4 miles N 30° E from Waxahachie.

Sketches of Asa Newton

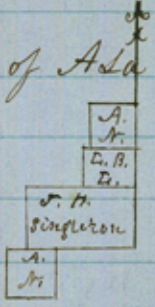

Scale 4000 var. to the inch.
Situated on the waters of Chambers Creek about 10 miles N. W. from Waxahachie

Sketches of J. L. Brooks, and J. M. James

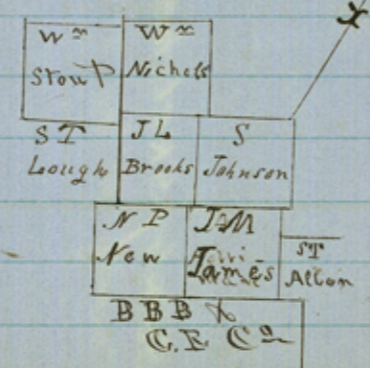

Scale 2000 varas to the inch

Situated in the North West corner of Ellis County

Sketches of H. D. Scott

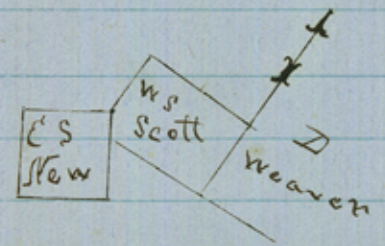

Scale 2000 varas to the inch -
Situated on the waters of Waxahachie Creek, about 10 miles N. W. from Waxahachie

Sketches of C. R. Roland, S. Roland + J. H. M. Knight



Scale 4000 varas to the inch
Situated on Groove Creek 2 1/2 miles N. E. from Waxahachie