

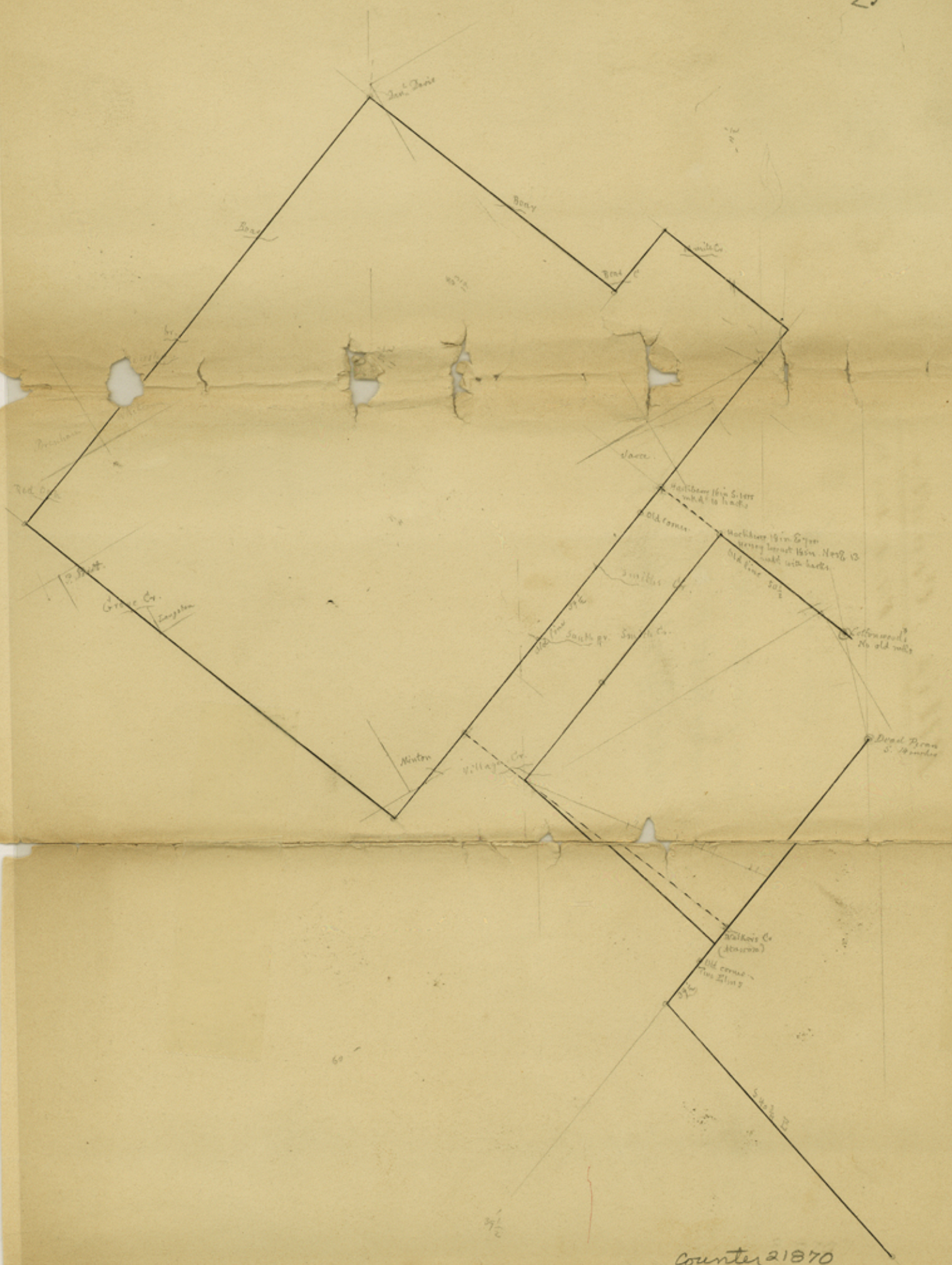

Scale 4000 varas to an in.

Robert M. Wyatt
 Co. Sur. of Ellis Co

8
11
4
22



Counter 21870

55

File 20.

Ellis County

Filed May 20/69

On Trinity R.

Sundry Sketches & Explanations
of ~~the~~ Robt M. Wyatt,

Date - April 24. 1869.

Counter 21571

56

4/24/69 -

4/24/69.

I R. M. Wyatt County Surveyor of Ellis County Texas. do hereby Certify, that the boundary of the A de la Garza 3 League and the T. J. Chambers 8 League Grants and its connections with other Surveys, were determined by actual Survey, by beginning at the North corner of said 8 Leagues Survey which is the East Corner of A de la Garza's 3 League Survey, a point at the Mouth of a small branch on the W. side of a Lake or Slough of running water. Thence a dead Pecan trs. S. 14 inches. — Thence run with Variation $10^{\circ} E -$

$N 11\frac{1}{2} W$ with the General Course of said Lake 3430 vs to a Point on the West bank of said Lake: found some Cottonwood trees, but no Old Marks — Thence $N 50\frac{1}{2} W$ following a plainly Marked line at 1000 vs cross the North Line of the W. J. Charles Survey 100 vs $S 60 W$ of his West N. Easterly Corner — at 1360 vs Cross Smith's Creek — at 5000. varas. a Hackberry 18 in. trs E. 7 vs. a Honey Locust 18 or 20 in. trs. $N 45 E. 13$ vs. The Hackberry having nine hacks. on the West side and the Locust has blazes, appearing to be about 30 years old. or corresponding with the age of the Marked line — Continuing same Course on said Old Marked line 7500 vs. to the North Corner of said Survey whence a Hackberry 16 in trs. South One Vara. Marked with 10 hacks on two Sides — Thence $S 39\frac{1}{2} W$ following a plainly Marked line, at 1000. vs. pass an old Cor. at 3250 vs. Smith Creek — at 6150 vs South prong of Smith Creek — 10,000 varas to the West Cor.

Thence $S 51 E.$ at 1800 vs Cross Village Creek at 10,100 varas the N. W. line of said Chambers 8 League Grant 90 vs East of Walkers (Atascosa) Creek and the point described in said Chambers title — Thence $S 39\frac{1}{2} W$ with said N. W. line, at 90 vs. crossed Walkers Creek, at 1360. vs. a point whence two Elms described by G. W. Pinson each Marked with Six Old hacks. on the South and East Sides —

Standing in the head of a hollow. brs S50°E. 120 vs.
3093 vs. to a point for the West corner of Said Chambers
grant whither I set a stake. whence @ Musket.
brs. N43½E. 1494 vs. — Thence S40¾E. 10,850 vs
to the South corner of Said 8 League Grant as
described by the surveyor of Navarro Co.

Recorded in My Office in Book G. Page 358

This the 24th April 1869.

Robert M. Gart.

Sur. Ellis Co.

Ellis County Sketches
A. de la Garza
boundaries
re

20

Ellis Co. St. File #20
Counter 21874

I R M Wyatt County Surveyor of Ellis County Texas do hereby certify that the beginning corner of the Rafael de la Pena eleven league Grant situated in Ellis & Kaufman Counties. was by me found. and that there is now standing (in brushy or overflow bottom on the West side of Trinity River) One of the bearing trees, to wit, a Hackberry about 16 in. in diameter. Marked with ten hucks on two sides, brs. South 1 vara. pointing to the intersection of two plainly marked lines corresponding to the N.E. line of A De la Garza's 3 League Grant and the S.E. line of the Rafael de la Pena grant. all of which marks are about 30 years old.

Thence run with variation of $10^{\circ}E$ - $N 39\frac{1}{2} E$ at 792 vs cross the N.E. line of Ann Maria Jaca. Sea & Labor. Sur. 1740 varas $S 30 E$ of its North corner; at 5110 vs. a Willow on the West bank of the Trinity river. Thence an Elm 20 in dia brs. $N 88 W 3\frac{1}{2}$ vs. And the S.E. corner of Ed Harris League Survey brs $N 64 W 170$ vs. at 6500 vs. the East corner of Said Grant in bottom on the East Side of Trinity River - Thence $N 50\frac{1}{2} W$ at 2250 vs Recross Said River a Cottonwood 12 in dia (Marked) on the West bank - at 3790 vs. Cross Ten mile Creek. 5000 vs to a Stake in a thicket and pond. whence an ash 15 in brs. $S 82 W 8$ vs and another 14 in brs $S 5 E$ 5 varas - Thence $S 39\frac{1}{2} W$ at 2100 vs. Bear Creek. 2500 vs. to a Chinaware for. cor. Whence a Hackberry 6 in brs $N 6 W 2$ vs. and a Bur Oak. 22 in brs. $N 9 E 24$ vs. - Thence $N 50\frac{1}{2} W$ at 4420 vs Bear Creek. at 4810 vs enter Prairie at 10,000 vs set a Stake for cor. on a small Branch whence an Elm 10 in. brs $S 20 W 50$ vs and a Cotton Wood 10 in brs. $N 3\frac{1}{2} E 44$ vs. and the N.W. Cor. of the Daniel Davis Sur. brs. $N 5\frac{1}{2} E 415$ vs and A. A. Moyers N.E. cor. brs. $S 52 E 190$ vs. - Thence $S 39\frac{1}{2} W$ at 5,700 vs. Bear. Creek 9900 vs. Cross Branch in Big thicket. at 10780 vs. Cross. Bushy Creek.

at 13,832 us. cross the East line of R. F. Brenham Sur
and the West line of Littleton White's Sec. & Labor Sur.
407 us N 30 W of Said White's S.W. corner; at 16,465
us. cross Red Oak Creek; 17,500 us to stake on a ridge
Whence a Cotton wood 40 in brs N 39 1/2 E. 1015 varas and
an Elm 10 in brs. S 50 1/2 E. 434 us. — Thence S 50 1/2 E
at 2050 us. cross the N line of Peter Stouts Survey
of 640 acres, 646 varas East of his N.W. Corner; at 4360 us
Cross Creek at 5777 us Pass over the S.W. corner of
Jesse Sangstons. P. E. Sur. of 160 acres; at 15,000 us
Set a Stake for Corner whence 3 muskets from the
same spot. brs. S 26 1/2 W 45 us — Thence N 39 1/2 E
at 1260 varas the S.E. line of the John Minton
Survey. 310 us N 60 E. from his S.W. corner: at 2100 us
Delago Creek at 3500 us. The West corner of A de la Garza's
3 League Grant at 7350 us cross Harry Prong of Smith
Creek; at 10350 us. Smith Creek: at 12500 us pass an
old corner in the overflow bottom, corresponding to the
description given by J. G. W. Pierson for the S corner of
League No 11 in his map of Eleven Separate Leagues.
Continue with an old, plainly marked line: 13,500
varas to the Beginning

Recorded in My Office in Book G. Page
359. This the 24th April 1869

Robert H. Wyatt
Sur. Ellis Co.

De la
Peña

5