

➤ About 20 Mls. N. of Stephenville

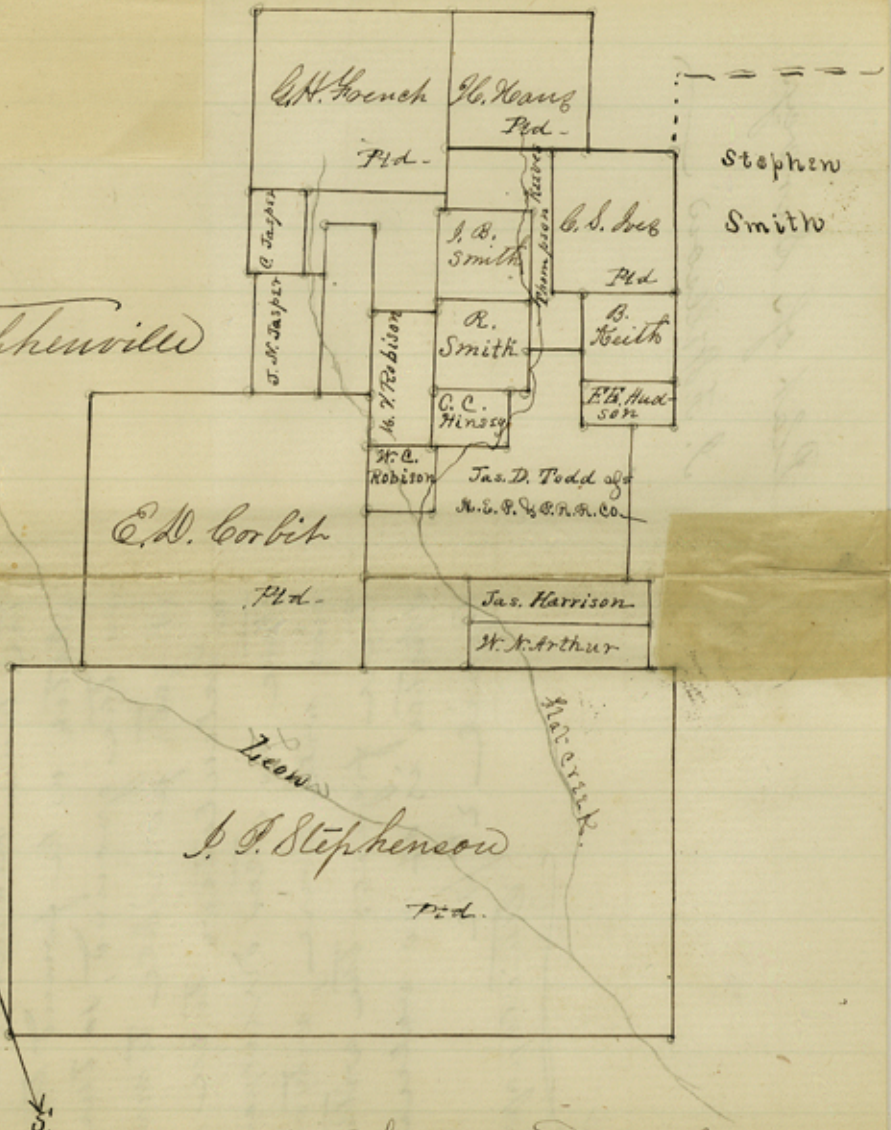

I S. T. Evans County Surveyor of Crath County, do hereby certify that the E. D. Corbit and J. P. Stevenson surveys do not extend as far East as is represented upon the County Map. but by actual measurement upon the ground, I find it as represented upon the above plat with accompanying field notes. and there is no conflict
 Given under my hand this 10th day of August 1871
 S. T. Evans C. S. & Co.
 per J. F. Hillard Sp. Supt

Site No. # 12 11

Orath County

on Plat 6 of the Leon River
near the West line of the
County Aug. 10, 1871.

Dated September 13, 1871.

STEVENS, Surveyor.

20th of Stephenville

of the said surveyor finds
discrepancies in the ground
he is bound to insert
the true measures in the
sketch as he found them
on the ground, so that
it gets possible to make
a calculation to see if
there are other discrepan-
cies will arise, with out
these figures the within
sketch is of no value.

April 25/72

Thielapay



Plat of Survey
J. F. Miller

County 22880