

Compare State surveyors
sketch.
Schmidt

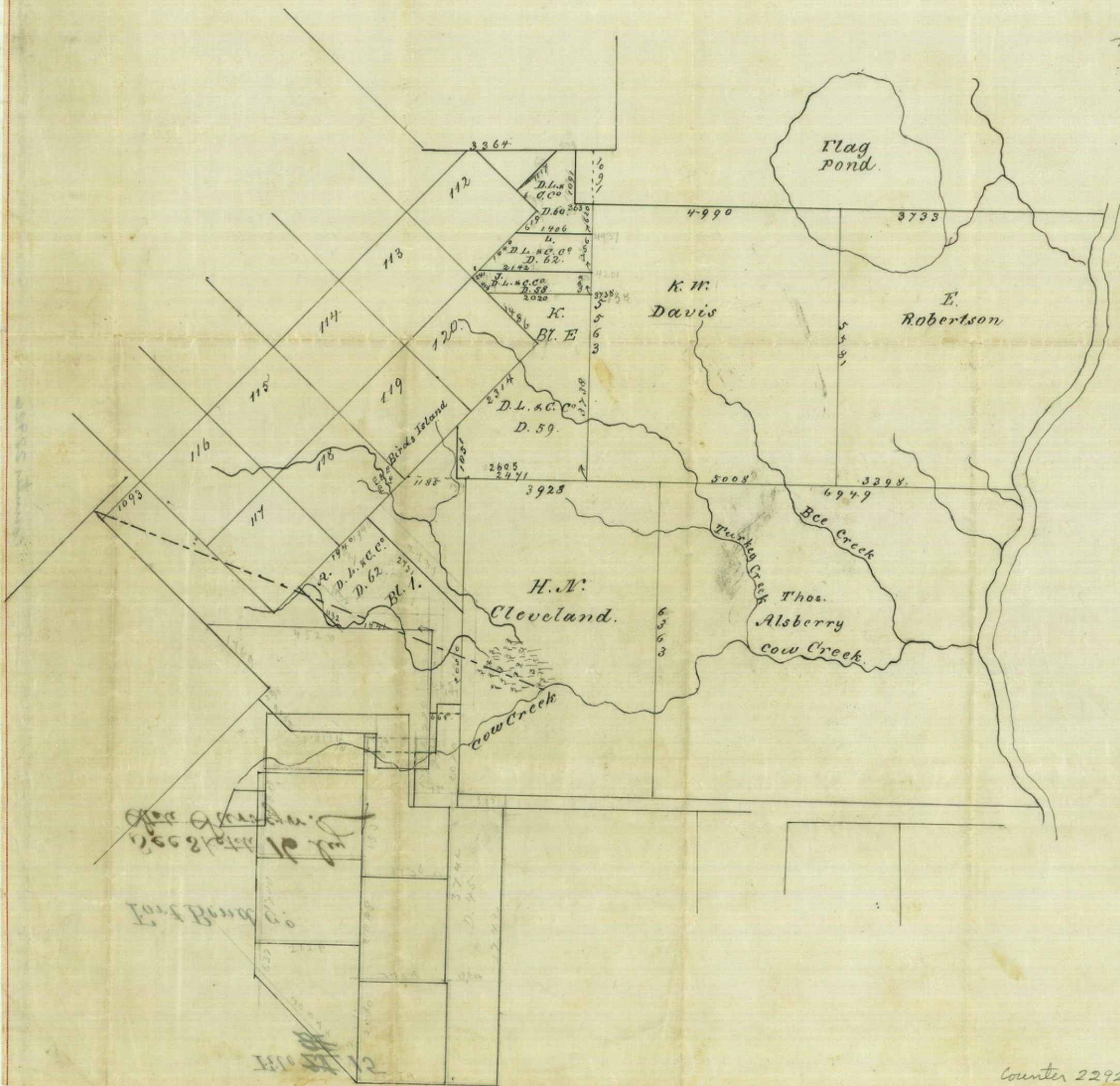

[Handwritten notes and signatures]

East Bond Co

1110 1111 1112

Sketch file #162 ~~23~~ ¹⁶²

Fort Bend County

Sketch and connections of
H. & T. C. Pybo. surveys on
Coon & Cottonwood Creeks
S.W. from Richmond.

By H. J. Walgen
Co. Surveyor Fort Bend Co.

Filed Dec 31/90



AUSTIN, TEXAS.



509

counter 22927

