

#6

Sketch File G. F.

31
30
29
28
27
26
25
24
23
22
21
20

Frio County
South East corner of County.

11-5-83.
See Sketch in S-44231

WW Haynes sketches in SE
Cor. of County.
Dated Nov. 5, 1883-

46802

See Sketch S-44231

Now W. C. Walsh =
Comr. Genl. Land Office
Austin Texas
J. W. W. Haynes

As Sur. Tris Co do hereby certify
that I did before making the
locations for M. E. Shiner on
the Ruez Creek = I went to the
upper river corner of the Henry
P. Bayce Sur. No 89 = which I
found by its bearing trees still
standing and corresponding exactly
with the field notes = for same
I then ran N 45 E = and at
54.50 Vrs = pass the South Cor-
ner of J. Poiteout No 1 = and
at 57.50 Vrs = another corner of
said Poiteout = at 59.49 Vrs =
to a stake for the north cor-
of said H. P. Bayce No 89 =
Thence S 45 E 175 Vrs = to a
stake for a corner of P.
Prumer = Sur = Thence N 45 E =
at 650 Vrs = a corner of State Sur-
vey No 2 = on the west bank
of Ruez Creek = at 860 set a
stake for North corner of
said P. Prumer Survey = at
3147 Vrs = corner of State Sec-
No 2 = identified by its bearing
trees still standing at 3547 =

Er

counter 23119

FRIO Co Sd. File #6

line of Austin & Williams Sur.
No 977 = Thence N 45 W = 320
Vrs. and set a stone for the
South corner of Sand Veasey =
Survey = I then proceeded to
the North corner of J. Piteoult
Sur = No 1 = (bearing trees still
standing = I then ran the
North lines of said Nos
1 and 2 and B.S. & F No 1-
to N.W. line of No 3 - and
find all the corners by their
bearing trees still standing =
I then ran N 45 E = passing
North corners of Sections Nos -
386 & to North cor = of No 5 and
found no bearing trees for said
corner = I then ran N 45 W =
53 Vrs. and N 45 E = 400 Vrs =
and set a stone for East Cor
of Austin & Williams Sur = No
977 = I then ran N 45 W =
continuing around on the
boundary lines of A & W & S-
Veasey = Survey to point set
for South Cor = of said Veasey
In running these lines I had
all the brush cut and did
the work very carefully =
The North corner of Section
No 30 = was set by running
from the North corner of
J. Piteoult - No 1 - S 105 76 -

In making the locations West
and South of Austin & Williams
Surveys on Saw Mequib = No^s 969
& 970 = I began at the S.W.
Corner of A & W. Sur = 964 =
said corner having been establis-
hed by W. H. Fountain Co Sur =
of Atascosa - he having establis-
hed same by running from S.E.
corner of said Sur = No^s 964 =
bearing trees still standing =
I then ran from this point
N 74 1/2 W = crossing the Saw
Mequib Creek 1900 Vrs. to a
stake for S.W. corner of John
Martin Survey = Thence N 15 1/2 E
457. Vrs. to a stake for S.E.
corner of A & W. Sur No^s 969 =
Thence N 74 1/2 W = 3292 Vrs to
a stake for S.W. corner of
said A & W = Sur = No^s 969 =
I then went to N.E. corner
of St. Castro Survey No^s 61 =
bearings still standing = and
corresponding with field notes
for this Survey = I then ran
S 4 1/4 W = 950 Vrs. and set a
stake for S.E. corner of this
Survey = and continuing on
same course. passing the st^{ks}
& piles of rocks previously

set for N.E. corner of Jas N
Spillman Survey = at 1900 Vrs.
from N.E. cor^s of said Sur = No 61
and at 1100 Vrs. from N.E.
corner of J. N. Spillman the
stake set for S.W. cor^s of A + W.
Sur = No 969. brs. S 74 1/2 E. 140 =
Vrs. and at 1900 Vrs. set a
stake & pile of rocks for S.E.
cor^s of said J. N. Spillman
I then ran N 85 3/4 W = 600 Vrs.
and S 16 1/2 W = 750 Vrs. to the
stake set for North corner of
Section No 30 = and from
the foregoing connections
The Locations made by virtue
of = J. C. R. Co. Certs were
made = 1st the Location in
name of Louis & Joe Mariani
2nd the location in name of
Mary F. White = and 3rd those
for Dan J. Price & R. N. Britz =
Given under my hand at
Office this November 2nd
1883.

W. H. Hayes
Co Sur = Frio Co

Sketch File 6.

Frio County

South East corner of
County

Filed Nov. 5/83

D. A. Robinson

Chf. Clk.

set for N.E. corner of Jas N
Spillman Survey = at 1900 Vrs.
from N.E. cor^s of said Sur = No 61
and at 1100 Vrs. from N.E.
corner of J. N. Spillman the
stake set for S.W. cor. of A & W.
Sur = No 969. brs. S $74\frac{1}{2}$ E. 140 =
Vrs. and at 1900 Vrs. set a
stake & pile of rocks for N.E.
cor^s of said J. N. Spillman
I then ran N $85\frac{3}{4}$ W. 600. Vrs.
and S $16\frac{1}{2}$ W. 750 Vrs. to the
stake set for North corner of
Section No 30 = and from
the foregoing connections
The Locations made by virtue
of = J. C. B. Co. Cert^s were
made = 1st the Location in
name of Louis & Joe Mariani
2nd the location in name of
Mary F. White = and 3rd those
for Daw J. Price & R. N. Britz =
Given under my hand at
Office this November 2nd
1883.

W. H. Hayes
Co Sur = Frio Co.

Sketch File 6.

Frio County

South East corner of
County

Filed Nov. 5/83

L. A. Robinson

Chf. Clk.

Spectator Eye Co.
 Fresno County
 Dept. Eng. corner of
 1st & 2nd Sts
 11/10/03
 J. H. Spillman
 J. H. Spillman

See sketch in S. 44231

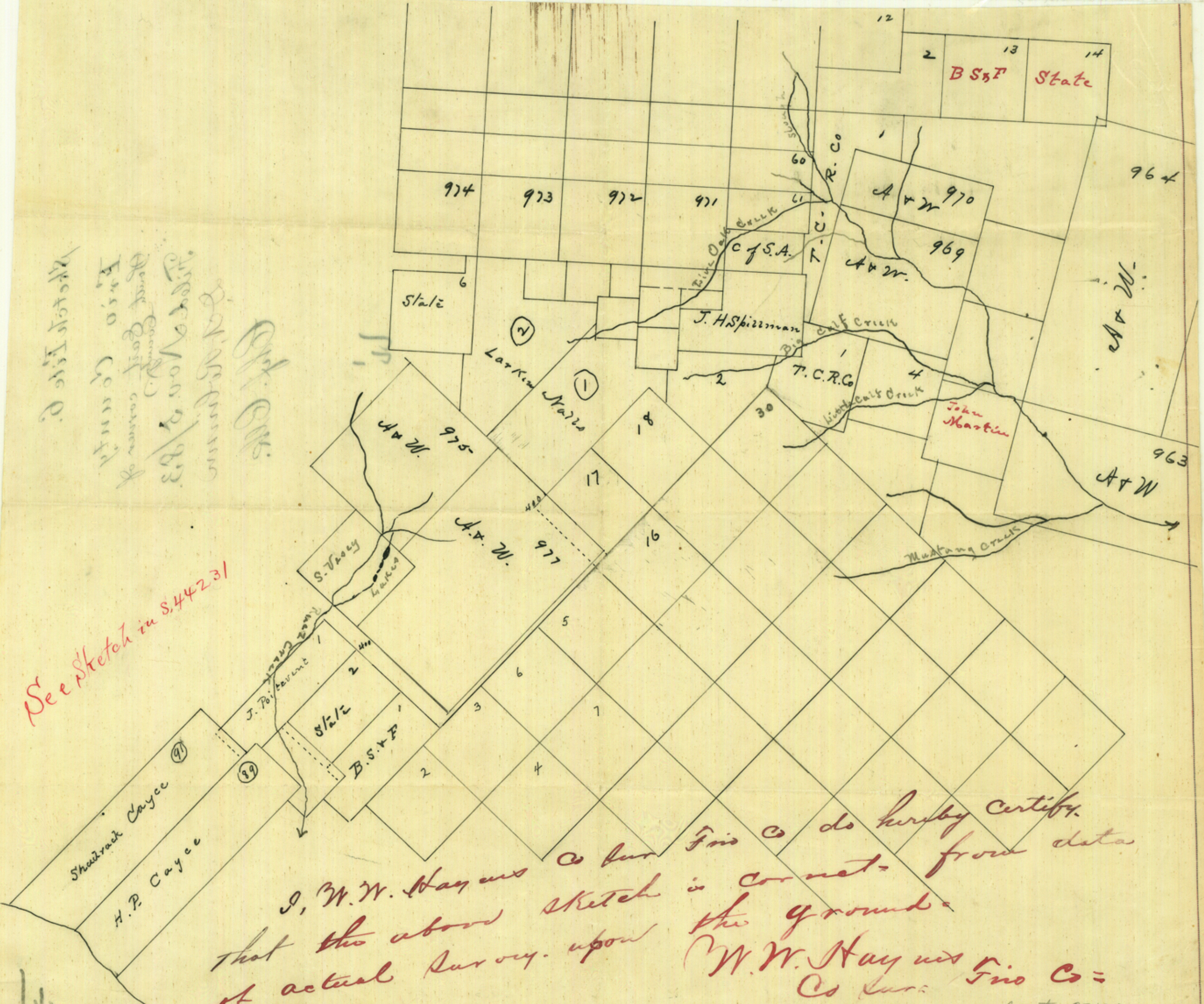

I, W.W. Haynes Co Sur Geo Co do hereby certify
 that the above sketch is correct from data
 of actual survey upon the ground.
 W.W. Haynes Co Sur Geo Co =