

Perfectly
referred to Bous
for attention
11-19-1912
D. C. Rosenberg

Pearson Tex
Nov 18, 1912

all
11-20-12
R-

Mr Ernst Von Rosenberg
Austin Tex

Dear Sir Friend:- A few days
ago I was running out some surveys on
the Leme Riv - this Co. I began at the lower
river cor of No 300, as shown by enclosed
sketch, and ran NW across Sur
no 300, and then ran into the river -
I found the distance to the river short
and found that the river bends as
shown on sketch. I crossed
the river twice and found the
trees called for by Sur No 300
except that from the LO mt \bar{x} the
other two trees stood as follows:-
LO 15 $\frac{1}{2}$ 35 $\frac{1}{2}$ E 13 $\frac{1}{2}$ N - LO 6 $\frac{1}{2}$ 7 E 5 $\frac{1}{2}$

Frio Co. Sk. File 11

page two 1-12

I notice from the field notes
that while these two surveys
are supposed to corner
together they call for different
trees - I wish to know
the true calls for the bearing
trees at this Cor as given by
the original notes, also I wish
to know if the sketch furnished
by the original work shows
the river to bend at this
point as indicated by my
sketch.

Please let me hear from
you at your earliest convenience.
Also please give me your opinion of
the trees I found at this point.
Truly your friend
A. C. Sweeney
Co Surveyor Frio Co

Counter 23125

Frio Co. 11.
Sketch file

Surveyor's letter to Evon R.

Dated 11-18-12.

Filed 11-19-12.

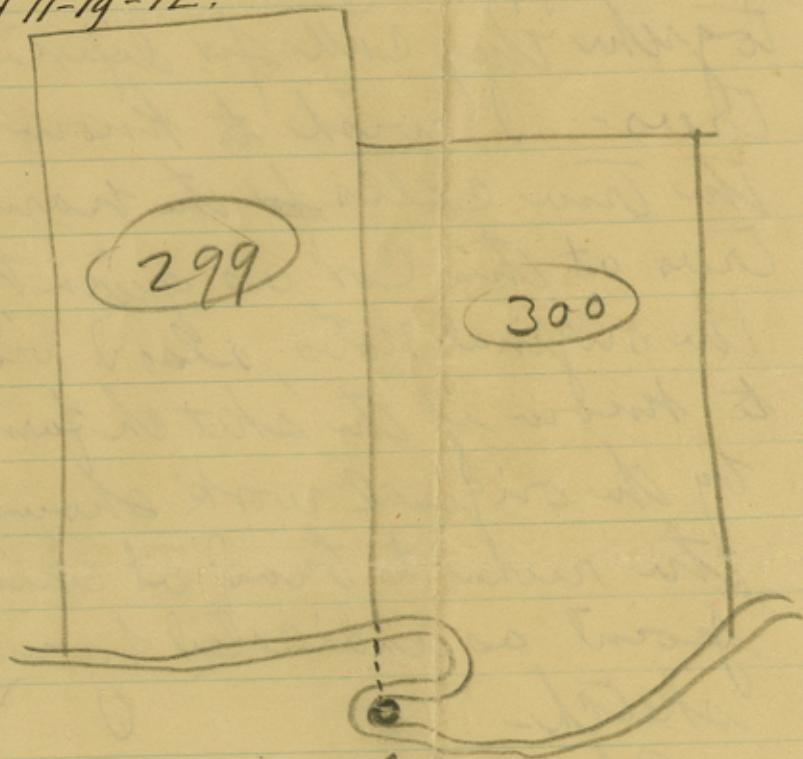

corner identified
on the ground corner tree
with both beams still
standing.

counter 23124

Frio Co. St. File #11