

Surveyors Office, Scurry County Texas.
 July 3rd 1900

Sketch showing the West boundary line of Bl. 5 G. H. & H. Ry Co Garza Co.
 as run by me on June 25th & 26th 1900
 F. M. German. Co. Sur. Scurry Co Texas.

G. H. & H. Ry. Co. Block No. 5.

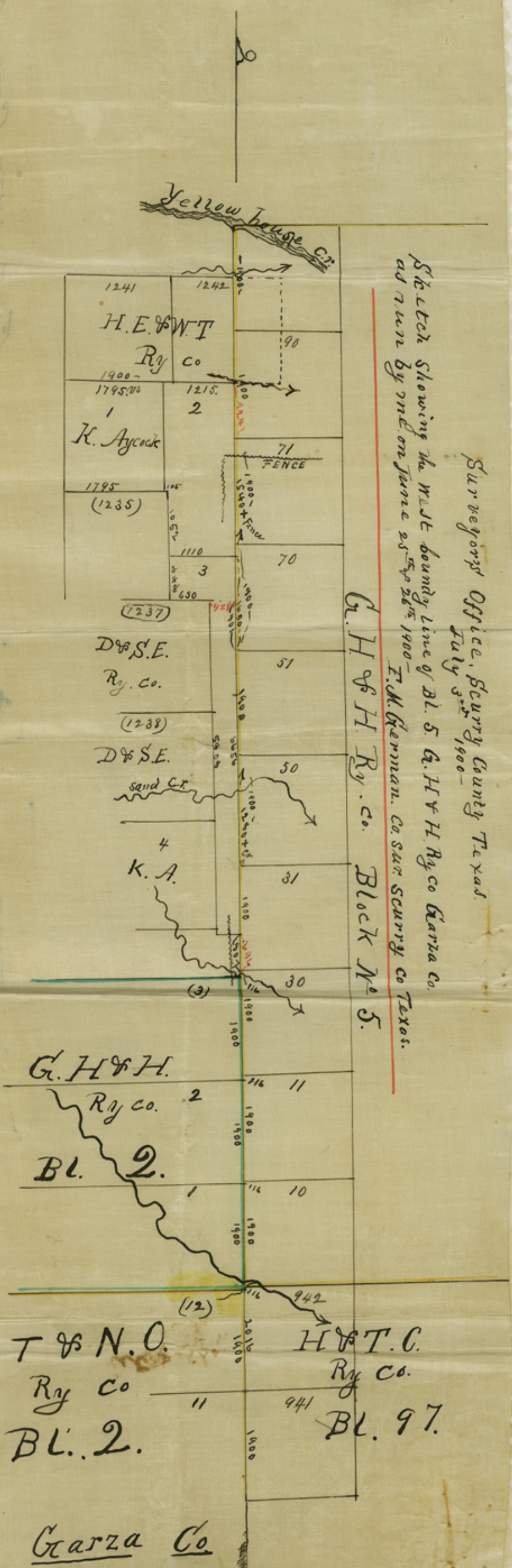

G. H. & H.
 Ry Co. 2
 Bl. 2.

T. & N. O.
 Ry Co
 Bl. 2.

Garza Co

H. & T. C.
 Ry Co.
 Bl. 97.

759

counter 24014

State of Texas
County of Scurry $\frac{2}{3}$ Field notes of a survey of the
East boundary line Block No 2. and West boundary
of Block No-5 Galveston, Houston and Henderson
Railroad Company. Situated in Garza County
Texas.

I began at the North West corner of Survey
No. 941. Block 97. A & T. Ry. Co. a rock
set in the ground marked N.W. 941-97-
from which a mes. 5" in dia bears $N 9\frac{1}{2}^{\circ} W -$
100 varas. (rock and mes still standing) This
corner was established by Geo. Spiller State
Survey A.D. 1887. I then ran North
(Vernier set at $9^{\circ} - 15' E$) at $1900\frac{9}{10}$ varas I
set a stone in ground marked N.E. - 12 from
which a stone set in the ground marked N.E. 12
bears $N 21^{\circ} E 64$ varas. and stone mound bears $N 34^{\circ} W$
 $214\frac{1}{2}$ varas. I then ran North at 116 varas.
a stake in small br for the N.W. corner of
Survey No. 942. Block 97. A & T. Ry. Co.
being also for the S.W. corner of Sur. No. 10
Block 5. A. & T. Ry. Co. Continued
North at 226 varas. x Cooper Creek. (C.S.E.)
at $5702\frac{4}{10}$ varas. a stone mound for
the N.E. corner of Block No. 2. G. A. & H.
Ry. Co. from which a mulberry in a
clump of mulberries standing on the south
bluff bank of a creek. bears $N 20\frac{1}{2}^{\circ} W 122$
varas. and a hackberry bears $N 19\frac{1}{2}^{\circ} W 121\frac{1}{2}$
varas.

Cont'd North at 116 varas a Stone mound
for the N.W. Corner of Survey No. 30. Block 5.
G. H. & H. R.R. Co. from which a Stone mound
bears N 49 $\frac{1}{2}$ ° W 117 varas.

Thence North at 691 varas. pass the S.E.
Corner of Survey No. 3. Block 5. K. Aycock.
from which a stone mound on a rocky hill bears
South 62 varas. from which a gate in fence
bears ~~N~~ 69° W 22 $\frac{1}{2}$ varas. a conical mound
in Valley bears N 39° E. Cont'd

North at 1900 $\frac{1}{2}$ varas. the N.W. corner
of Survey No. 31. Block No. 5. G. H. & H. a
Stone mound bears N 45° W 112 $\frac{1}{2}$ varas.

Thence North at 1780 varas x Sand Creek
(C.R.E) at 1840 vs top of a hill at 1900 $\frac{1}{2}$ varas.
N.W. Cor of Survey 50 Bl. 5 G. H. & H. R.R. Co.

Thence North at 1900 $\frac{1}{2}$ varas. the
N.W. Corner of Survey No. 51. said Blk. 5.
a Stone mound bears N 37 $\frac{1}{2}$ ° W 84 varas.

Thence North on West line of Sur
No. 70. at 560 varas. top of a red sand
hill at 801. Varas. I made connection with
the N.E. corner 1237. D & S.E. R.R. Co.,
Survey ^{which} bears West 428 varas. (The N.E. cor.
of 1237. D & S.E. Ry Co is a large stone mound
from which a large flat rock mtd x bears
N 17° E.) Cont'd North on the West line of 70.
at 1650 varas. pass the N.E. Corner of survey
No. 3. Blk 5. K. Aycock. a Stone mound

from which a clump of hickberys one mile
br $N 20^{\circ} E 114 \frac{1}{4}$ vs. a mes 4" in dia br $S 50^{\circ} E 40 \frac{1}{2}$
vs. Cont'd North at 1900 ft vs. the N.W. cor
of 70.

Thence North at 1540 x a fence at 1900 ft vs
the N.W. cor of 71.

Thence North at 924 vs. the N.E. cor
of sur no. 2, K Aylock. Near the South bank
of a deep draw at 950 vs x said draw at
1900 ft vs. the N.W. corner of sur no. 90. on
the East slope of a hill a stone md br.
 $N 4 \frac{1}{2} W - 86 \frac{1}{4}$ varas.

Thence North at 800 vs x a creek at
1900 ft vs. a ~~stone~~ vault box in channel of
yellow house creek. a mes br $S 1^{\circ} W 65$ vs another
 $S 1^{\circ} W 66 \frac{1}{4}$ varas., a large rock on a rocky point
North of creek br $N 11 \frac{1}{2} E$ a rock on point of md
on South bank br $N 65^{\circ} W$ about 700 vs.

Surveyed June 25th & 26th 1900. Tom. Brown }
Bearings Marked \bar{x} } Walter. Clark } Chairman

I, A. M. German Surveyor of Scurry
County Land District do hereby certify that
the foregoing survey was actually made on
the ground according to law and that the
corners and boundaries with marks natural
and artificial are truly described in the fore
going field notes and attached sketch and
recorded in Book 3, Page 22, 23, ^{and 24} Record for Garza
County A. M. German, Surveyor Scurry Co
Land Dist.

"C1" Garza Co.
Field Notes of the S.
East boundary line of Block
No. 2, and West boundary
of Block No 5.

G. H. & H. Ry. Co.

Garza County

Filed for record Aug 3rd
1900. and recorded Aug 4th
1900. on pages 22, 23 & 24.
Records for Garza County Book 3

J. M. German

Surveyor Scurry County
Land District

Garza Co Sketch
Files
Filed in Geul
Land Office 8/20/1900
Wise

County 24018

11