

16 File #
31
Grayson County

S.W. of Sherman

Filed January 13/63.

Nameless SK. of Suis
SW. of Sherman.

Filed Jan 13, 1863.

Sherman

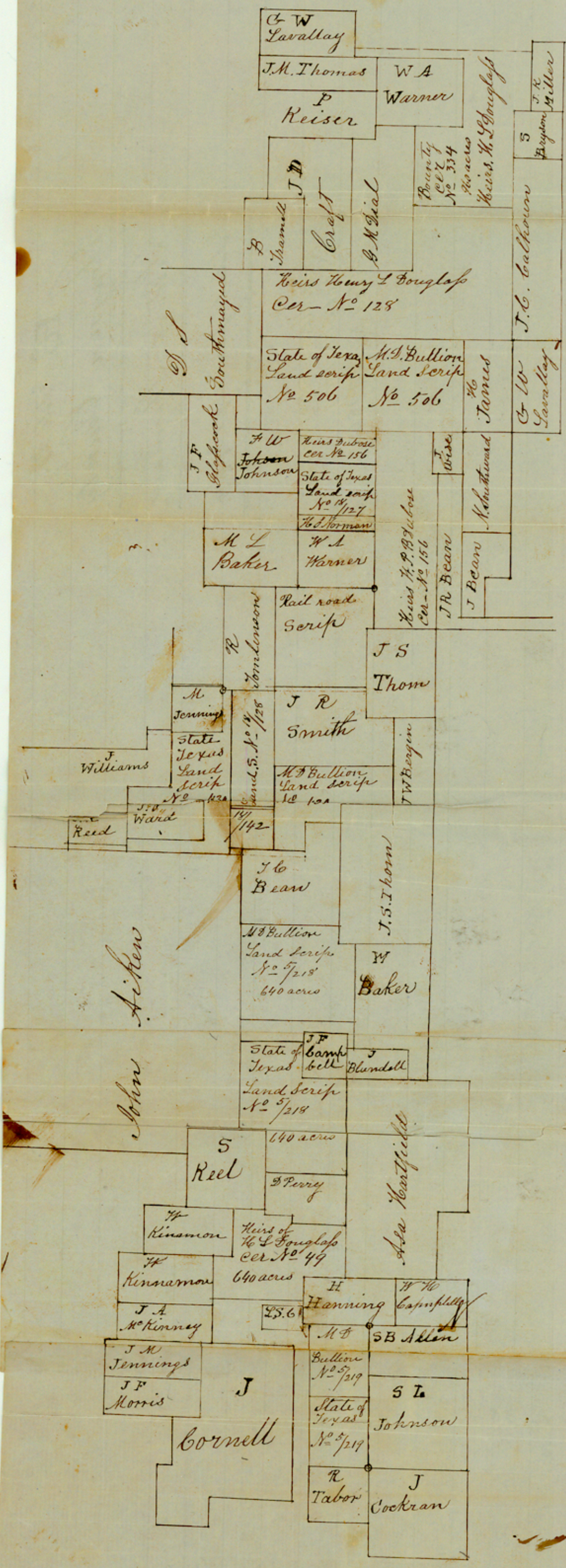

John Aiken

Asa Hartfield

The State of Texas
County of Grayson

I James T Lackey
Deputy Surveyor of Grayson County
do hereby certify, that there is a very
old line represented by legal documents
in the General Land Office, as being
run about the year 1835: by George
Aldrich and Benjamin Tennell
and represented by them as being
a Base line run west magnetically
from Tallets on Bee Bayou to the
Cross Timbers and that I have
myself run said line from the
beginning corner of the upper survey
of a league of land in the name
of Symatio Galindo on Red River
in Cooke County to the Chock-
=tan Bayou in the East portion
of Grayson County and that said
line crosses Old Dugans West line
N 13 E 1164, vs. from said Dugans SW
corner and South 13 West 736 vs
from Jose Alameda's N E corner
and strikes Chocktan Bayou 1691
vs East of the crossing point of
said Dugans West line.

Given under my hand in office

at Sherman This September 17th
1873.

James P. Lackey
Deft. Surveyor
Grayson Co. Tex

File # 21-
Grayson Co.

Surveyors
Certificate

CCD

M M
Manuel Manchaca

IS

1130

Stuart

D L Lorthmann
D S Lorthmann

A
Wet

2919

2303

1344

Rtaining 3/4

Dorville Patsy

Samuel
Skaypta

B B B W

1379

3d houses R 76

Kitchens

J. F.
Morice

JM
Lorthmann
950

F J
B B

R
+ P W Me
ridette

1256

B
Draud

B
C
C
C

Frosty

Alis

875

21-
File 32.42

Grayson Co
Sketch

Filed July 24/73

This sketch is erroneous.
The combined E. lines of
Marre, Miller & Stiles
should be the same
as the combined W. lines
of Trammell & Thomas
but the figures with
in shows a discrepancy
of 164 vs. 1 and how the
balance may be where
no figures are inscribed
it is hard to tell.

July 30¹⁸⁷³ - 1 V
Thielepape

Spencer Miller
July 24/73
filed July 24. 1873
W. E. Kelmer
Chf Clerk