

On the North County line of Wood Co
North of Lake Fork of Sabine

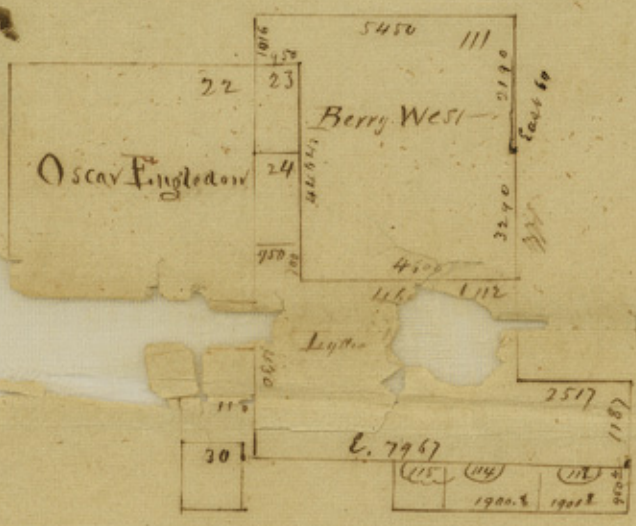

About 15 miles N by E from Jordan's Saline



Bush County, west of Williams bayou

[Faint, mostly illegible handwritten text, possibly a list or ledger entries.]

This sketch is correctly taken from the map of
District

Nacogdoches
Sep 28/48

A. W. Nelson
P. L. D. K.

114-2
 Nacogdoches District
 Sketch - N. & Sabine fork. Wood Co.
 and South of Sabine River. Brush Co.
 received Oct. 9/48.

Plotted on map

Wood & Brush Co.

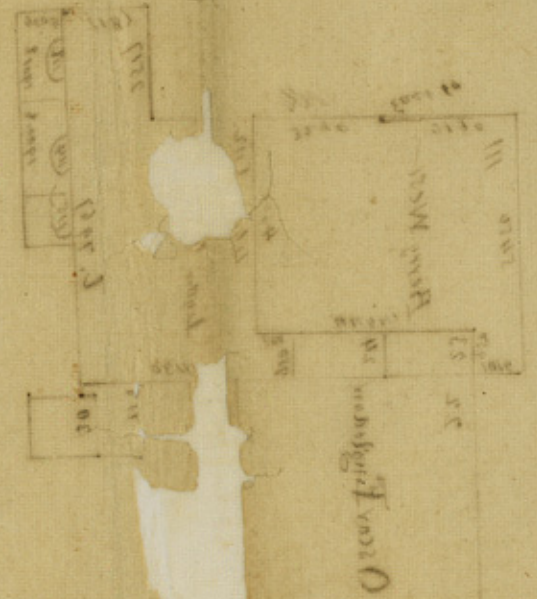

9/28/48

9/28/48

[Faint handwritten notes, possibly describing land parcels or survey details.]

24544